

ITEM NO.	PART NUMBER	DESCRIPTION	QTY.
1	AB19107R	FIRST ARM R.H. 33/36M	1
	AB19107L	FIRST ARM L.H. 33/36M	1
2	AB19100-A-2	FIXED WINGTIP ADJUSTMENT	1
3	AB19100-A-3	HYDRAULIC WINGTIP ADJUSTMENT	1
4	AB19113CR	FOLD PIVOT OUTER R.H.	1
	AB19113CL	FOLD PIVOT OUTER L.H.	1
5	AB19132	SPRING BOOM SUPPORT 36M	1
6	AB19135	PIN 36M 1ST ARM TO 2ND	1
7	AB19150-13A	PIN 130 X 30 C/W WASHERS & SCREWS	1
8	AB19150-65A	PIN 65 X 25.4 C/W WASHERS & SCREWS	3
9	AB19157A	BRACKET OUTER BOOM	1
10	AB19157Apad	PAD OUTER BOOM SUPPORT	1
11	AB19159	SPRING LOCK ARM	1
12	AB19160R	ARM HINGE LOCK R.H.	1
	AB19160L	ARM HINGE LOCK L.H.	1
13	AB19161R	PLATE HINGE LOCK RH	1
	AB19161L	PLATE HINGE LOCK L.H.	1
14	AB19163	ROD G-FIX	1
15	AB19164	SPRING RETAINER PLATE	1
16	AB19165	PIVOT BLOCK	1
17	AB19178	ARM FOLD PIVOT OUTER	1
18	AB19179	LINK PLATE OUTER FOLD RAM	1
19	AB19180	PIN PIVOT BLOCK G-VAR	2
20	AB19181	PIN OUTER FOLD SCISSOR JOINT	3
21	AB19197	CYLINDER OUTER FOLD 3.5 X 12	1
22	AB19197-SK	SEAL KIT HP-016 CYLINDER	1
23	AB20800	CYLINDER FOLD LOCK 35 X 38.1	1
24	AB20800-1	LOCK NUT 1 1/4" BSP	1
25	1.25UNFNUT	1 1/4" UNF NYLOC NUT	1
26	M20X100BOLT	M20 X 100 HEX HEAD BOLT HT ZP	1
27	M20NNUT	M20 NYLOC NUT HT ZP	3
28	M20HNUT	M20 HALF NUT ZP	1
29	M20FWASHER	M20 FLAT WASHER ZP	3
30	M12HNUT	M12 HEX NUT HT ZP	2
31	M12X70	M12 X 70 SET SCREW HT ZP	1
32	M12X60BOLT	M12 X 60 BOLT HT ZP	1
33	M12X40	M12 X 40 HEX HEAD SET SCREW HT ZP	3
34	M12X25	M12 X 25 SET SCREW HT ZP	1
35	M12NNUT	M12 NYLOC NUT HT ZP	3
36	M12FWASHER	M12 FLAT WASHER ZP	12
37	M12SWASHER	M12 SPRING WASHER ZP	1
38	M10X30	M10 X 30 SET SCREW HT ZP	4
39	M10X20	M10 X 20 SET SCREW HT ZP	2
40	M10NNUT	M10 NYLOC NUT HT ZP	6
41	M10FWASHER	M10 FLAT WASHER ZP	8
42	X6GNIPPLE	M6 GREASE NIPPLE	11
43	XBMBB50	U-BOLT 50MM X 10	1

THIS DRAWING IS FOR ILLUSTRATION PURPOSE ONLY
PLEASE REFER TO THE PARTS LIST.

UNLESS OTHERWISE SPECIFIED: DIMENSIONS ARE IN MILLIMETERS SURFACE FINISH: TOLERANCES: LINEAR: ANGULAR:		FINISH: N/A	DEBUR AND BREAK SHARP EDGES	DO NOT SCALE DRAWING	ISSUE	C
DRAWN RPJUCO			SIGNATURE	DATE 01/209	REVISION 100511	TITLE: 36M AGRIBOOM INNER BOOM WING ILLUSTRATION
CHKD						DWG NO. AB19100-BR-36
APPVD						A2
MFG						
Q.A						
MATERIAL: N/A			WEIGHT:		SCALE: 1:16.5	SHEET 1 OF 1
<small>COPYRIGHT PROPRIETOR: THE DRAWING IS THE PROPERTY OF CROPLANDS PTY. LTD. REPRODUCTION OF THIS DRAWING FOR PARTS OR COMMUNICATION OF ITS CONTENTS IS PROHIBITED WITHOUT THE CONSENT OF CROPLANDS PTY. LTD.</small>						

ITEM NO.	PART NUMBER	DESCRIPTION	QTY.
1	AB19109AL	BOOM ARM OUTER LH 36M	1
	AB19109AR	BOOM ARM OUTER RH 36M	1
	AB19110L	BOOM ARM OUTER LH 33M	1
	AB19110R	BOOM ARM OUTER LH 33M	1
2	AB19111A	BREAK-AWAY HITCH	1
3	AB19106AL	BREAK-AWAY TIP	1
4	AB19126-5	PULLEY	1
5	AB19152-330A	PIN OUTER BOOM SUPPORT	1
6	AB21200A	TOP LINK ADJUSTMENT	1
	AB21200A-1	BUSH	2
7	AB19126-4	MALE ROD END	1
8	AB19126-6	CABLE, PULLEY	1
9	AB19126-7	SPACER BUSH	2
10	MP-413	ADJUSTABLE SPRING HITCH	1
11	MP-519	SPRING	1
12	MP-598A	PROTECTION BRACKET FENCELINE V2	1
13	0.75X100UNCBOLT	3/4" X 4" UNC BOLT HT ZP	2
14	0.75UNCNNUT	3/4" UNC NYLOC NUT HT ZP	2
15	0.75UNFHNNUT	3/4" UNF HEX HALF NUT	1
16	0.75FWASHER	3/4" FLAT WASHER ZP	4
17	M20X100BOLT	M20 X 100 HEX HEAD BOLT HT ZP	1
18	M20NNUT	M20 NYLOC NUT HT ZP	1
19	M20FWASHER	M20 FLAT WASHER ZP	2
20	M16NNUT	M16 NYLOC NUT HT ZP	2
21	M16HNUT	M16 HEX NUT HT ZP	4
22	M16FWASHER	M16 FLAT WASHER ZP	2
23	M12X90	M12 X 90 BOLT HT ZP	1
24	M12X50	M12 X 50 SET SCREW HT ZP	1
25	M12X40	M12 X 40 HEX HEAD SET SCREW HT ZP	1
26	M12NNUT	M12 NYLOC NUT HT ZP	3
27	M12FWASHER	M12 FLAT WASHER ZP	7
28	M10X30	M10 X 30 SET SCREW HT ZP	4
29	M10NNUT	M10 NYLOC NUT HT ZP	4
30	M10FWASHER	M10 FLAT WASHER ZP	8
31	M6GNIPPLE	M6 GREASE NIPPLE	1

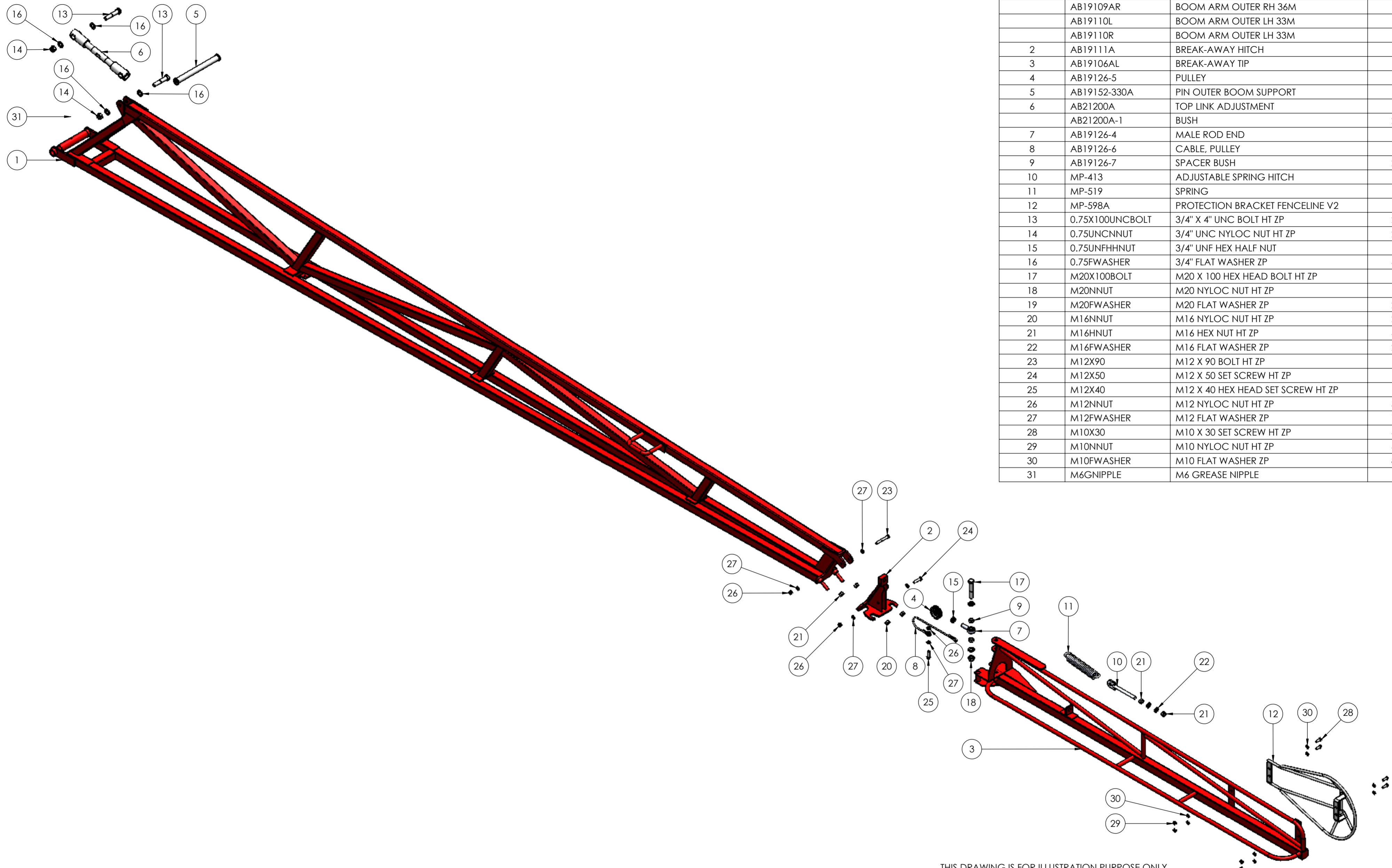

THIS DRAWING IS FOR ILLUSTRATION PURPOSE ONLY
PLEASE REFER TO THE PARTS LIST.

UNLESS OTHERWISE SPECIFIED: DIMENSIONS ARE IN MILLIMETERS		FINISH: N/A		DEBUR AND BREAK SHARP EDGES		DO NOT SCALE DRAWING		ISSUE		B	
SURFACE FINISH:											
TOLERANCES:											
LINEAR:											
ANGULAR:											
DRAWN		NAME		SIGNATURE		DATE		REVISION		TITLE:	
CHKD		RPJUCO				250110				36M AGRIBOOM	
APPVD										OUTER BOOM WING ILLUSTRATION	
MFG										DWG NO.	
Q.A										Outer Wing	
MATERIAL:										A2	
WEIGHT:										SCALE: 1:15	
SHEET 1 OF 1											