

B180.1910.6HS

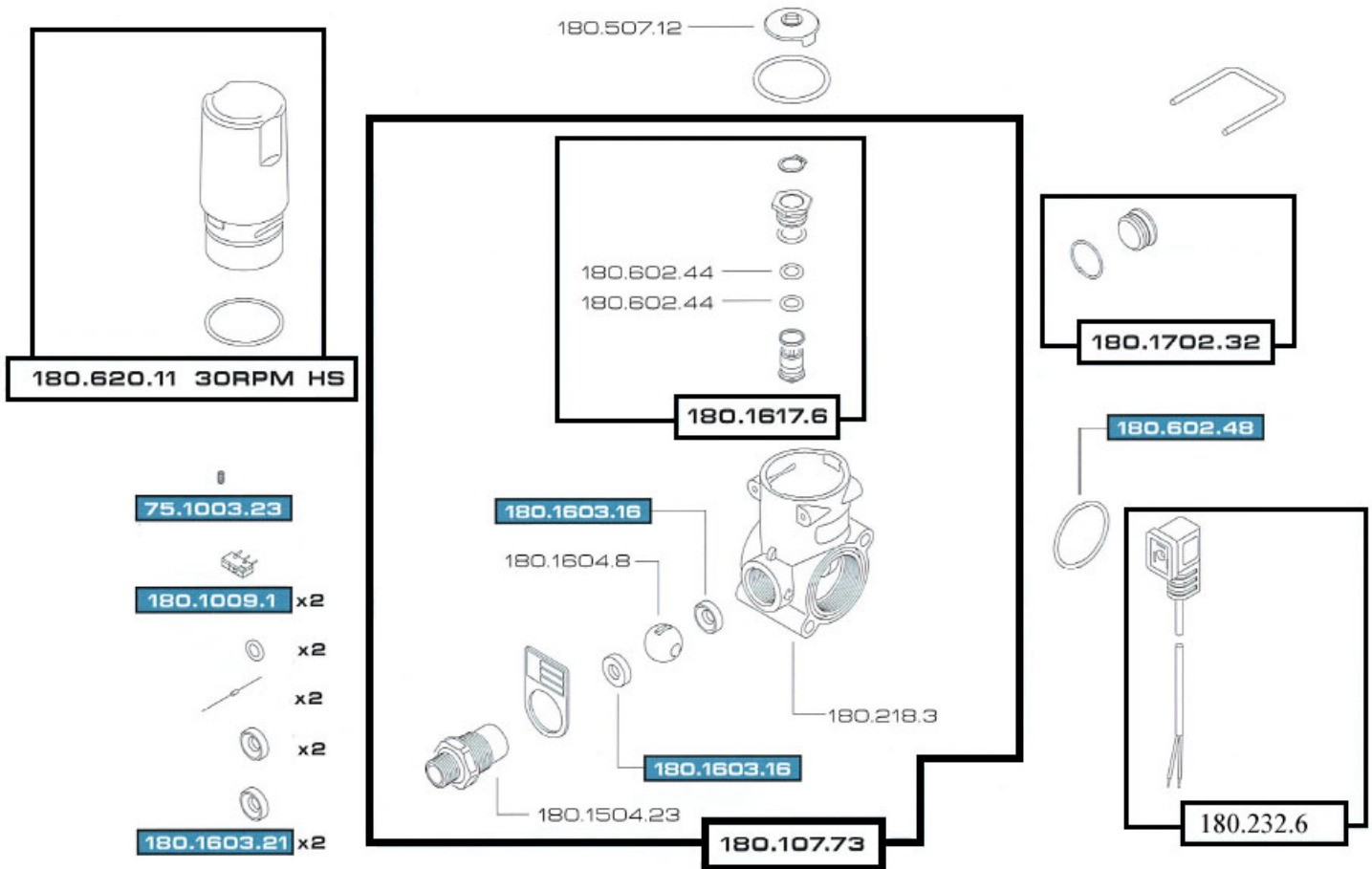

Max. Pressure	L / Min – 1 bar	12Vdc	Inlets	Outlets	On/Off Speed	Temperature
40 bar 580 psi	60 lpm	0.3 – 0.7 A	1/2" M	2 x 1 1/4" F	0.3 s	-10 °C +50 °C



180.1910.6 HS

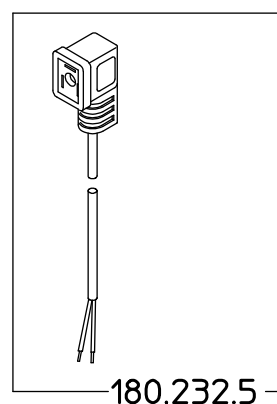
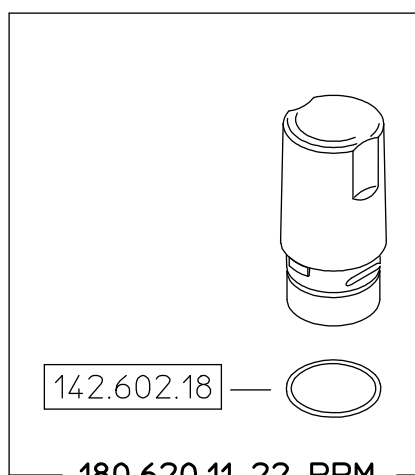

Solo per kit
Only for kit

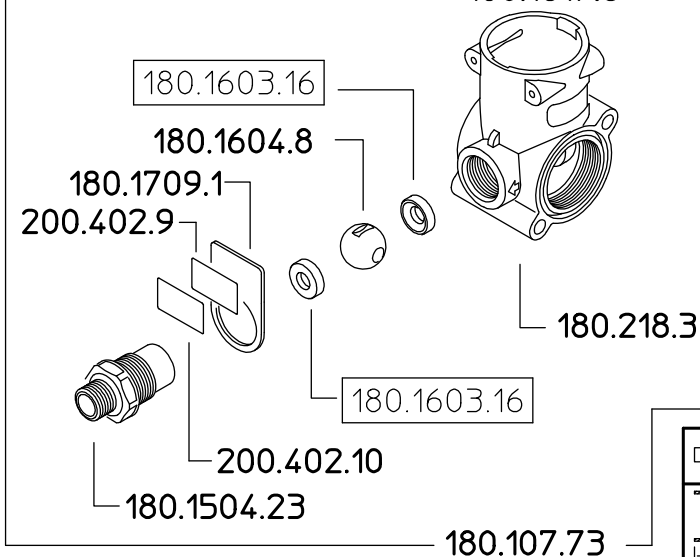
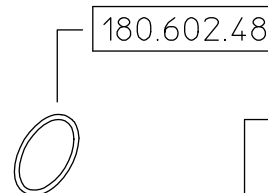
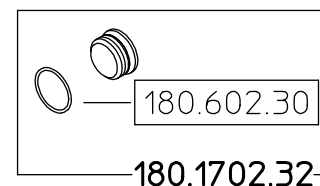
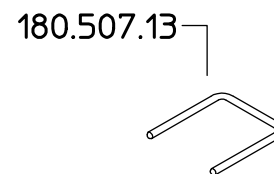
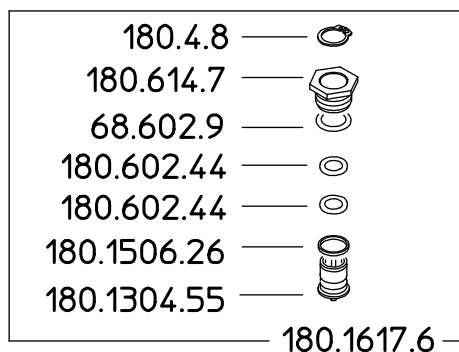
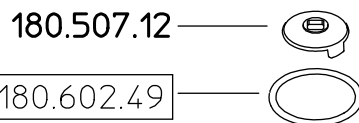
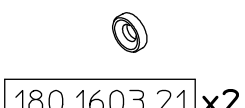
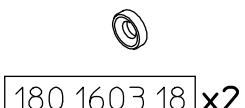
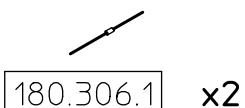
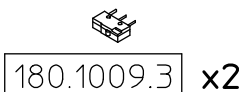
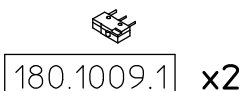
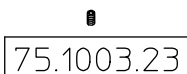
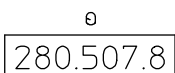

Come si ordina/How to order
Kit ricambio-Cod. **180.302.31**
Spare parts kit-C/N.

DENOMINAZIONE: Valvola sfera 12Vcc due vie G1/2 HS		N°revisione 03	Data revisione: 11/09/09
Braglia SRL I-42029 Masone (REGGIO EMILIA)-ITALY-UE Email braglia@braglia.it		STE	RTE
		180.1910.6 HS	