

CROPLANDS PART NUMBER: B202.1510.9

M202 PRESSURE REGULATOR

WHERE USED: I-S4021

REGOLATORE M202 M202 PRESSURE REGULATOR

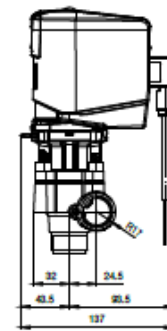
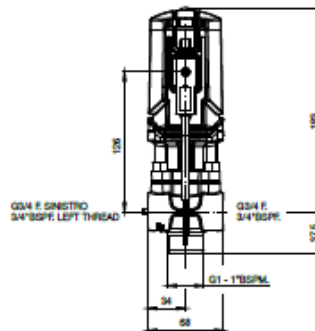
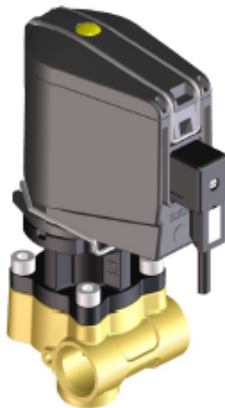

Standard con connettore DIN43650-A IP67 con cavo costampato 1.5 m
 Pressione di esercizio max.: 40 bar
 Tempo da $P_0 - P_{max}$: 16 s
 Portata max.: 150 l/min con pressione residua di 4 bar
 Pressione residua a 100 l/min: 2 bar
 Peso: 1.9 Kg

Materiali: ottone - acciaio inox - alluminio con rivestimento in cataforesi - materiali plastici ad alta resistenza - sede e pistone valvola in acciaio inox temprato in vuoto - tenute in FPM
 Impiego: su atomizzatori e gruppiirroranti
 Valvola di regolazione motorizzata 12Vdc a pressione costante. Modulare con le valvole serie M200. Membrana di separazione e tenuta o ring interposte tra fluido e componenti interni. Fine corsa elettronici. Eccellente per la regolazione manuale e assistita da computer. Elevata sensibilità, precisione e ripetibilità. Modificando il numero delle mandate in lavoro, la pressione subisce una variazione entro il 10% del valore impostato.

Standard with DIN43650-A IP67 connector 1.5 m integrated moulded cable
 Max. operating pressure: 40 bar - 580 psi
 Timing $P_0 - P_{max}$: 16 s
 Max. output: 150 l/min (39.6 USGal/min) with 4 bar (58 psi) pump circuit residual pressure
 100 l/min (26.4 USGal/min) pump circuit residual pressure: 2 bar (29psi)
 Weight: 1.9 Kg (4.2 lb)

Materials: brass - stainless steel - aluminium with cathoporesis coating - high resistance plastic materials - vacuum hardened stainless steel piston and seat - FKM seals
 Use: on airblast sprayers
 Constant pressure 12Vdc motor driven pressure regulating valve. Modular with M200 valve series. Diaphragm and o ring separates fluid from moving parts. Electronic limit switches. Excellent for both manual and computer driven pressure regulation. Elevated sensitivity, precision and repeatability. When section valves are switched off, holds constant working pressure between 10% variation.

CARATTERISTICHE TECNICHE / TECHNICAL FEATURES				
bar psi	l/min-4bar USGal/min - 58psi	12Vdc	On/Off	
40 580	150 39.6	0.8 - 2 A	16 s	-10 - +80°C

COME SI ORDINA / HOW TO ORDER	
CODICE code	KIT RICAMBIO spare parts kit
202.1510.9	20230276

Service and Parts advice

NOTE

SOME PARTS ARE NON-STOCK
ITEMS AND MAY NEED TO BE
ORDERED

202.1510.9

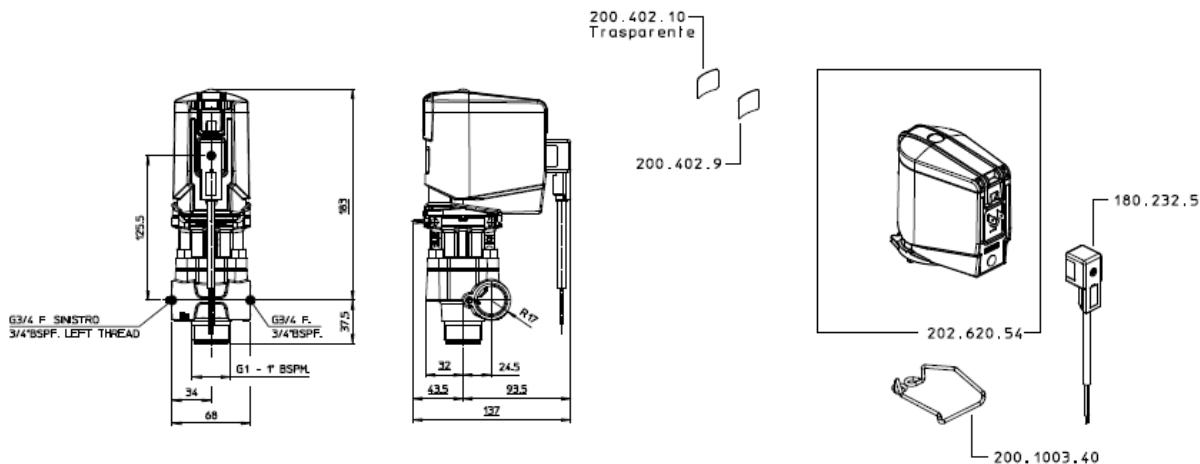

ATTENZIONE IMPORTANTE
ASSEMBLARE 202.7.10 CON MARCHIO
IN QUESTA POSIZIONE RISPETTO ALLE
FILETTATURE G3/4F. DEL 401.218.16

Riempire il foro Ø3/Ø4 dall'Interno
con grasso MOLY LT2

Verso di montaggio 202.211.1
con foro Ø11 rivolto verso 202.7.10

7.602.12
Assemblare
su 401.1609.7

VERSO MONTAGGIO
401.1006.7

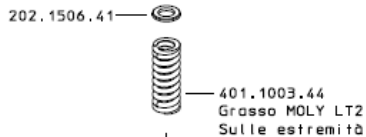
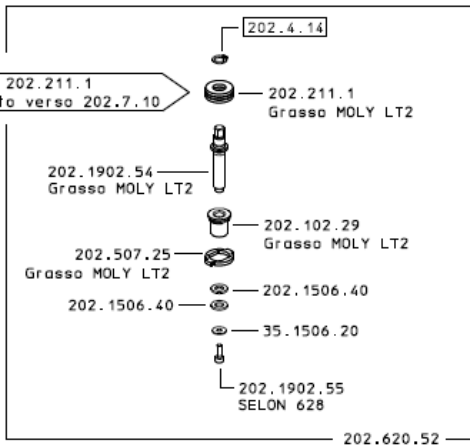
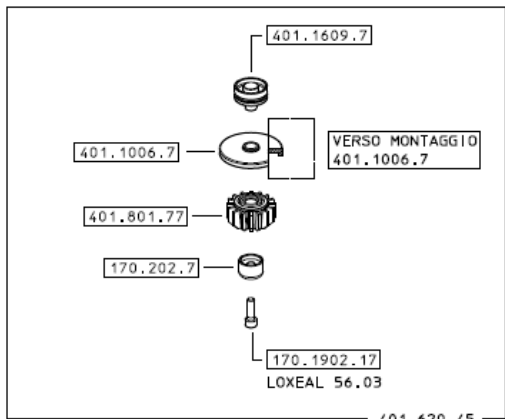

170.1603.29

166.1902.46



401.218.16

202.1617.81

NOTE

PLEASE ADD PREFIX **B** TO
PART NUMBER TO REFLECT
CROPLANDS PART NUMBER

COME SI ORDINA / HOW TO ORDER
Kit ricambio
Spare parts kit **202.302.76**

DESCRIZIONE: REGOLATORE M202 40BAR	Tel. +39 0522 34344	DISEGNATO	APPROVATO	Rif. revisione
Braglia s.p.a.	0522 34020	ABRAGLIA	ABRAGLIA	05
INDirizzo: 20090 CREMA - ITALY - Via Eraldo Baccinotti				Data revisione 30/08/2019
				202.1510.9

202.620.54

Alimentando + con 12Vdc il perno
202.1304.83 ruota in senso orario

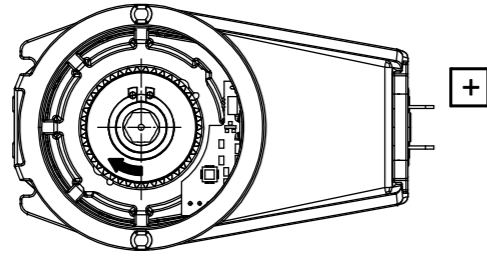

Vista inferiore lato
Perno 202.1304.83

Con albero motore premuto
verso il lato con i Faston

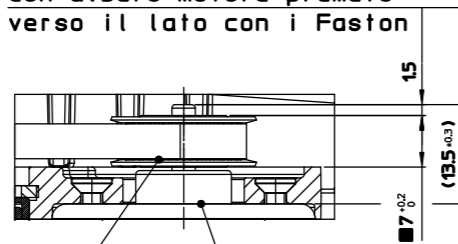

200.1311.2

180.1011.3

Dettaglio Scala 2:1

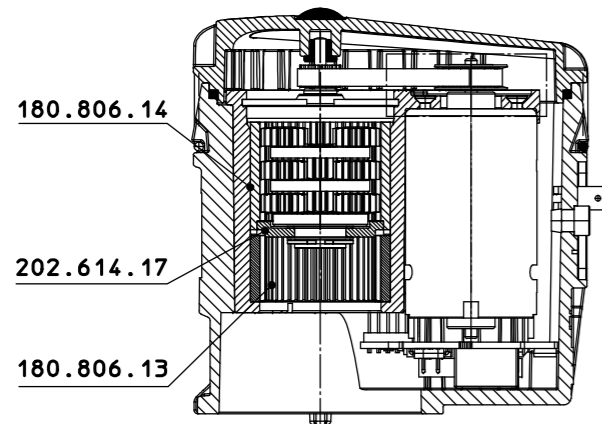

Sez. A-A

Saldare CAVO ROSSO
su questo Faston

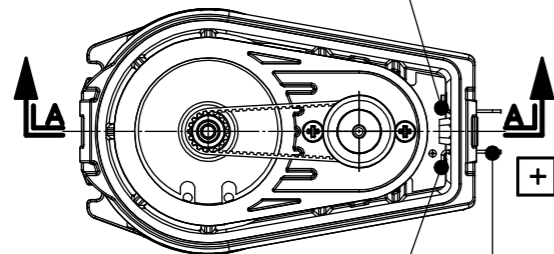

Saldare CAVO NERO
su questo Faston

N°2 180.232.7

Vista superiore senza 200.215.13

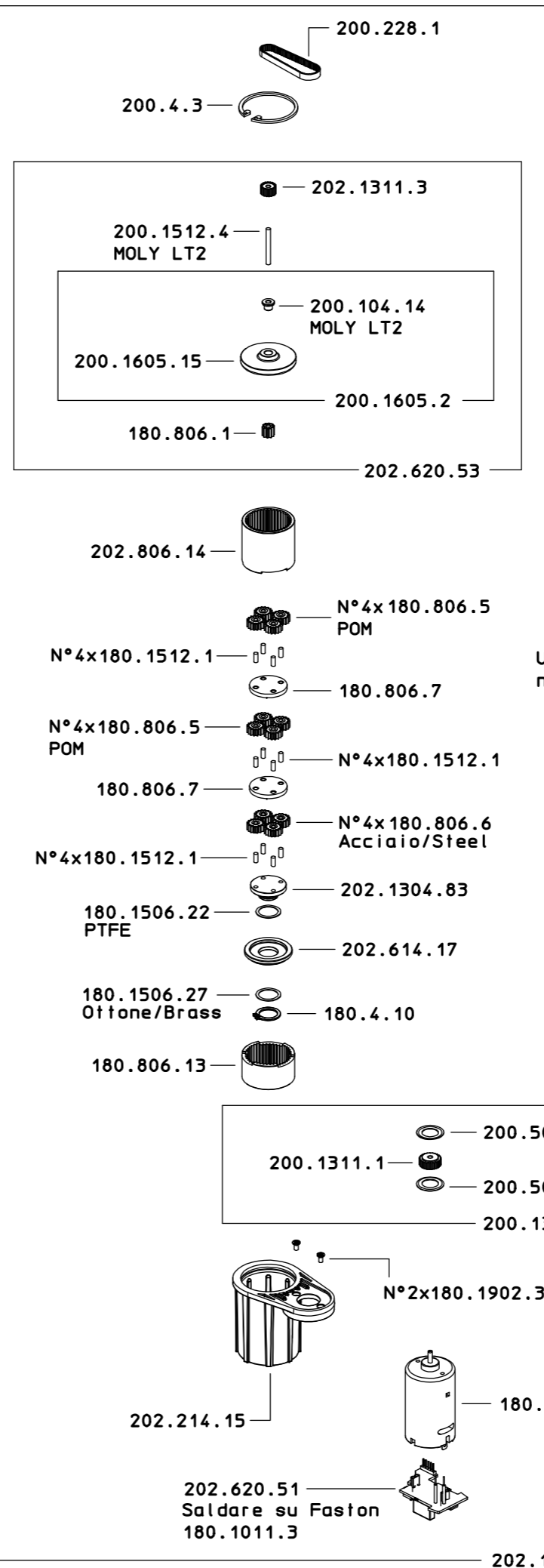

Motore assemblato su Cuffia 202.214.15
con tasca quadrata in questa posizione
rispetto al circuito stampato

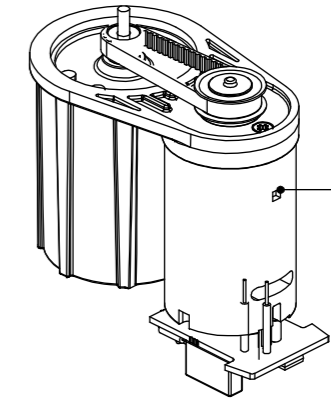

Utilizzare grasso LBT2
nei piani di riduzione

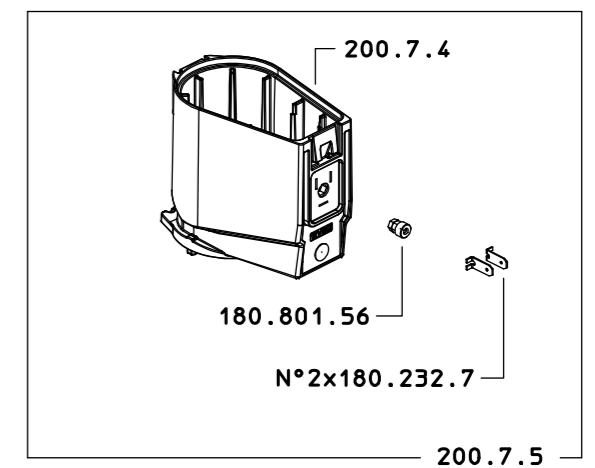
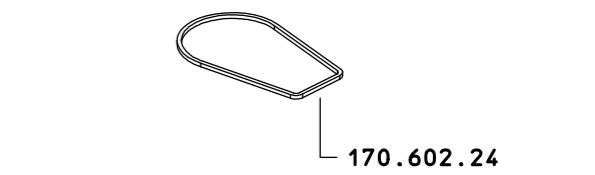
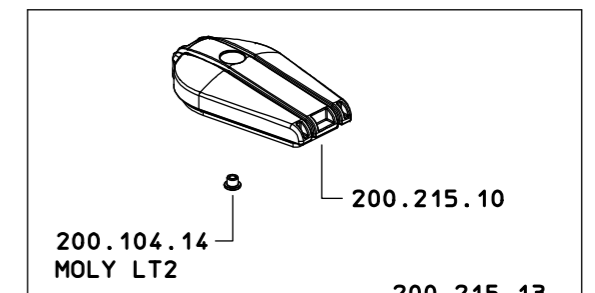
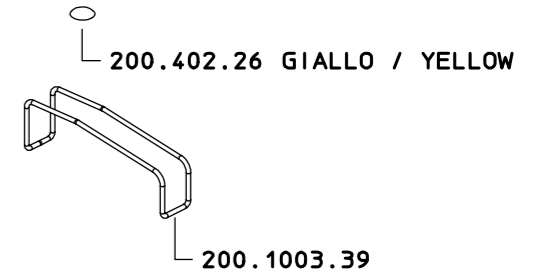

Controllo di processo in produzione 100%
Ciclo di 5 secondi in entrambe le direzioni
Assorbimento a vuoto < = 1A