

CROPLANDS PART NUMBERS: FI52DCRO00001 – FAN 920 LINEAR TOWER SS

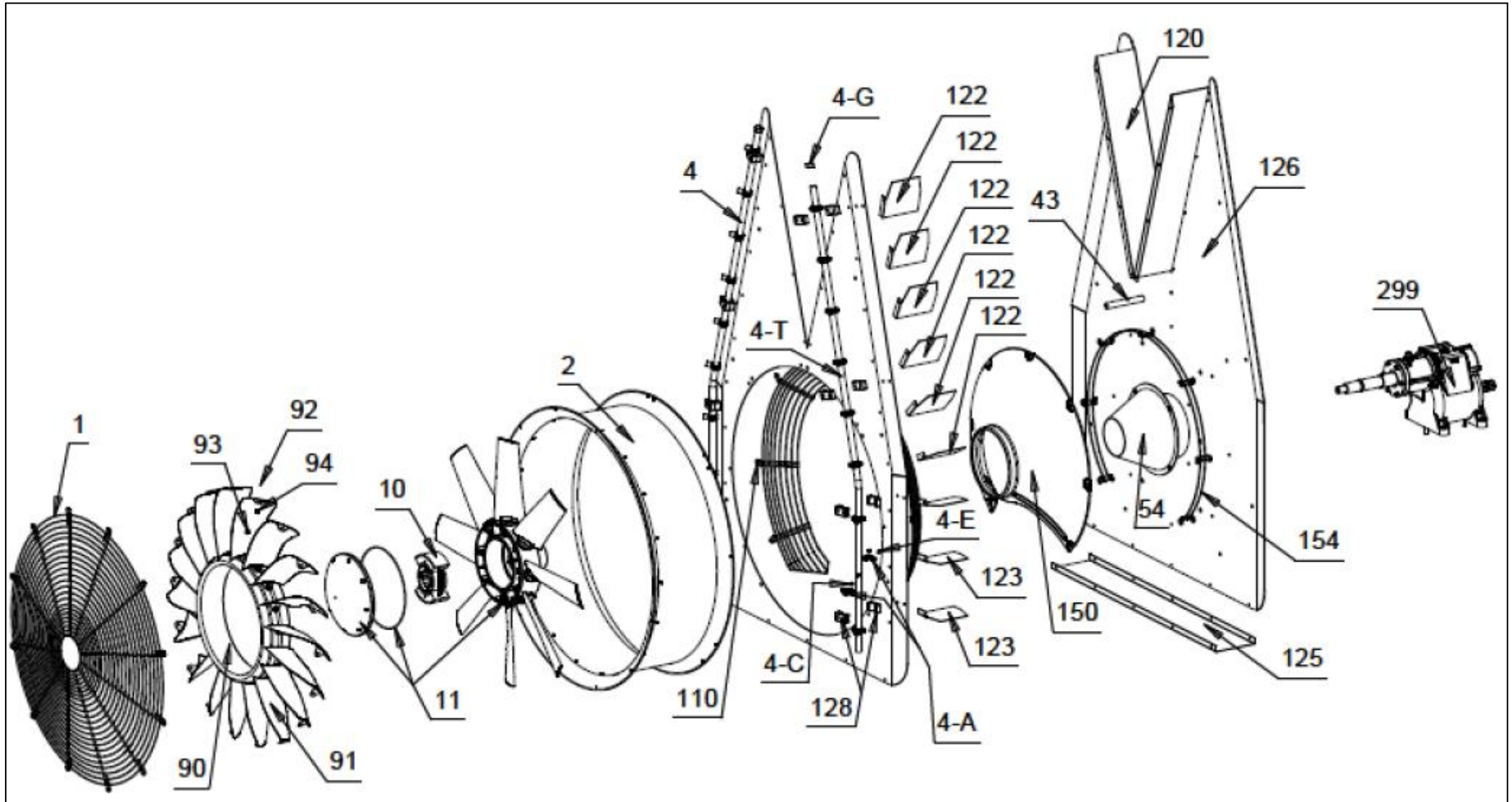

ITEM	PART NUMBER	DESCRIPTION	QTY.
1	FIRET00000011	FAN GUARD D.920 WIDER RING HOT GALV	1
2	FICNI00000029	SS 920 FAN HOUSING 324mm WIDE	1
110	FIRET00000343	BLACK PAINTED SAFETY GUARD RT/18	1
154	FIRET00000341	RT/16 PAINTED SAFETY GUARD	1
127	FIPIA00000764	SS BACKPLATE PT/46/01	1
126	FIPIA00000765	SS BACKPLATE PT/45	1
		COMMON PARTS	
54	FICON00000003	SMALL PLASTIC CONE	1
150	FICON00000007	CUTTED PST CONE H.175	1
123	FIBAN00000042	SS DEFLECTOR -SHORT -BN/45	6
122	FIBAN00000043	SS DEFLECTOR -MIDDLE-BN/44	12
125	FIBAN00000040	SS DEFLECTOR BOTTOM BN/47	1
120	FIBAN00000039	SS DEFLECTOR UPPER BN/48	2
128	FIBULLONI0065	KIT BLU CLAMP WITH BOLTS	8
	FICOL00000001	CLAMPS D.22 FOR PIPES	8
	FITCC00000009	TCCE 6X40 GALVANISED	16
	FIRON00000104	WASHER 6X18 GALVANISED	16
	FIAUT00000004	LOCKNUT 10MA GALVANISED	16
	FIBULLONI0027	KIT BOLTS H.180 - BETWEEN BACKPLATES	1
43	FIDIS00000046	GALVANISED SS21 H.150 SPACER	11
43B	FITER00000006	TE R80 10X180	11
43C	FIAUT00000001	LOCKNUT 10MA	11
	FIRON00000114	10X21 WASHER	11
	FIRAD00000017	RAD2000 S.V. COMPLETE -920-	1
90	FIANE00000036	RED RING RD/90	18
91	FIPAL00000060	SS BLADE RD/60/01	18
92	FIAUT00000005	LOCKNUT 8MA GALV	18
93	FIDAD00000020	SHAPED BRASS NUT 8	18
94	FITEI00000030	TE SS 8X20	18
	FITUB000029DX	SS COMPL. MANIFOLD 9 CLAMPS RIGHT	1
	FITUB000029SX	SS COMPL. MANIFOLD 9 CLAMPS LEFT	1
4G	FITAP00000001	½ F. GAS CAP	1
4T	FITUB136DX920	SS PIPE 9 HOLES RIGHT L. 1705	1
4T	FITUB136SX920	SS PIPE 9 HOLES LEFT L.1705	1
	FIMOR00000003	COMPLETE CLAMP	7
4A	FIMOR00000001	¼ F. GAS CLAMP	9
4C	FIOR00000014	3030 VITON "O" RING	9
4E	FITCC00000004	6X14 BOLT	18
11	FIVEN00000026	ALUMINIUM FAN 920 PR BLADES	1
10	FIFRI00000004	820/920 CM9PG/VG CLUTCH	1
299	MOLV2G2P003	GEARBOX V2G "A" DOUBLE SEAL with lever	1
	FIMOLZZ000003	GEARBOX V2G "A" DOUBLE SEAL	1
	FIKIT00000112*	KIT- CM9/V2G COMPLETE LEVER	1

NOTE

**SOME PARTS ARE NON-STOCK
ITEMS AND MAY NEED TO BE
ORDERED**