

**CROPLANDS PART NUMBERS: I-S4021 – SOLENOID VALVE ASSY 2 SECTION PRESSURE REGULATOR**

**WHERE USED: CROPLINER**



## CROPLANDS PART NUMBERS: B200.302.48 – Braglia Controller 2 Section + On/Off + Pressure Adjust

*Where used: I-S4021*



200.302.48

### **200.302.48 - 2 boom sections + main on/off + pressure adjusting**

- 200.302.48:** - *high resistance plastic materials box supplied with adjustable support*
- *heavy duty sealed industrial switches with metal handle wired without electronic circuit*
  - *boom section valve LED and master 12Vdc LED*
  - *master 12Vdc box switch operates also all working boom section valves (ON position). Central position: switch off 12Vdc from box.*
  - *switch to operate M180 and M200 series pressure regulators*
  - *two fuses*
  - *2 m length 12Vdc complete cable*
  - *5 m cable complete to suit valves supplied with sealed plug*
  - *supplied with spare fuses, valve connection accessories and wiring diagram*

**Weight: 200.302.48 1.5 kg / 3.3 lb**

# 200.302.48

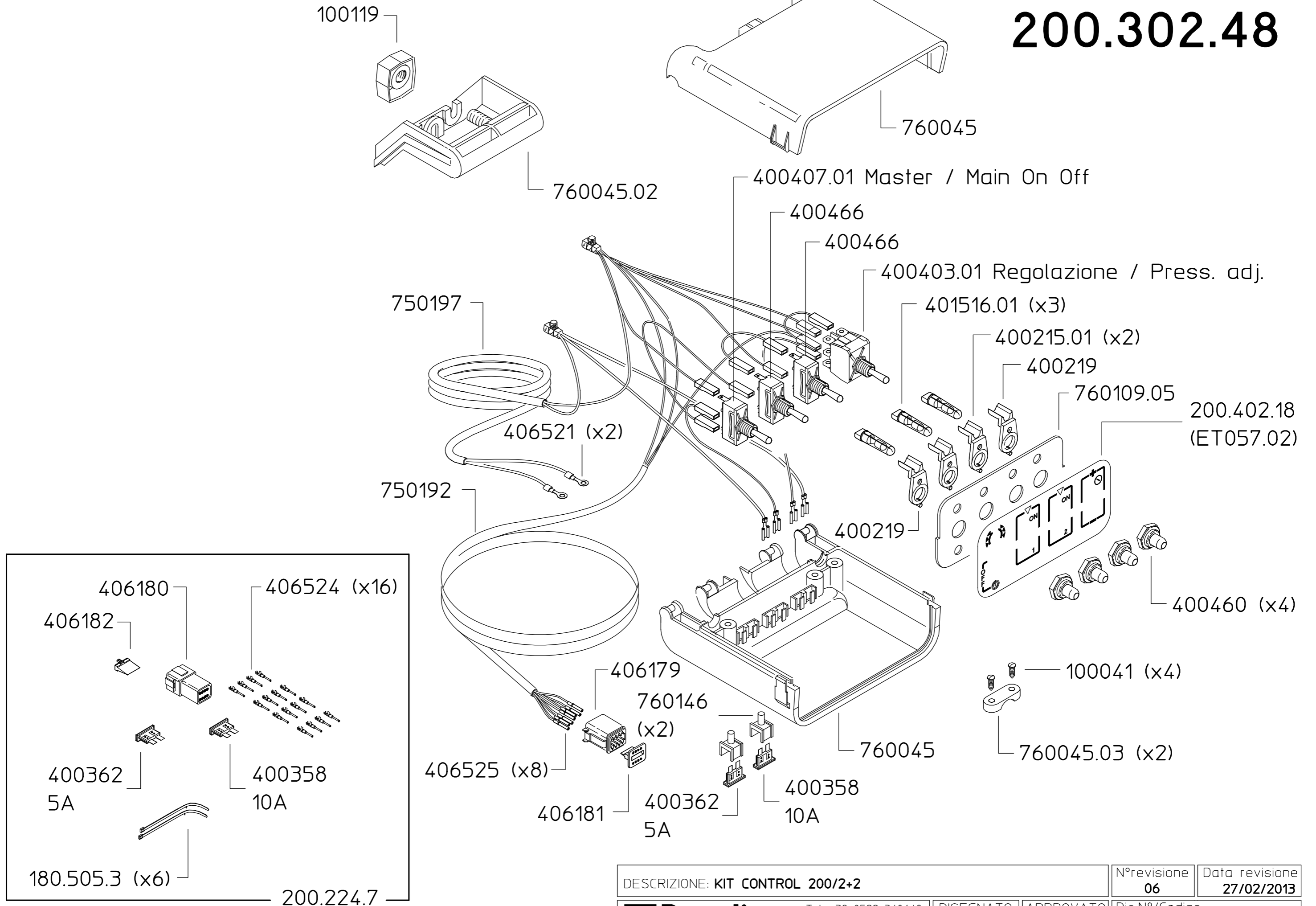

DESCRIZIONE: KIT CONTROL 200/2+2		N°revisione 06	Data revisione 27/02/2013
 Tel. +39 0522 340648 Fax. +39 0522 345025 I-42122 REGGIO EMILIA - ITALY - UE Email tecnico@braglia.it		DISEGNATO G.BRAGLIA	APPROVATO G.BRAGLIA
		Dis.N°/Codice <b>200.302.48</b>	

CROPLANDS PART NUMBER: B202.1510.9

M202 PRESSURE REGULATOR

WHERE USED: I-S4021

## REGOLATORE M202 M202 PRESSURE REGULATOR

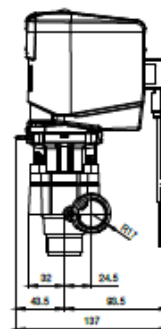
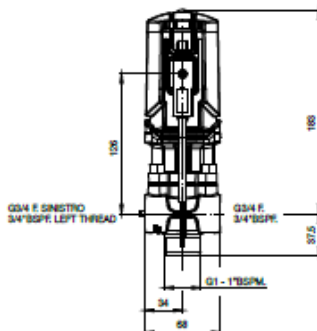

Standard con connettore DIN43650-A IP67 con cavo costampato 1.5 m  
 Pressione di esercizio max.: 40 bar  
 Tempo da  $P_0 - P_{max}$ : 16 s  
 Portata max.: 150 l/min con pressione residua di 4 bar  
 Pressione residua a 100 l/min: 2 bar  
 Peso: 1.9 Kg

**Materiali:** ottone - acciaio inox - alluminio con rivestimento in cataforesi - materiali plastici ad alta resistenza - sede e pistone valvola in acciaio inox temprato in vuoto - tenute in FPM  
**Impiego:** su atomizzatori e gruppiirroranti  
 Valvola di regolazione motorizzata 12Vdc a pressione costante. Modulare con le valvole serie M200. Membrana di separazione e tenuta o ring interposte tra fluido e componenti interni. Fine corsa elettronici. Eccellente per la regolazione manuale e assistita da computer. Elevata sensibilità, precisione e ripetibilità. Modificando il numero delle mandate in lavoro, la pressione subisce una variazione entro il 10% del valore impostato.

Standard with DIN43650-A IP67 connector 1.5 m integrated moulded cable  
 Max. operating pressure: 40 bar - 580 psi  
 Timing  $P_0 - P_{max}$ : 16 s  
 Max. output: 150 l/min (39.6 USGal/min) with 4 bar (58 psi) pump circuit residual pressure  
 100 l/min (26.4 USGal/min) pump circuit residual pressure: 2 bar (29psi)  
 Weight: 1.9 Kg (4.2 lb)

**Materials:** brass - stainless steel - aluminium with cathoporesis coating - high resistance plastic materials - vacuum hardened stainless steel piston and seat - FKM seals  
**Use:** on airblast sprayers  
 Constant pressure 12Vdc motor driven pressure regulating valve. Modular with M200 valve series. Diaphragm and o ring separates fluid from moving parts. Electronic limit switches. Excellent for both manual and computer driven pressure regulation. Elevated sensitivity, precision and repeatability. When section valves are switched off, holds constant working pressure between 10% variation.

### CARATTERISTICHE TECNICHE / TECHNICAL FEATURES

Icona	Parametro	Valore	Icona	Parametro	Valore
	bar / psi	40 / 580		12Vdc	0.8 - 2 A
	l/min-4bar / USGal/min - 58psi	150 / 39.6		On/Off	16 s
					-10 - +80°C

### COME SI ORDINA / HOW TO ORDER

CODICE / code	KIT RICAMBIO / spare parts kit
202.1510.9	20230276

**Service and Parts advice**

**NOTE**

SOME PARTS ARE NON-STOCK  
ITEMS AND MAY NEED TO BE  
ORDERED

# 202.1510.9

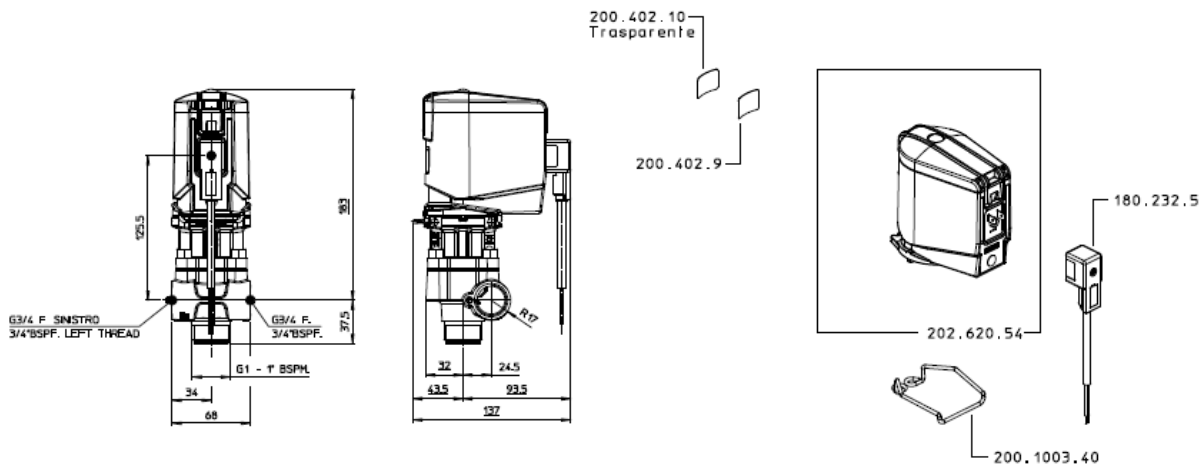

**ATTENZIONE IMPORTANTE**  
ASSEMBLARE 202.7.10 CON MARCHIO  
IN QUESTA POSIZIONE RISPETTO ALLE  
FILETTATURE G3/4F. DEL 401.218.16

Riempire il foro Ø3/Ø4 dall'Interno  
con grasso MOLY LT2

Verso di montaggio 202.211.1  
con foro Ø11 rivolto verso 202.7.10

7.602.12  
Assemblare  
su 401.1609.7

VERSO MONTAGGIO  
401.1006.7

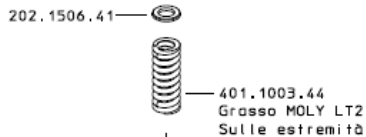
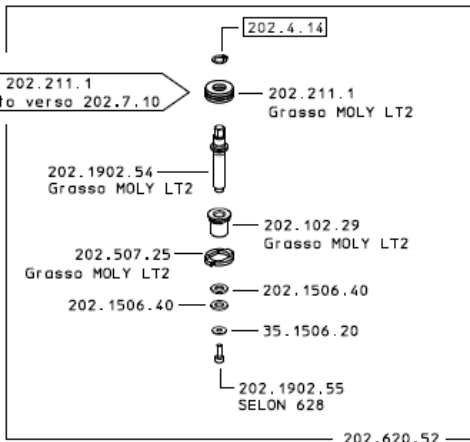
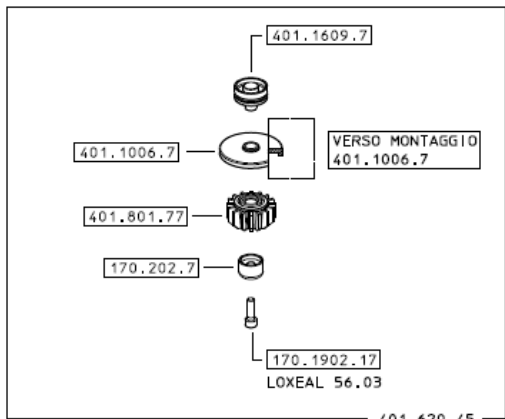

170.1603.29

166.1902.46



202.1617.81

**NOTE**

PLEASE ADD PREFIX **B** TO  
PART NUMBER TO REFLECT  
CROPLANDS PART NUMBER

COME SI ORDINA / HOW TO ORDER  
Kit ricambio  
Spare parts kit **202.302.76**

DESCRIZIONE: REGOLATORE M202 40BAR	Tel. +39 0522 34344	DISEGNATO	APPROVATO	Revisione	Data revisione
<b>Braglia</b> s.p.a.	0522 34020	ABRAGLIA	ABRAGLIA	05	30/08/2019
N.022 0000 0001 - ITALY - UE En818-1/2013				<b>202.1510.9</b>	

# 202.620.54

Alimentando + con 12Vdc il perno  
202.1304.83 ruota in senso orario

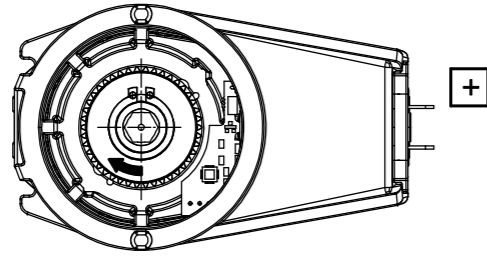

Vista inferiore lato  
Perno 202.1304.83

Con albero motore premuto  
verso il lato con i Faston

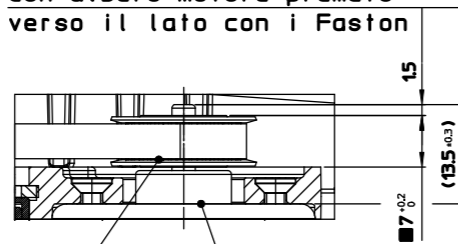

200.1311.2

180.1011.3

**Dettaglio Scala 2:1**

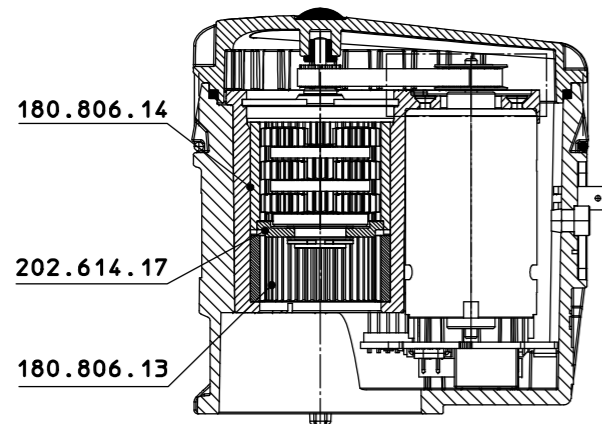

**Sez. A-A**

Saldare CAVO ROSSO  
su questo Faston

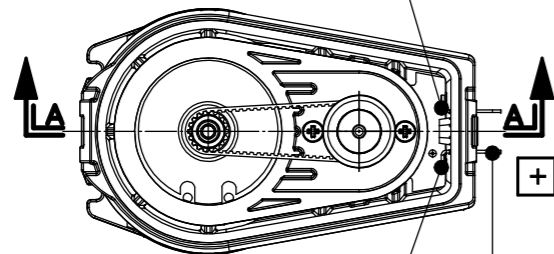

Saldare CAVO NERO  
su questo Faston

N°2 180.232.7

Vista superiore senza 200.215.13

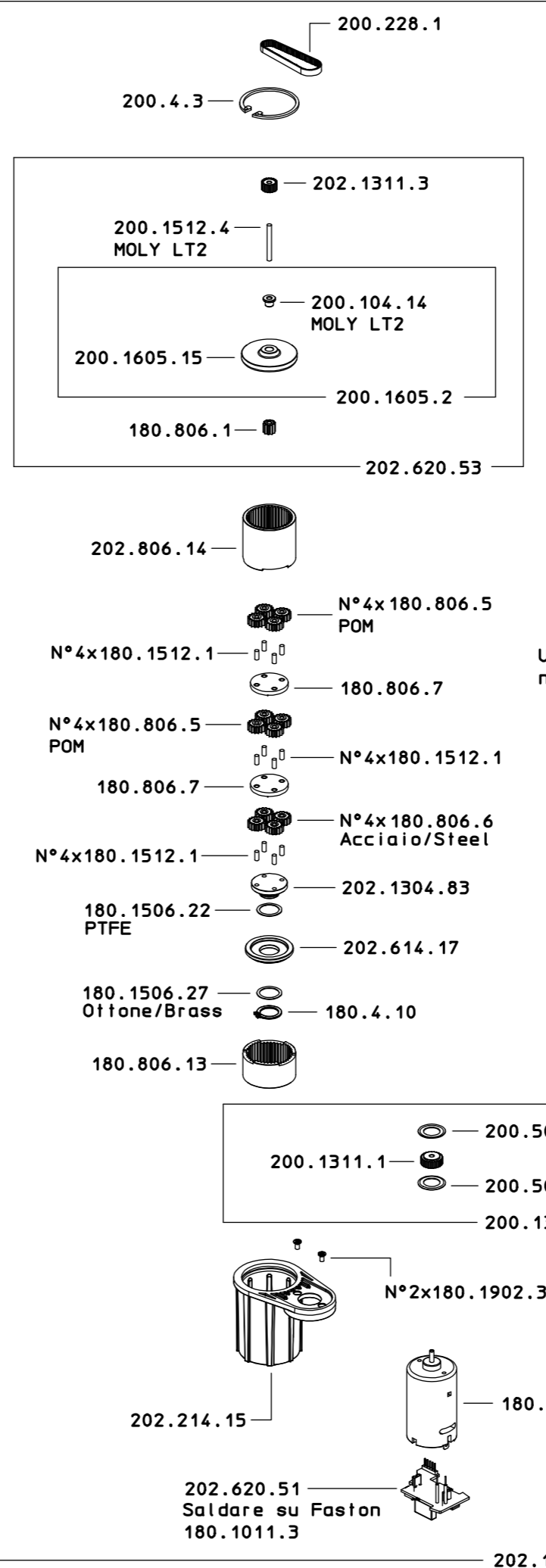

Motore assemblato su Cuffia 202.214.15  
con tasca quadrata in questa posizione  
rispetto al circuito stampato

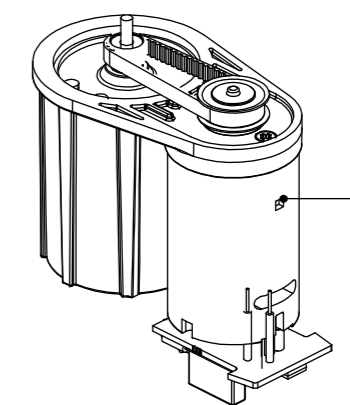

Utilizzare grasso LBT2  
nei piani di riduzione

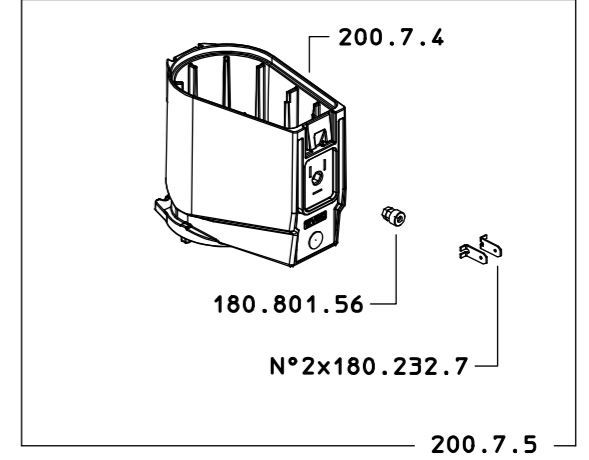
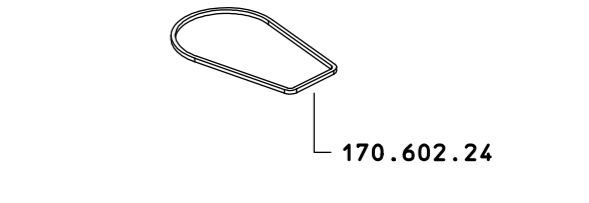
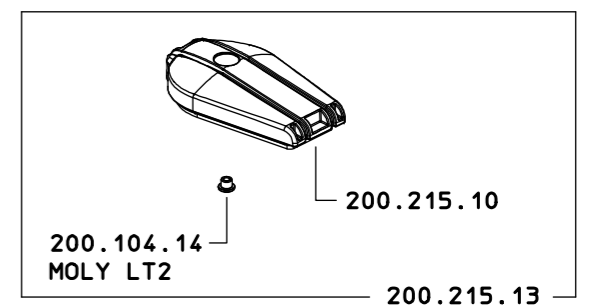
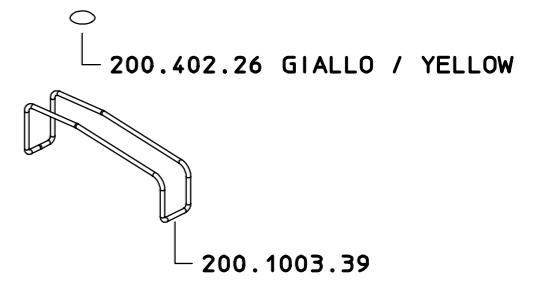

Controllo di processo in produzione 100%  
Ciclo di 5 secondi in entrambe le direzioni  
Assorbimento a vuoto < = 1A



M200

CROPLANDS

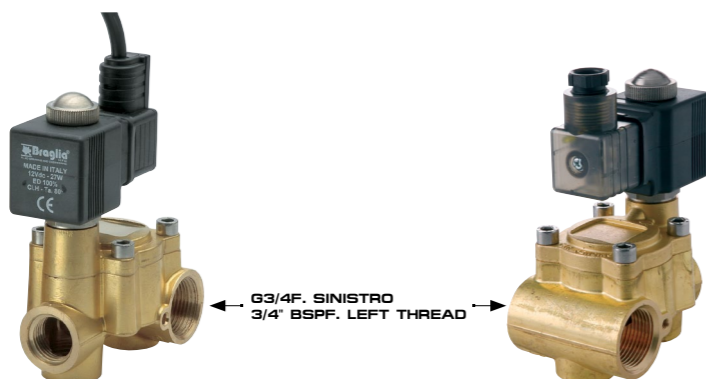
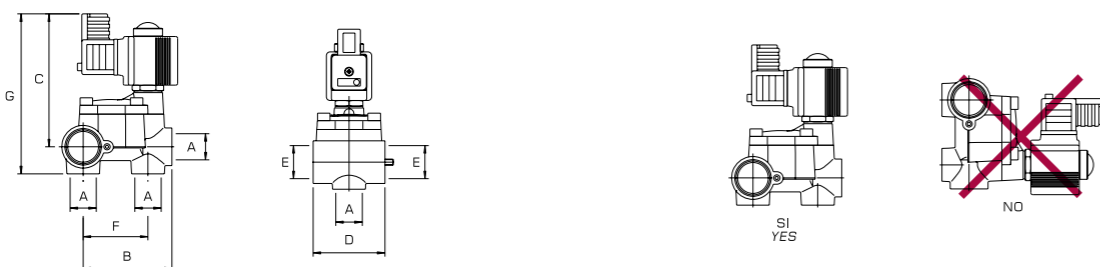
**200.1915.1**  
12Vdc - 27w - 40 bar / 580 psi**200.1915.2**  
12Vdc - 18w - 20 bar / 290 psi**200.1915.1 ML**  
12Vdc - 27w - 40 bar / 580 psi**200.1915.2 ML**  
12Vdc - 18w - 20 bar / 290 psi

**Standard con grano di centraggio. Versioni con connettore: LED di segnalazione valvola aperta**  
**Versioni:** **200.1915.1** bobina 27W 40 bar connettore DIN43650 A IP 67 cavo 1.5 m costampato 2 poli + terra  
**200.1915.2** bobina 18W 20 bar connettore DIN43650 A IP 67 cavo 1.5 m costampato 2 poli + terra  
**200.1915.1 ML** bobina 27W 40 bar connettore DIN43650 A - ISO4400 PG9 senza cavo  
**200.1915.2 ML** bobina 18W 20 bar connettore DIN43650 A - ISO4400 PG9 senza cavo  
**200.1915.1 NC** bobina 27W 40 bar senza connettore e senza cavo  
**200.1915.2 NC** bobina 18W 20 bar senza connettore e senza cavo

Pressione di esercizio max.: 200.1915.1 - 200.1915.1 ML - 200.1915.1 NC: 40 bar  
 200.1915.2 - 200.1915.2 ML - 200.1915.2 NC: 20 bar  
 Peso: 200.1915.1 1.3 kg - 200.1915.1 ML 1.1 kg - 200.1915.1 NC 1.0 kg  
 200.1915.2 1.2 kg - 200.1915.2 ML 1.0 kg - 200.1915.2 NC 0.9 kg

**Materiali:** ottone - acciaio inox - tenute in FPM - materiali plastici ad alta resistenza

**Impiego:** su atomizzatori e gruppi irroranti. Applicazioni in campo industriale  
 - Elettro valvola 12Vdc a solenoide normalmente chiusa (NC) servo azionata a membrana. Chiusura istantanea;  
 - Bobina a basso assorbimento, orientabile, incapsulata (classe H - 180°) a servizio continuo con doppia tenuta in FPM;  
 - Foro pilota e passaggi sovra dimensionati. Gruppo pilota in acciaio inox con trattamento nichel chimico e tenute in FPM;  
 - Sistema modulare brevettato con collettore di entrata comune. Utilizzabile singolarmente o assemblata in gruppi compatti con gli accessori disponibili. Una connessione di servizio in entrata, due connessioni di mandata configurabili.

**Standard with dowel. Models with connector: open valve warning LED**  
**Models:** **200.1915.1** 27W coil 40 bar (580 psi) DIN43650 A IP 67 connector 1.5 m integrated moulded cable 2 poles + ground  
**200.1915.2** 18W coil 20 bar (290 psi) DIN43650 A IP 67 connector 1.5 m integrated moulded cable 2 poles + ground  
**200.1915.1 ML** 27W coil 40 bar (580 psi) DIN43650 A - ISO4400 PG9 connector without cable  
**200.1915.2 ML** 18W coil 20 bar (290 psi) DIN43650 A - ISO4400 PG9 connector without cable  
**200.1915.1 NC** 27W coil 40 bar (580 psi) without connector and cable  
**200.1915.2 NC** 18W coil 20 bar (290 psi) without connector and cable

Max. operating pressure: 200.1915.1 - 200.1915.1 ML - 200.1915.1 NC: 40 bar / 580 psi  
 200.1915.2 - 200.1915.2 ML - 200.1915.2 NC: 20 bar / 290 psi  
 Weight: 200.1915.1 1.3 kg / 2.9 lb - 200.1915.1 ML 1.1 kg / 2.4 lb - 200.1915.1 NC 1.0 kg / 2.2 lb  
 200.1915.2 1.2 kg / 2.7 lb - 200.1915.2 ML 1.0 kg / 2.2 lb - 200.1915.2 NC 0.9 kg / 2 lb

**Materials:** brass - stainless steel - FKM seals - high resistance plastic materials

**Use:** on airblast sprayers. Industrial applications  
 - Normally closed (NC) 12Vdc servo operated diaphragm solenoid valve. Instantaneous shut-off;  
 - Low power consumption continuous duty incapsulated revolving coil (H class 180°) with double FKM seal;  
 - Oversized pilot and internal holes. Niploy processed stainless steel pilot unit with FKM seal;  
 - Patented modular system with built in manifold for one only inlet. Single unit use or modular assembly with suitable accessories. One service inlet, two outlets.

## CARATTERISTICHE TECNICHE / TECHNICAL FEATURES - 200.1915.1 - 200.1915.1 ML - 200.1915.1 NC

bar psi	l/min-1 bar USG pm-15psi	12Vdc	A	B mm	C mm	D mm	E	F mm	G mm	Filtro strainer	🔑
40 580	80 21	2A	G1/2F 1/2"BSPM.	70	104	57	G3/4F 3/4"BSPF.	51.5	127	80 mesh	-10°C - +80°C

## CARATTERISTICHE TECNICHE / TECHNICAL FEATURES - 200.1915.2 - 200.1915.2 ML - 200.1915.2 NC

bar psi	l/min-1 bar USG pm-15psi	12Vdc	A	B mm	C mm	D mm	E	F mm	G mm	Filtro strainer	🔑
20 290	80 21	1.3A	G1/2F 1/2"BSPM.	70	104	57	G3/4F 3/4"BSPF.	51.5	127	80 mesh	-10°C - +80°C

## COME SI ORDINA / HOW TO ORDER

CODICE code	VERSIONE model	CONNETTORE connector	COMPLETO DI CAVO cable supplied	KIT RICAMBIO spare parts kit
<b>200.1915.1</b>	27W - 40bar / 580 psi	DIN 43650 A - IP67	Costampato Integrated moulded	<b>200.302.46</b>
<b>200.1915.2</b>	18W - 20bar / 290 psi	DIN 43650 A - IP67	Costampato Integrated moulded	200.302.46
<b>200.1915.1 ML</b>	27W - 40bar / 580 psi	DIN 43650 A ISO 4400 PG9	NO	200.302.46
<b>200.1915.2 ML</b>	18W - 20bar / 290 psi	DIN 43650 A ISO 4400 PG9	NO	200.302.46
<b>200.1915.1 NC</b>	27W - 40bar / 580 psi	NO	NO	200.302.46
<b>200.1915.2 NC</b>	18W - 20bar / 290 psi	NO	NO	200.302.46

# 200.1915.1 200.1915.1 NC 200.1915.1 ML

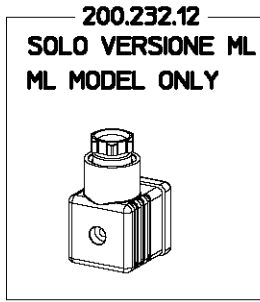

SOLO VERSIONE STANDARD  
STANDARD MODEL ONLY

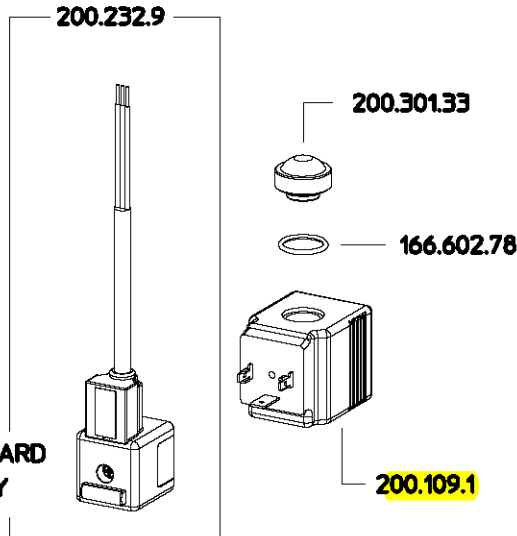

**NOTE**

PLEASE ADD PREFIX **B** TO  
PART NUMBER TO REFLECT  
CROPLANDS PART NUMBER

Assemblare il Gruppo  
200.620.14 sul Coperchio  
200.215.6 con coppia di  
serraggio di 20 Nm

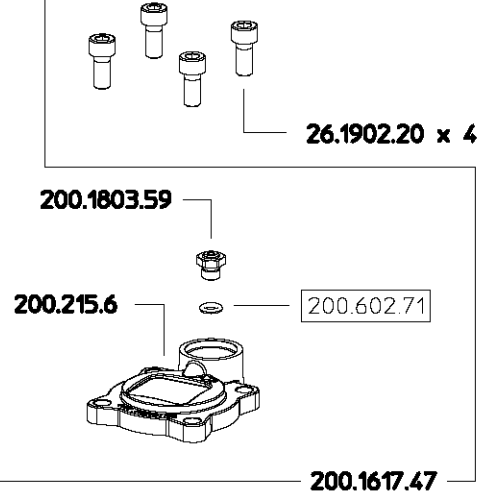
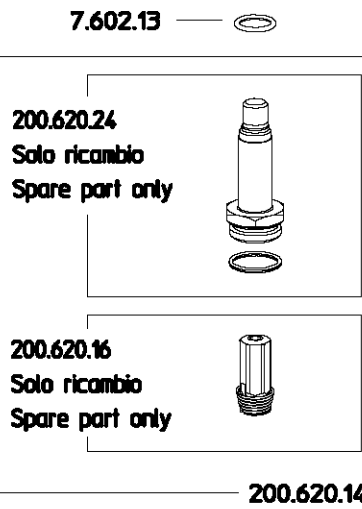

Marchatura laser su  
Coperchio 200.215.6

Verso di montaggio  
membrana 200.1006.5

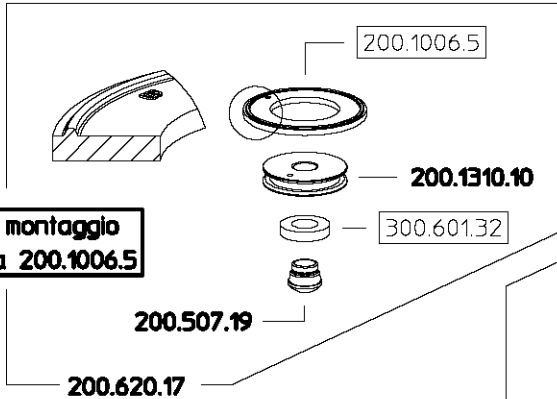

Assemblare la sede  
200.1603.37 sul corpo  
200.218.11 con coppia  
di serraggio di 30 Nm

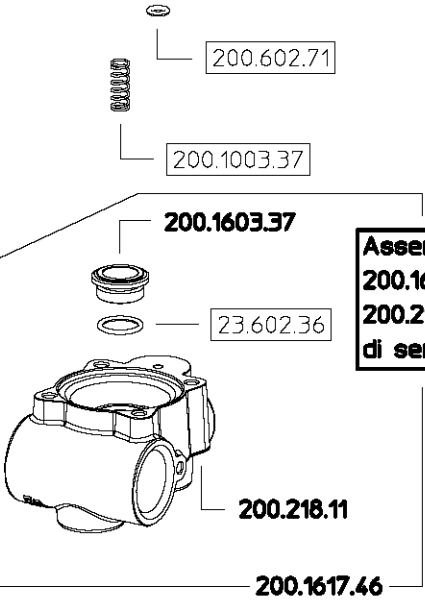

CONSULTARE L'ISTRUZIONE ISO 5 E IL CICLO  
DI LAVORAZIONE PER IL CONTROLLO DI  
PROCESSO ED IL COLLAUDO FINALE

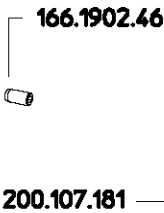

COME SI ORDINA / HOW TO ORDER

Kit ricambio  
Spare parts kit **200.302.46**

DESCRIZIONE: VALVOLA M200 27W 40BAR

**Braglia** SRL  
Tel. +39 0522 340648  
Fax. +39 0522 345025  
I-42122 REGGIO EMILIA - ITALY - UE Email tecnico@braglia.it

DISEGNATO  
**GBRAGLIA**

APPROVATO  
**GBRAGLIA**

N°revisione  
**10**

Data revisione  
**16/11/2011**

Dis N°/Codice  
**200.1915.1**





# CROPLANDS

## M1 45

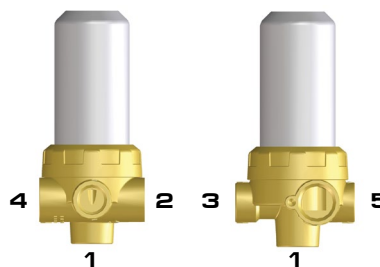
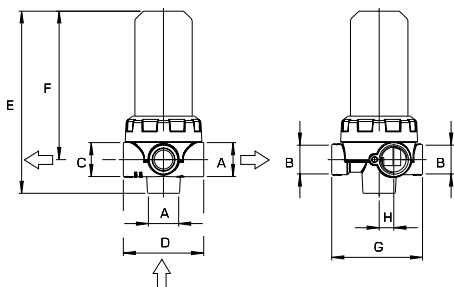

POSIZIONE position	FILETTATURA thread	IMPIEGO E COLLEGAMENTI connection and use
1	G3/4F. 3/4" BSPF.	Entrata Inlet
2	G3/4F. 3/4" BSPF.	Uscita autopulente con regolatore (by pass in cisterna) oppure rubinetto di drenaggio Self cleaning outlet with pressure regulator (tank by pass) or wash down ball valve
3	G1/2F. 1/2" BSPF.	Uscita filtrata Filtered outlet
4	G3/4F. sx. 3/4" BSPF. left thread	Uscita filtrata: Nipplo 200.1101.18 opzionale per ottenere G3/4M. Filtered outlet: Optional 200.1101.18 nipple to 3/4" BSPM.
5	G1/2F. 1/2" BSPF.	Uscita filtrata per manometro (o altri impieghi con bassa portata) Filtered outlet for pressure gauge (or other uses with low output)

**Standard completi di cartuccia filtrante. Tappi e raccordi di collegamento non compresi**

Versioni: **145.504.4** cartuccia 40mesh  
**145.504.4 30** cartuccia 30mesh  
**145.504.4 80** cartuccia 80mesh  
**145.504.4 10** cartuccia 100mesh

Pressione di esercizio max.: 50 bar  
 Portata massima: 150 l/min con perdita di carico di 1 bar  
 Peso: 1.3 kg

**Materiali:** ottone - acciaio inox - NBR

**Impiego:** Su atomizzatori e gruppi irroranti. Ideale per il completamento delle configurazioni che prevedono elettrovalvole della serie M200. Filtri di mandata in linea con sistema autopulente brevettato della cartuccia filtrante. Il sistema autopulente ottiene le migliori prestazioni se utilizzato con un regolatore di massima pressione manuale della serie M401 o elettrico della serie M200. Questi filtri possono anche essere utilizzati individualmente (avvalendosi anche del Kit staffa M200 - 200.805.13) oppure in modalità modulare, utilizzando il collettore comune, con le elettrovalvole e i componenti della serie M200. Cartucce filtranti a doppia rete inox rinforzata.

**Standard with screen. Plugs and connections not included.**

Models: **145.504.4** 40mesh screen  
**145.504.4 30** 30mesh screen  
**145.504.4 80** 80mesh screen  
**145.504.4 10** 100mesh screen

Max. operating pressure: 50 bar / 725 psi

Max. capacity: 150 l/min with 1 bar pressure drop - 39.5 USGal/min with 14.5 psi pressure drop

Weight: 1.3 kg / 2.9 lb

**Materials:** brass - stainless steel - Buna N

**Use:** on mist blowers and sprayers. Best suited to complete M200 series valve assemblies. Line pressure filters with patented screen self cleaning system. The maximum performance of the self cleaning system is obtained if used in conjunction with M401 series manual pressure relief valve or M200 pressure regulators. Can be used alone (fits M200 bracket kit - 200.805.13) on modular assembly with M200 solenoid valves and parts. Double reinforced stainless steel screens.

**COME SI ORDINA / HOW TO ORDER**

CODICE code	MESH	A	B	C	D mm	E mm	F mm	G mm	H mm	
<b>145.504.4</b>	40			G3/4F. sinistro						5
<b>145.504.4 30</b>	30	G3/4F.	G1/2F.	3/4BSPF. Left						5
<b>145.504.4 80</b>	80	3/4BSPF.	1/2" BSPF.	thread	80	180	146	90	14,5	5
<b>145.504.4 10</b>	100									5

145.504.4  
 145.504.4 10  
 145.504.4 30  
 145.504.4 80

200.402.28  
 ROSSO/RED  
 PER/FOR 145.504.4 30 30 MESH

200.402.27  
 BLU/BLUE  
 STANDARD 40 MESH

200.402.26  
 GIALLO/YELLOW  
 PER/FOR 145.504.4 80 80 MESH

200.402.17  
 VERDE/GREEN  
 PER/FOR 145.504.4 10 100 MESH

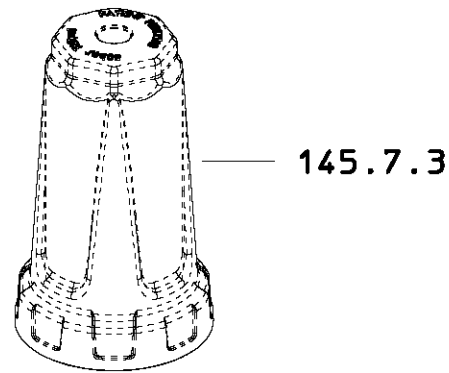

144.203.12  
 PER/FOR 145.504.4 30 30 MESH

144.203.11  
 STANDARD 40 MESH

144.203.8  
 PER/FOR 145.504.4 10 100MESH

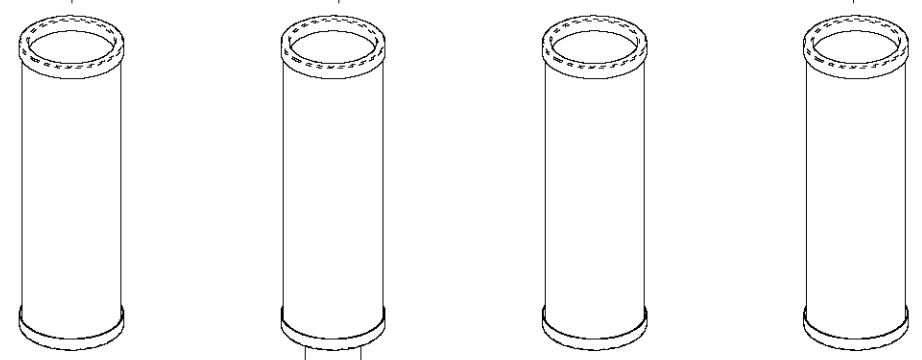

145.1703.81  
 LOXEAL 56-03

144.203.23  
 PER/FOR 145.504.4 80 80 MESH

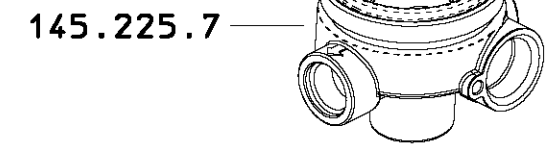
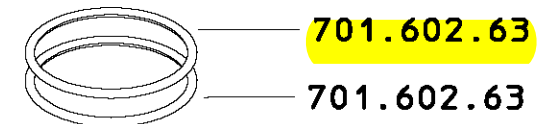

**NOTE**  
 PLEASE ADD PREFIX **B** TO  
 PART NUMBER TO REFLECT  
 CROPLANDS PART NUMBER

**NOTE**  
 SOME PARTS ARE NON-STOCK  
 ITEMS AND MAY NEED TO BE  
 ORDERED

DESCRIZIONE: <b>FILTRO M45 40 MESH</b>		N°revisione <b>05</b>	Data revisione <b>04/02/2013</b>
<b>Braglia</b> SRL I-42122 REGGIO EMILIA - ITALY - UE Email tecnico@braglia.it	Tel. +39 0522 340648 Fax. +39 0522 345025	DISEGNATO <b>G.BRAGLIA</b>	APPROVATO <b>G.BRAGLIA</b>
	Dis.N°/Codice <b>145.504.4</b>		

## CROPLANDS PART NUMBERS: B180.1005.20 – GUAGE 60BAR REAR ENTRY ½” BSPM 100mm



CODICE <i>code</i>	SCALA BAR <i>bar scale</i>	Ø mm	ATTACCO <i>connection</i>	RADIALE/POSTERIORE <i>bottom/back entry</i>	MATERIALE CASSA <i>case material</i>	CLASSE <i>rating</i>	
180.1005.13	0/60	100		Radiale-Bottom entry			
<b>180.1005.20</b>	<b>0/60</b>	<b>100</b>	<b>G1/2M-1/2" BSPM.</b>	<b>Posteriore-Back entry</b>	<b>Inox-s. steel</b>	<b>1</b>	<b>2</b>
180.1005.19	0/40	100		Radiale-Bottom entry			
180.1005.16	0/25	100		Radiale-Bottom entry			