

## HP-319-10

### FAN PROPELLER QM-420

Glass Fibre Reinforced Polypropylene, UV stabilised. Black.

Maximum operating speed = 3,000 rpm

Weight = 959gm

Normally the fan is operated with the Front Cover, HP-319-15.

Attach the cover to the fan via 5pcs, M4 x 50 SS Screws

Overspeed testing to 5,725 rpm included the front cover.

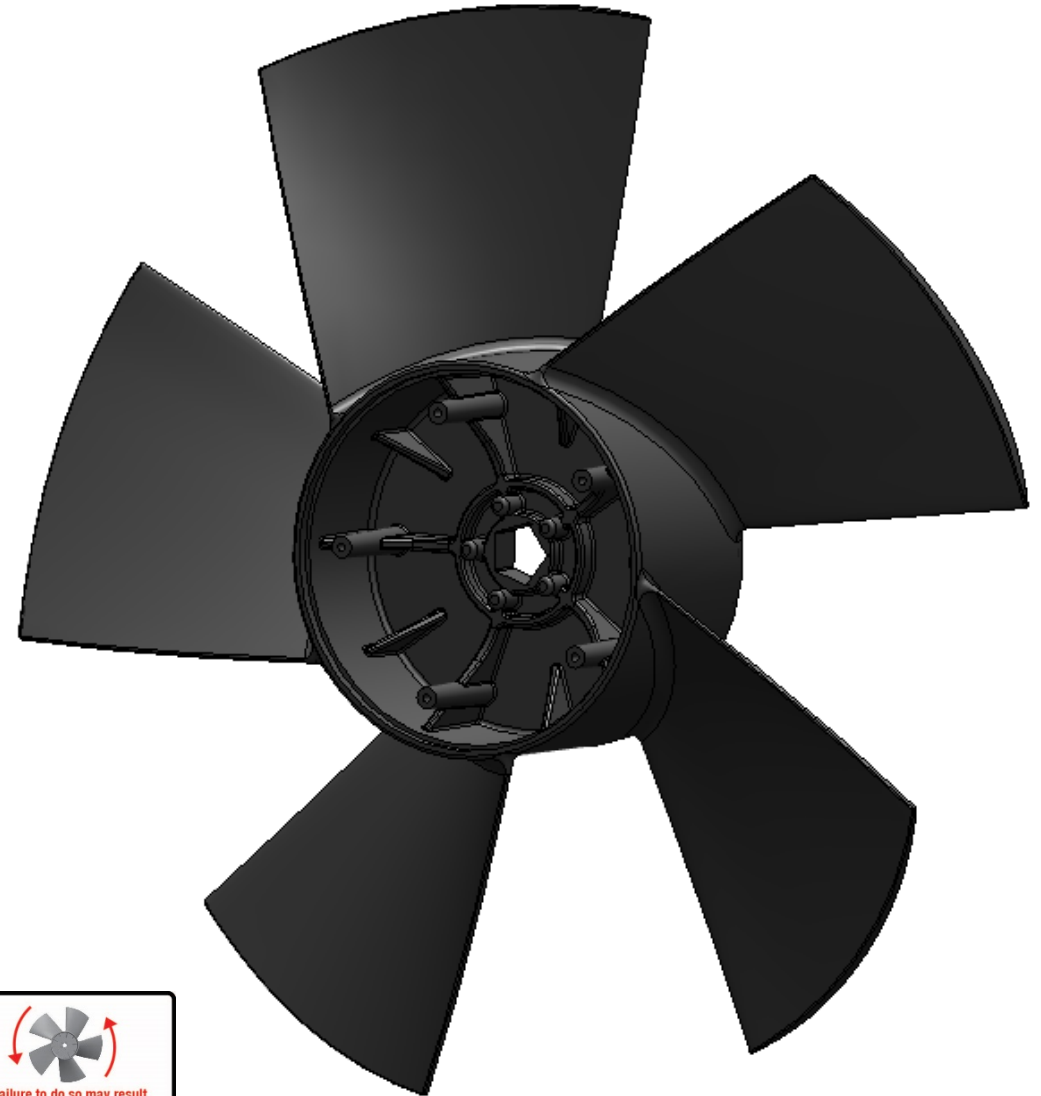
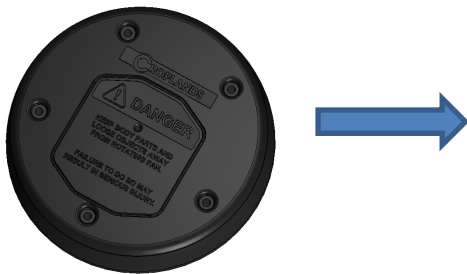

### NOTE

Drawings are for illustration purposes only - refer to sprayer for actual plumbing. Parts lists are indicative of the sprayer type.

*Items in italics* or without a part number are non stocked items and may need to be specially ordered.

For further parts information refer to [www.croplands.com.au](http://www.croplands.com.au)

**⚠ DANGER**

**KEEP BODY PARTS AND  
LOOSE OBJECTS AWAY  
FROM ROTATING FAN**

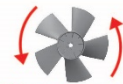

Failure to do so may result  
in serious injury.

Croplands Equipment Pty Ltd XD-195