

HP-319-3

COWL QM-420

Tough roto-moulded polyethylene, UV stabilised, RED.

Inserts use M12 x 1.75 bolts.

Weight, 4.3kg

Note the speed sensor cut-out is always installed at the bottom.

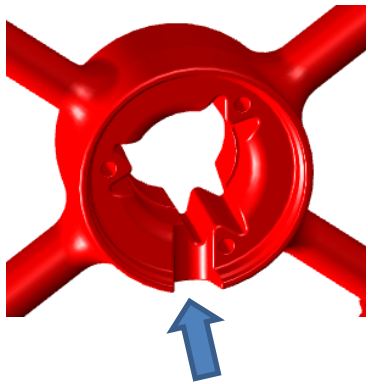

NOTE

Drawings are for illustration purposes only - refer to sprayer for actual plumbing. Parts lists are indicative of the sprayer type.

Items in italics or without a part number are non stocked items and may need to be specially ordered.

For further parts information refer to www.croplands.com.au

