

ITEM NO.	PART NUMBER	DESCRIPTION	QTY.
1	AB19107R	FIRST ARM R.H. 33/36M	1
	AB19107L	FIRST ARM L.H. 33/36M	1
2	AB19100-A-2	FIXED WINGTIP ADJUSTMENT	1
3	AB19100-A-3	HYDRAULIC WINGTIP ADJUSTMENT	1
4	AB19113CR	FOLD PIVOT OUTER R.H.	1
	AB19113CL	FOLD PIVOT OUTER L.H.	1
5	AB19132	SPRING BOOM SUPPORT 36M	1
6	AB19135	PIN 36M 1ST ARM TO 2ND	1
7	AB19150-130A	PIN 130 X 30 C/W WASHERS & SCREWS	1
8	AB19150-65A	PIN 65 X 25.4 C/W WASHERS & SCREWS	3
9	AB19157A	BRACKET OUTER BOOM	1
10	AB19157Apad	PAD OUTER BOOM SUPPORT	1
11	AB19159	SPRING LOCK ARM	1
12	AB19160R	ARM HINGE LOCK R.H.	1
	AB19160L	ARM HINGE LOCK L.H.	1
13	AB19161R	PLATE HINGE LOCK RH	1
	AB19161L	PLATE HINGE LOCK L.H.	1
14	AB19163	ROD G-FIX	1
15	AB19164	SPRING RETAINER PLATE	1
16	AB19165	PIVOT BLOCK	1
17	AB19178	ARM FOLD PIVOT OUTER	1
18	AB19179	LINK PLATE OUTER FOLD RAM	1
19	AB19180	PIN PIVOT BLOCK G-VAR	2
20	AB19181	PIN OUTER FOLD SCISSOR JOINT	3
21	AB19197	CYLINDER OUTER FOLD 3.5 X 12	1
22	AB19197-SK	SEAL KIT HP-016 CYLINDER	1
23	AB20800	CYLINDER FOLD LOCK 35 X 38.1	1
24	AB20800-1	LOCK NUT 1 1/4" BSP	1
25	1.25UNFNUT	1 1/4" UNF NYLOC NUT	1
26	M20X100BOLT	M20 X 100 HEX HEAD BOLT HT ZP	1
27	M20NNUT	M20 NYLOC NUT HT ZP	3
28	M20HNUT	M20 HALF NUT ZP	1
29	M20FWASHER	M20 FLAT WASHER ZP	3
30	M12HNUT	M12 HEX NUT HT ZP	2
31	M12X70	M12 X 70 SET SCREW HT ZP	1
32	M12X60BOLT	M12 X 60 BOLT HT ZP	1
33	M12X40	M12 X 40 HEX HEAD SET SCREW HT ZP	3
34	M12X25	M12 X 25 SET SCREW HT ZP	1
35	M12NNUT	M12 NYLOC NUT HT ZP	3
36	M12FWASHER	M12 FLAT WASHER ZP	12
37	M12SWASHER	M12 SPRING WASHER ZP	1
38	M10X30	M10 X 30 SET SCREW HT ZP	4
39	M10X20	M10 X 20 SET SCREW HT ZP	2
40	M10NNUT	M10 NYLOC NUT HT ZP	6
41	M10FWASHER	M10 FLAT WASHER ZP	8
42	M6GNIPPLE	M6 GREASE NIPPLE	11
43	XBMBB50	U-BOLT 50MM X 10	1

THIS DRAWING IS FOR ILLUSTRATION PURPOSE ONLY
PLEASE REFER TO THE PARTS LIST.

UNLESS OTHERWISE SPECIFIED: DIMENSIONS ARE IN MILLIMETERS SURFACE FINISH: TOLERANCES: LINEAR: ANGULAR:		FINISH: N/A	DEBUR AND BREAK SHARP EDGES	DO NOT SCALE DRAWING	ISSUE	C
DRAWN RPJUCO			SIGNATURE	DATE 01/209	REVISION 100511	
CHKD						
APPVD						
MFG						
Q.A						
MATERIAL: N/A			DWG NO. AB19100-BR-36		A2	
WEIGHT:			SCALE: 1:16.5		SHEET 1 OF 1	

COPYRIGHT PROPRIETOR
THE DRAWING IS THE PROPERTY OF CROPLANDS PTY. LTD.
REPRODUCTION OF THIS DRAWING FOR PARTS OR COMMUNICATION OF ITS
CONTENTS IS PROHIBITED WITHOUT THE CONSENT OF CROPLANDS PTY. LTD.

ITEM NO.	PART NUMBER	DESCRIPTION	QTY.
1	AB19109L	BOOM ARM OUTER LH 36M	1
	AB19109R	BOOM ARM OUTER RH 36M	1
	AB19110L	BOOM ARM OUTER LH 33M	1
	AB19110R	BOOM ARM OUTER LH 33M	1
2	AB19111A	BREAK-AWAY HITCH	1
3	AB19106AL	BREAK-AWAY TIP	1
4	AB19126-5	PULLEY	1
5	AB19152-330A	PIN OUTER BOOM SUPPORT	1
6	AB21200A	TOP LINK ADJUSTMENT	1
	AB21200A-1	BUSH	2
7	AB19126-4	MALE ROD END	1
8	AB19126-6	CABLE, PULLEY	1
9	AB19126-7	SPACER BUSH	2
10	MP-413	ADJUSTABLE SPRING HITCH	1
11	MP-519	SPRING	1
12	MP-598A	PROTECTION BRACKET FENCELINE V2	1
13	0.75X100UNCBOLT	3/4" X 4" UNC BOLT HT ZP	2
14	0.75UNCNNUT	3/4" UNC NYLOC NUT HT ZP	2
15	0.75UNFHNNUT	3/4" UNF HEX HALF NUT	1
16	0.75FWASHER	3/4" FLAT WASHER ZP	4
17	M20X100BOLT	M20 X 100 HEX HEAD BOLT HT ZP	1
18	M20NNUT	M20 NYLOC NUT HT ZP	1
19	M20FWASHER	M20 FLAT WASHER ZP	2
20	M16NNUT	M16 NYLOC NUT HT ZP	2
21	M16HNUT	M16 HEX NUT HT ZP	4
22	M16FWASHER	M16 FLAT WASHER ZP	2
23	M12X90	M12 X 90 BOLT HT ZP	1
24	M12X50	M12 X 50 SET SCREW HT ZP	1
25	M12X40	M12 X 40 HEX HEAD SET SCREW HT ZP	1
26	M12NNUT	M12 NYLOC NUT HT ZP	3
27	M12FWASHER	M12 FLAT WASHER ZP	7
28	M10X30	M10 X 30 SET SCREW HT ZP	4
29	M10NNUT	M10 NYLOC NUT HT ZP	4
30	M10FWASHER	M10 FLAT WASHER ZP	8
31	M6GNIPPLE	M6 GREASE NIPPLE	1

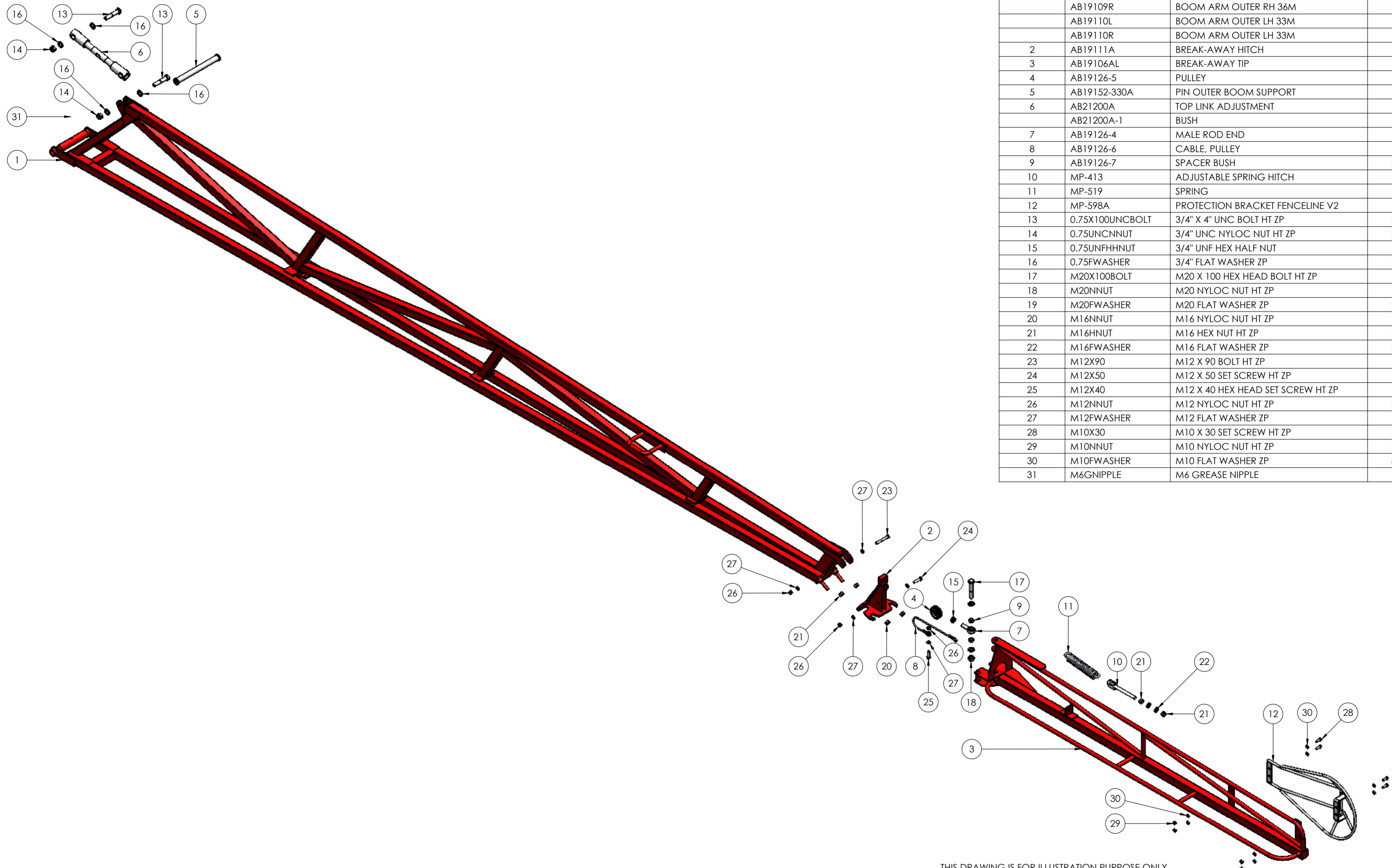

THIS DRAWING IS FOR ILLUSTRATION PURPOSE ONLY
PLEASE REFER TO THE PARTS LIST.

UNLESS OTHERWISE SPECIFIED: DIMENSIONS ARE IN MILLIMETERS		FINISH: N/A		DEBUR AND BREAK SHARP EDGES		DO NOT SCALE DRAWING		ISSUE		B	
SURFACE FINISH:											
TOLERANCES:											
LINEAR:											
ANGULAR:											
DRAWN		NAME		SIGNATURE		DATE		REVISION		TITLE:	
CHKD		RPJUCO				250110				36M AGRIBOOM	
APPVD										OUTER BOOM WING ILLUSTRATION	
MFG										DWG NO.	
Q.A										Outer Wing	
MATERIAL:										A2	
WEIGHT:										SCALE: 1:15	
SHEET 1 OF 1											