

B180.1910.016HS (Electric Valves)

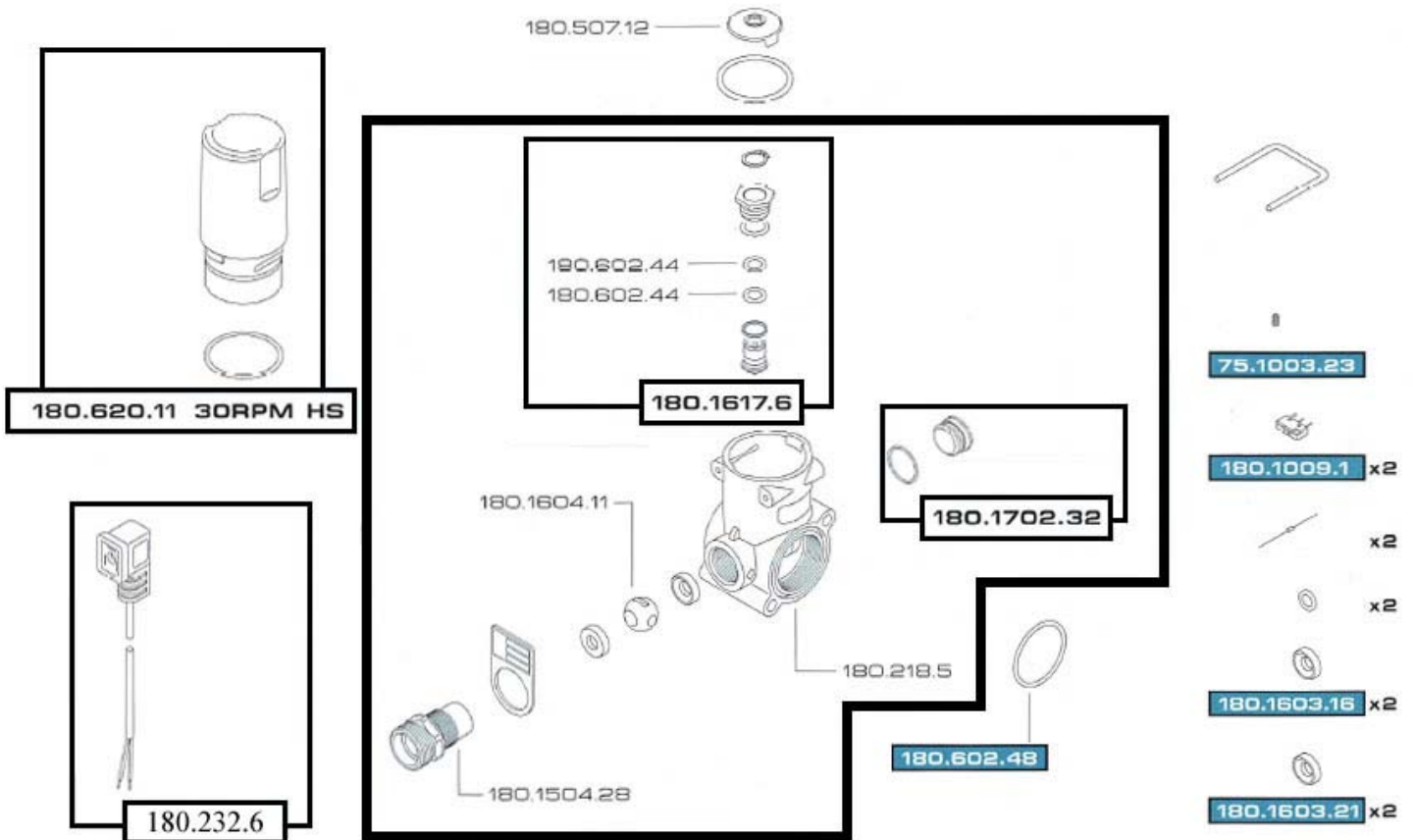

Max. Pressure	L / Min – 1 bar	12Vdc	Inlets	Outlets	On/Off Speed	Temperature
40 bar 580 psi	110 lpm	0.3 – 0.7 A	1" M	2 x 1 1/4" F	0.3 s	-10 °C +50 °C



180.1910.16 HS

Solo per kit
Only for kit

280.507.8

75.1003.23

180.1009.1 x2

180.1009.3 x2

180.306.1 x2

180.602.50 x2

180.1603.16 x2

180.1603.21 x2

142.602.18

180.620.11 22 RPM

180.507.12

180.602.49

180.232.5

180.507.13

180.4.8

180.614.7

68.602.9

180.602.44

180.602.44

180.1506.26

180.1304.55

180.1617.6

180.1603.18

180.1604.11

180.1603.18

200.402.9

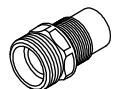

180.1504.28

200.402.10

180.107.77

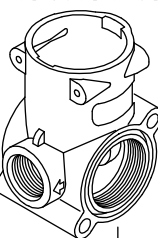

180.218.5

180.602.30

180.1702.32

180.602.48

Come si ordina/How to order
Kit ricambio-Cod. **180.302.31**
Spare parts kit-C/N.

DENOMINAZIONE: Valvola scarico rapido AP 12Vcc G3/4 G1 HS

Braglia SRL Tel. ++39 0522 340648
Fax. ++39 0522 345025
I-42029 Masone (REGGIO EMILIA)-ITALY-UE Email braglia@braglia.it

STE

RTE

N°revisione 02 Data revisione: 11/09/09

Dis.N°/Codice

180.1910.16 HS