

ref.	codice-code	qt.	d.815 - 48VNSCRO001	d.815 - 48VNSCRO001
1	RET00000235	1	RETE D. 820 VERN. NERA	FAN GUARD D.820 BLACK
2	CNI00000052	1	CONVOGLIATORE VNS D.820 H.320 INOX	SS FAN HOUSING D.820 H.320
3	PIA00000564	1	PIASTRA PT/201 1100 CM12-VNS 815 CROPLANDS	PT/201 BACKPLATE 1100 CM12-VNS 815 CROPLANDS
48	DVI00000012	1	DEVIATORE H.212 INOX	SS BOTTOM DEFLECTOR H.212
52	CAV00000042	1	CAVALLETTO VERNICIATO CM12	CM12 BLACK PAINTED FRAME
110	RET00000136	1	RT/25 PROTEZIONE EXPORT VNS 815 VERN. NERA	RT/25 SAFETY GUARD 815 BLACK
150	CON00000028	1	CON/90 CONO CM12VNS FORATO X LIVELLO OLIO	CON/90 CONE CM12VNS WITH HOLE TO CHECK OIL
153	SET00000057	2	VNS/570 SETTORE X VNS 815 INOX FORATO X GETTI	VNS/570 SS RING WITH HOLES
160	NIP00000007	14	NIP/M18x1.5 NIPPLO PROLUNGA GETTO VNS OTTONE	NIP/M18x1.5 BRASS NIPPLE FOR BRAGLIA NOZZLE
161	DAD00000049	28	DAD/M18x1.5 CONTRODADO NIPPLO PROLUNGA GETTI VNS	DAD/M18x1.5 BRASS NUT NIPPLE FOR BRAGLIA NOZZLE
300	DIS00000116	7	DISTANZIERE H30 NERO	H.30 BLACK SPACER
304	PIA00000558	1	VNS/620 PIASTRINA COPERTURA ASOLA PT-VNS INOX	VNS/620 SS PLATE TO COVER THE HOLE ON BACKPLATE
	KITVNS00004	14	KIT PALETTE VNS RDH90H120+BULLONI INOX	KIT BLADES VNS RDH90H120+SS BOLTS
44-B	TERVNS00004	1	TE 8MA X 240 ZN	TE 8MA X 240 GALVANIZED
90	PAL00000077	1	VNS/500 PALETTA RDVNS. H120	VNS/500 RDVNS H.120 DEFLECTOR
91	PAL00000078	1	VNS/520 PALETTA RDVNS. H90	VNS/520 RDVNS H.90 DEFLECTOR
	RON00000204	1	RONDELLA 8X17 INOX	SS WASHER 8x17
	AUT00000108	1	AUTOBLOCCANTE 8MA ALTO INOX	SS LOCKNUT 8 MA
44	DIS00000113	1	DIS/VNS/815 DISTANZIERE H212 NERO	DIS/VNS/815 H. 212 SPACER
	TBI00000003	2	TBCE 8X25 INOX	SS TBCE 8X25
	TEI00000034	2	TE 8X30 INOX	SS TE 8X30
	AUT00000005	4	AUTOBLOCCANTE 8MA ZN	LOCKNUT 8MA
	RON00000204	6	RONDELLA 8X17 INOX	SS 8X17 WASHER
44-A	PIA00000204	1	DIS/VNS/01 PT DISTANZ.VNS	DIS/VNS/01 PLATE FOR SPACER VNS
	BULLONI0173	1	KIT BULLONI H.240mm VNS815	KIT BOLTS H.240mm VNS815
43A	RON00000114	2	RONDELLA 10X21	10X21 GALVANIZED WASHER
43C	AUT00000001	2	AUTOBLOCCANTE 10 MA	LOCKNUT 10 MA
43B	TER00000069	2	TE R80 10X240 ZN	TE R80 10X240
4	TUB00000084DX	1	TUBO INOX COMPLETO 7M.DX X VNS 815-913	SS COMPL. MANIFOLD 7 CLAMPS RIGHT X VNS 815-913
4	TUB00000084SX	1	TUBO INOX COMPLETO 7M.DX X VNS 815-913	SS COMPL. MANIFOLD 7 CLAMPS LEFT X VNS 815-913
4G	TAP00000001	1	TAPPO ½ GAS F.	½ F. GAS CAP
4M	CUR00000001	1	CURVA ½ - ½ GAS	½ - ½ GAS ELBOW
4T	TUB00000184DX	1	TUBO INOX 7FORI 815-913 VNS DX - 900mm	PIPE 7 HOLES815/913VNS 900mm RIGHT
4T	TUB00000184SX	1	TUBO INOX 7FORI 815-913 VNS SX - 900mm	PIPE 7 HOLES815/913VNS 900mm LEFT
	MOR00000003	7	MORSETTO COMPLETO	COMPLETE CLAMP
4A	MOR00000001	7	MORSETTO ¼ F GAS	¼ F. GAS CLAMP
4C	OR000000014	7	OR 3030 VITON	3030 VITON "O" RING
4E	TCC00000119	14	TCCE 6X14 INOX	SS 6X14 BOLT
	BULLONI0143	1	BULLONI X TUBI	BOLTS FOR MANIFOLDS
4S	STA00000001	4	STAFFE ZINCATE PER TUBI	GALVANISED STIRRUPS FOR PIPES
	TEI00000025	4	TE 10X25 INOX	SS TE 10X25
	AUT00000001	4	AUTOBLOCCANTE 10MA ALTO	10MA LOCKNUT
10-11	VNS815CRO02	1	VENTOLA VNS815 CG+FRIZIONE ANODIZ+coperchio	815VNS FAN-A-CG+CLUTCH-ANODIZED+cover
299	MOLZZ000089	1	MOLTIPLICATORE SENZA LEVA CM12VNS GRIGIO	CM12VNS PAINTED GEARBOX - WITHOUT LEVER
302	KITFIT00109	1	KIT LEVA DRITTA COMPLETA - CM12 913 FT	KIT- CM12 COMPLETE LEVER
303	KITFIT00110	1	KIT LEVA MOBILE COMPLETA - CM12 913 FT	KIT- CM12 COMPLETE LEVER

d. 815VNS FAN-48VNSCRO002

aggiornato al 21/11/2014

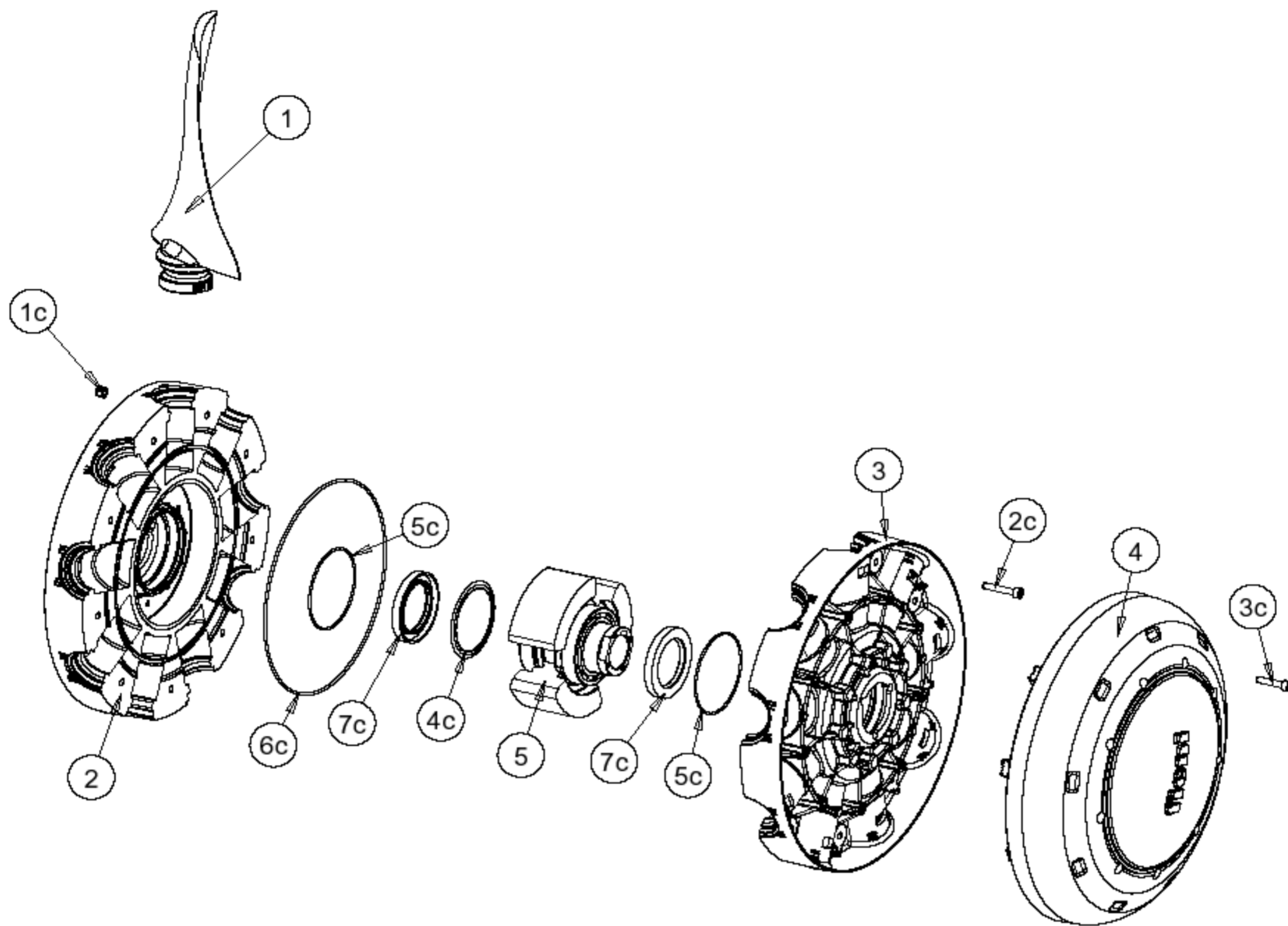

d. 815VNS FAN

ref.	codice-code	qt.	VENTOLA COMPLETA D.815VNS	D.815VNS COMPLETE FAN
	48VNSCRO002	1	VENTOLA COMPLETA D.815VNS	D.815VNS COMPLETE FAN
1	PAL00000081	9	PALA NYLON VETRO VNS 815mm	D. 815mmVNS NYLON GLASS BLADE
1c	AUT00000004	9	AUTOBLOCCANTE M6	M6 LOCKNUT
2	FUS00000292	1	SEMIMOZZO VNS/30 MASCHIO CON FERODO	HALF HUB VNS/20 MALE WITH LINING
2c	TCC00000140	9	TCCE 6X35 INOX	TCCE 6X35 SS
3	FUS00000291	1	SEMIMOZZO VNS/20 FEMMINA CON FERODO	HALF HUB VNS/20 FEMALE WITH LINING
3c	TCC00000142	9	TCCE 6X30 INOX	TCCE 6X30 SS
4	COP00000043	1	COPERCHIO GIALLO VNS"Fieni"	YELLOW "Fieni" VNSFAN COVER
4c	ANE00000063	1	ANELLO 79X71X0,6	79X71X0,6 RING
5	FRI00000017	1	FRIZIONE VNSx3 CG	VNSx3 CG CLUTCH
5c	ORM00000001	2	OR 800-20	OR 800-20
6c	OR00000062	1	OR 3850	OR 3850
7c	PAR00000025	2	PARAOLIO 50X72X8 SC	50X72X8 SEAL