

CROPLANDS PART NUMBERS: MAX08-1 – MAX 8M BOOM (BARE)

WHERE USED: MAX08, LA700/80/8M, LA700/80/8ML, LA1000/80/8M, LA1000/80/8ML

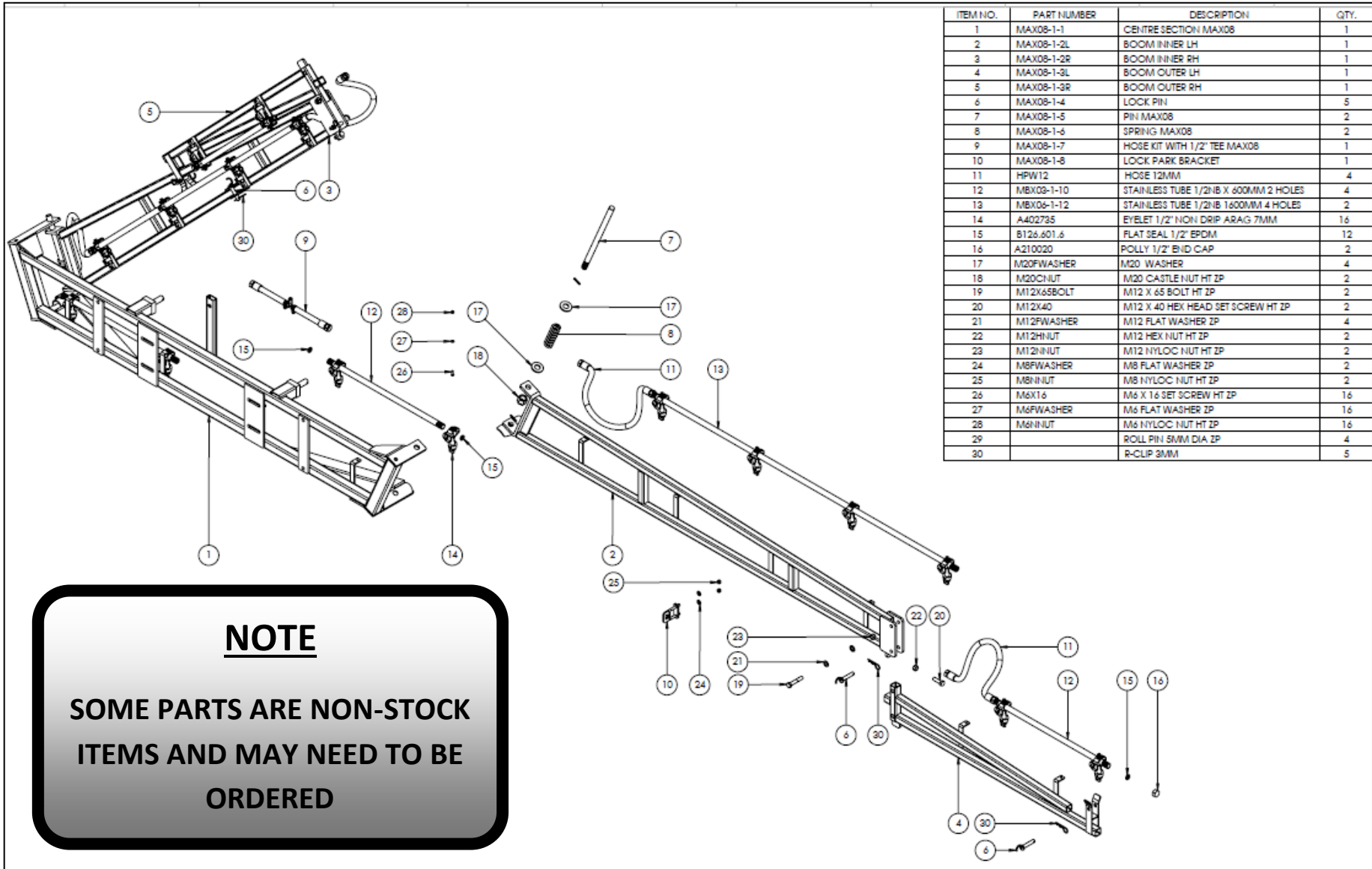

ITEM NO.	PART NUMBER	DESCRIPTION	QTY.
1	MAX08-1-1	CENTRE SECTION MAX08	1
2	MAX08-1-2L	BOOM INNER LH	1
3	MAX08-1-2R	BOOM INNER RH	1
4	MAX08-1-3L	BOOM OUTER LH	1
5	MAX08-1-3R	BOOM OUTER RH	1
6	MAX08-1-4	LOCK PIN	5
7	MAX08-1-5	PIN MAX08	2
8	MAX08-1-6	SPRING MAX08	2
9	MAX08-1-7	HOSE KIT WITH 1/2" TEE MAX08	1
10	MAX08-1-8	LOCK PARK BRACKET	1
11	HPW12	HOSE 12MM	4
12	MBX08-1-10	STAINLESS TUBE 1/2"NB X 600MM 2 HOLES	4
13	MBX08-1-12	STAINLESS TUBE 1/2"NB 1600MM 4 HOLES	2
14	A402735	EYELET 1/2" NON DRIP ARAG 7MM	16
15	B126.601.6	FLAT SEAL 1/2" EPDM	12
16	A210020	POLLY 1/2" BHD CAP	2
17	M20FWASHER	M20 WASHER	4
18	M20CNUT	M20 CASTLE NUT HT ZP	2
19	M12X6SBOLT	M12 X 6S BOLT HT ZP	2
20	M12X40	M12 X 40 HEX HEAD SET SCREW HT ZP	2
21	M12FWASHER	M12 FLAT WASHER ZP	4
22	M12HNUT	M12 HEX NUT HT ZP	2
23	M12HNUT	M12 NYLOC NUT HT ZP	2
24	M8FWASHER	M8 FLAT WASHER ZP	2
25	M8HNUT	M8 NYLOC NUT HT ZP	2
26	M6X16	M6 X 16 SET SCREW HT ZP	16
27	M6FWASHER	M6 FLAT WASHER ZP	16
28	M6HNUT	M6 NYLOC NUT HT ZP	16
29		ROLL PIN 5MM DIA ZP	4
30		R-CLIP 3MM	5

NOTE

**SOME PARTS ARE NON-STOCK
ITEMS AND MAY NEED TO BE
ORDERED**