

**CROPLANDS**

OPERATORS MANUAL  
**CROPAIR**  
**300/600**

[WWW.CROPLANDS.COM.AU](http://WWW.CROPLANDS.COM.AU)



**STOP**

**BEFORE COMMENCING**  
operation, **ENSURE** you read  
& understand this manual, its  
contents, and any additional  
information supplied.



# INTRODUCTION

## GENERAL MANAGER'S WELCOME



**Sean Mulvaney**  
**General Manager**

Dear Customer

Congratulations on the purchase of your new sprayer and thank you for supporting another true blue Australasian manufacturer. For over 50 years Croplands have been delivering spraying solutions and ongoing support for a variety of applications whilst investing in long term partnerships with our suppliers, distributors, end users and local communities. These partnerships are absolutely key in our commitment to support our products into the future.

At Croplands, we are committed to sourcing the very best technology from around the globe and adapting these products to our specific requirements. When these products don't yet exist, we innovate through continuous investment in our own research and development.

Croplands is a wholly owned subsidiary of Nufarm Ltd, the largest supplier of crop protection products in Australasia. This brings a unique understanding and collaborative approach to new market developments, challenges and opportunities.

Please take the time to thoroughly read this manual before you operate your sprayer. This will provide direction to ensure safe usage and help optimise the performance of your investment. Your feedback is welcome and valued.

We trust you will be happy with your sprayer and the level of support - our goal is to be your preferred spraying solutions partner from this point onwards.

Yours Sincerely

**Sean Mulvaney**  
**General Manager**

Croplands has taken steps to ensure this operator's manual is as current and as accurate as possible. Due to the ever-changing markets of cropping and farming, Croplands is constantly striving to be at the forefront of innovation and technology. While the information in this manual is considered accurate at the time of writing, Croplands reserves the right to change this information without notice. Croplands will not accept liability for any inaccuracy in this publication, or changes forthwith.



# CONTENTS

## **SECTION 1** **IMPORTANT INFORMATION**

About this manual	4
Terminology	4
Before operating your sprayer	4
Warranty policy	5

## **SECTION 2** **SAFETY**

Safety first	6
Safety signs and decals	7

## **SECTION 3** **PRODUCT IDENTIFICATION, SHIPPING & SPECIFICATION**

Product identification	8
Shipping information	8
General specification	8
Dimensions HL300/600	9
Dimensions HL600/800	9

## **SECTION 4** **PRODUCT FEATURES / FAMILIARISATION**

Fieni "Airblast" fans	11
Fieni 616mm fan	12
Fieni 815mm fan	14
Chassis / Frame	16
Linkage connections	16
Pump & PTO	16
Tanks, lids, sight gauges, sump & drain	16
The main tanks feature ...	17
The flushing tanks ....	17
The hand-wash tanks ....	17

## **SECTION 5** **PRE-OPERATION**

Safety first	21
Hook up	21
Confirming sprayer functionality	23
Confirming fan functionality	24
Confirm spraying	25
Shut down	25
Adjusting fan blade angles	26
Using optional electric controller	27
Pre-operation checklist	28

## **SECTION 6** **SPRAY OPERATIONS**

Safety first	30
Filters	30
Filling the sprayer	31
Adding chemical to the spray tank	32
Calculate water & chemical quantities	33
Proceed to spray	33
Operating pointers	33
Tank and equipment cleaning	34
Unhitching the sprayer from the tractor	34

## **SECTION 7** **SPRAYING INFORMATION**

Spraywise	36
Calibration	36
Step 1 - ensure equipment is in good working order	36
Step 2 - determining the actual speed of travel	36
Step 3 - determine spraying volume required	37
Step 4 - determine sprayer configuration	37
Step 5 - determine the ideal spray pressure	37
Step 6A - select the correct hollow cone nozzles	38
Step 6B - select the correct disk and core nozzles	39
Step 7 - fit & test selected nozzles	40
Step 8 - calculate the actual application rate	40
Step 9 - if the tested rate is unsatisfactory	41
Step 10 - coverage assessment	42
Step 11 - add the correct amount of chemical to the tank	42
Step 12 - record all data for future reference	43
Calibration work sheet	44

## **SECTION 8** **LUBRICATION & MAINTENANCE**

Greasing & service procedures	49
Every 200 hours	49
Diaphragm pumps	50
Filters	51

## **SECTION 9** **TROUBLESHOOTING**

## **SECTION 10** **ASSEMBLY DRAWINGS, PARTS & SCHEMATICS**

# SECTION 1

## IMPORTANT INFORMATION

### ABOUT THIS MANUAL

This manual provides assembly, setting up, operating and maintenance instructions for the spray booms of the Croplands Optima boom range. All types of the Croplands Optima range of spray booms are in the Identification and/or in the Specification Chapter. Some model types also have different options available. Some features explained in this manual may not be applicable to your boom.

Please pass on this manual with the sprayer at the time of resale for usage by the new owner.

This manual, HT-OMCROPAIR-A, was first published in October 2021. FSC printing and nozzle information updated in October 2024.

**Check online** as there may be more recent revisions of this manual. [www.croplands.com.au](http://www.croplands.com.au)

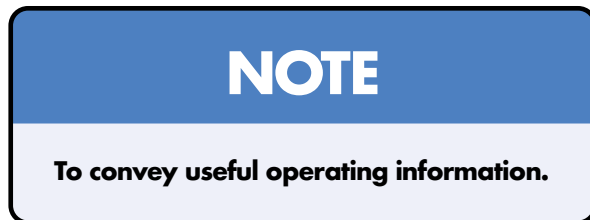

### TERMINOLOGY

These terms/symbols used throughout this manual:

<b>NOTE</b>	This Note sign is in place to convey useful information and will help you to identify the best possible way to operate the machine.
<b>CAUTION</b>	This Caution sign shows the potential for incident. An incident may include damage to the machine itself, or possible injury to the operator.
<b>WARNING</b>	This warning sign shows the potential for risk or injury and highlights the need for steps to be taken to protect ones safety.
<b>DANGER</b>	This Danger sign will be used in areas where the highest risk is present. Always read the information on these signs and ensure you are taking steps to prevent risk or injury.



### BEFORE OPERATING YOUR SPRAYER

Before attempting to use your sprayer, make sure you read all Operator Manuals for this sprayer including but not limited to:

This Operator's Manual, **and all other supplied manuals** for items such as Pumps, PTO etc.

And properly understand:

- All Safety Issues.
- Assembly & Installation instructions.
- Calibration of the sprayer.
- Sprayer Operation.
- Sprayer Maintenance.

### INTENDED USE

Croplands sprayers are designed to be used for multipurpose spraying of herbicides, pesticides and fertilisers. The sprayer must not be used for any other purpose.

# SECTION 1

## IMPORTANT INFORMATION

### WARRANTY POLICY

Each sprayer will be delivered with a Specifications, Safety, Warranty & Delivery Booklet which includes:

- the sprayer's specification sheet including the sprayer's unique serial number,
- a safety induction checklist,
- a delivery checklist and customer induction,
- the Croplands Warranty policy and warranty registration form.

Always contact your Croplands Dealer first and foremost for warranty matters.

### NOTE

For full conditions of warranty and warranty policy, please see the Specification, Safety, Warranty & Delivery booklet provided with this sprayer.

**CROPLANDS**

**SPRAYER SPECIFICATIONS  
SAFETY, WARRANTY & DELIVERY  
HORTICULTURE**

[WWW.CROPLANDS.COM.AU](http://WWW.CROPLANDS.COM.AU)

**STOP**  
BEFORE COMMENCING operation, **ENSURE** you read & understand this manual, its contents, and any additional information supplied.

GP-WARH-B

**INCLUDES SAFETY INDUCTION**

 CROPLANDS IS CONTRIBUTING TO A SUSTAINABLE FUTURE

# SECTION 2

## SAFETY

### SAFETY FIRST

Please refer to the Croplands 20 page Safety Manual, part number "GP-SAFE-A" which will be supplied with this product. If for any reason the Safety manual is not available, please see your dealer, Croplands Customer service or the Croplands Web Site to obtain a copy.

This product should not be operated before first reading and understanding the full safety manual.

Be especially vigilant of the PTO shaft and chemical spillage.

 <p><b>⚠ DANGER</b></p> <p><b>ENTANGLEMENT IN PTO SHAFT CAN SERIOUSLY INJURE OR KILL</b></p>	<ul style="list-style-type: none"><li>• DO NOT EXCEED PTO OPERATING SPEED OF 540 RPM.</li><li>• ENSURE ALL SAFETY GUARDS ARE IN PLACE.</li><li>• GREASE SLIDING SHAFTS OF PTO DAILY.</li><li>• EXCESSIVE VIBRATION MAY OCCUR IF USING PTO SPEEDS LESS THAN 350 RPM WHEN FILLING.</li></ul> <p>Croplands Equipment Pty Ltd 00-123</p>
---	--



# SECTION 2

## SAFETY

### SAFETY SIGNS AND DECALS

All signs and decals for sprayer safety and operation must be maintained in good order and replaced if damaged or missing. Most Croplands labels have a part number printed on the decal to aid identification and replacement.

Some examples are shown below.

**WARNING**

**SAFETY INSTRUCTIONS**

1. Read your operator's manual thoroughly before operating the sprayer.
2. Inspect hoses, connections and nozzles daily.
3. Clean filters regularly.
4. Always follow correct maintenance schedules outlined in operator's manuals.
5. Always read chemical manufacturers labels before use.
6. Always observe all warnings on chemical products.
7. Regularly check all nuts and bolts are tight.
8. Always wear appropriate gloves and wash sprayer down before doing any repair or maintenance work.
9. Do not ride on sprayer when moving.
10. Keep clear of moving parts when sprayer is operating.
11. Always keep guards in place when sprayer is operating.
12. Be sure tank lid is closed before operating basket mixing facility.
13. Stand well clear of sprayer when operating.
14. Do not disconnect hoses, nozzles or filters while sprayer is operating.

**FAILURE TO FOLLOW THE ABOVE INSTRUCTIONS MAY RESULT IN SERIOUS INJURY OR DEATH.**

Part No: XD - 123V

**WARNING**

**OPERATION INSTRUCTIONS**

FOR SAFETY PROCEDURES READ THE OPERATORS MANUAL.

STOP THE ENGINE AND REMOVE THE IGNITION KEY BEFORE (AND AFTER) WORKING ON THE MACHINE.

DO NOT START THE MACHINE WITHOUT ENSURING ALL PEOPLE ARE WELL CLEAR OF WORKING PARTS. SOUND THE HORN BEFORE START UP

FAILURE TO OPERATE CORRECTLY MAY RESULT IN SERIOUS INJURY OR DEATH!

Part No: XD - 125V

**WARNING**

DO NOT FILL THE TANK IN EXCESS OF THE CARRYING CAPACITY OF THE VEHICLE WITH WHICH THE TANK WILL BE USED, AS SPECIFIED BY THE VEHICLE MANUFACTURER.

1 Litre of water = 1 Kg      50 Litres of water = 50 Kg

DO NOT EXCEED THE VEHICLE MANUFACTURERS SPECIFIED SAFE LOAD CARRYING AND TOWING CAPACITIES.

READ THE OPERATORS INSTRUCTION MANUAL AND CHECK UNLADEN WEIGHT BEFORE ATTACHING OR USING THIS PRODUCT.

Part No: XD - 126V

**CAUTION**

WATER FOR OPERATOR WASHING ONLY

DO NOT DRINK

Part No: XD - 124V

**WARNING**

BEWARE OF MOVING PARTS.

Failure to operate correctly may result in serious injury or death!

**CROPLANDS**

Part No: XD-182

**WARNING**

ENSURE ALL WHEEL NUTS ARE TIGHT BEFORE USE.

Failure to do so may result in a serious accident.

**CROPLANDS**

Part No: XD-175

**DANGER**

ENTANGLEMENT IN PTO SHAFT CAN SERIOUSLY INJURE OR KILL

- DO NOT EXCEED PTO OPERATING SPEED OF 540 RPM.
- ENSURE ALL SAFETY GUARDS ARE IN PLACE.
- GREASE SLIDING SHAFTS OF PTO DAILY.
- EXCESSIVE VIBRATION MAY OCCUR IF USING PTO SPEEDS LESS THAN 350 RPM WHEN FILLING.

Croplands Equipment Pty Ltd

Part No: XD-122V

**DANGER**

KEEP BODY PARTS AND LOOSE OBJECTS AWAY FROM ROTATING FAN

Failure to do so may result in serious injury.

Croplands Equipment Pty Ltd

Part No: XD - 195

# SECTION 3

## PRODUCT IDENTIFICATION, SHIPPING & GENERAL SPECIFICATION

Machine specifications are subject to change without prior notification.

### PRODUCT IDENTIFICATION

Always use the serial number of the Sprayer when requesting service information or when ordering parts.

Early or later models (identification made by serial number) may use different parts, or it may be necessary to use a different procedure for specific service operations.

The serial numbers of all controllers, pumps, etc should also be recorded for future reference.



### SHIPPING INFORMATION

All provided tie-down points (and more) should be used to help secure the sprayer for transporting.

#### Weights

HL300/600	=	210 kg empty
	=	540 kg full / overflow
HL600/800	=	tba

### GENERAL SPECIFICATION

The Croplands Cropair sprayers featuring Fieni Airblast fans, are available in 2 standard configurations to give the maximum possible spray coverage.

#### HL300/600

300L tank and frame, fitted with an ARVDR50 Controller as standard, AR503-APC high-pressure pump direct coupled to the fan, Fieni 620mm fan with 9 blades, single-speed gearbox, 3 angled options for pitch, requires 30hp, max spray width of 12m and 5.5m high. 5 nozzle spray rings either side. Nozzles to be selected at the time of ordering, either ATI's or Disc and Cores.

#### HL600/800

600L tank and frame, fitted with ARVDR50 Controller as standard, AR503-APC high-pressure pump direct coupled to the fan, Fieni 815mm fan with 9 blades, dual-speed

gearbox, 3 angled options for pitch, requires 45hp, max spray width of 14m and 6m high. 7 nozzle spray rings either side. Nozzles to be selected at the time of ordering, either ATI's or Disc and Cores.

### Tractor requirements

Power required at the PTO on flat terrain:

HL300/600	35 ~ 45 HP
HL600/800	50 ~ 60 HP

Category 2 or 3 linkage connections required.



# SECTION 3

## PRODUCT IDENTIFICATION, SHIPPING & SPECIFICATION

Machine specifications are subject to change without prior notification.

### DIMENSIONS HL300/600

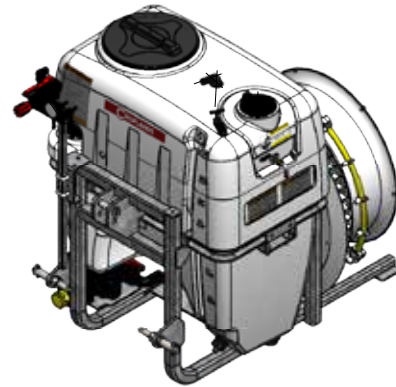
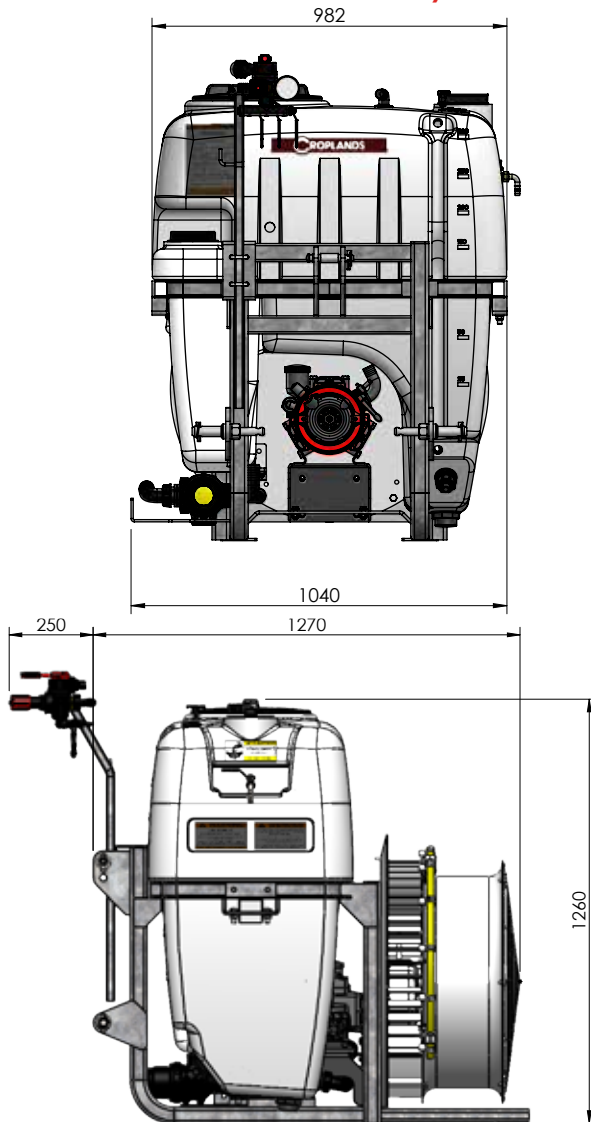

### DIMENSIONS HL600/800

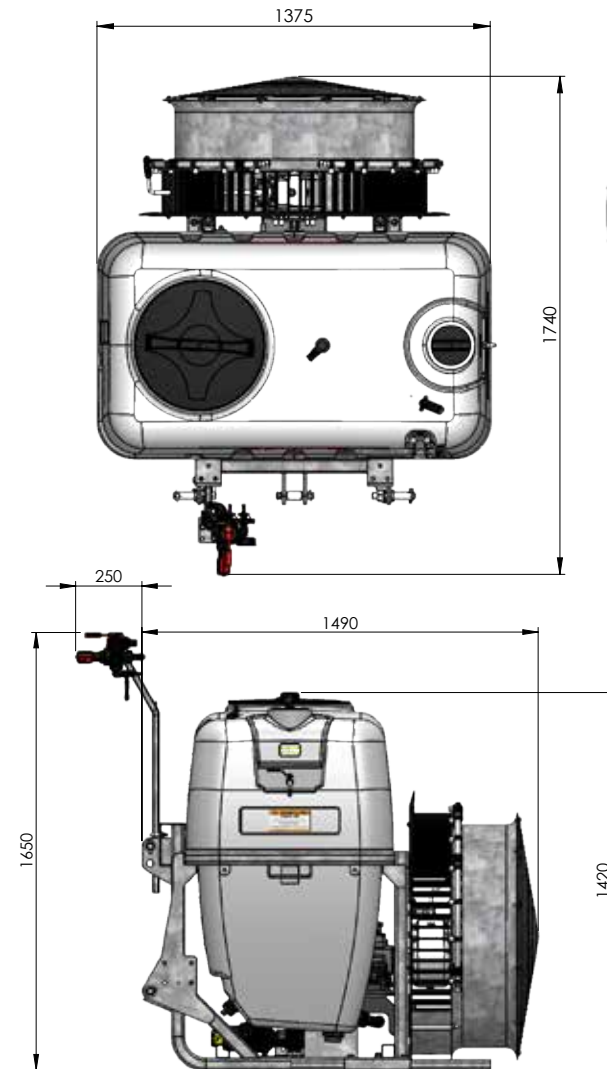

# SECTION 4

## PRODUCT FEATURES / FAMILIARISATION

Machine specifications are subject to change without prior notification.

<b>FIENI "AIRBLAST" FANS</b>	<b>11</b>
<b>FIENI 616 MM FAN</b>	<b>12</b>
<b>FIENI 815MM FAN</b>	<b>14</b>
<b>CHASSIS/FRAME</b>	<b>16</b>
<b>LINKAGE CONNECTIONS</b>	<b>16</b>
<b>PUMP &amp; PTO</b>	<b>16</b>
<b>TANKS, LIDS, SIGHT GAUGES, SUMP &amp; DRAIN</b>	<b>16</b>
<b>THE MAIN TANKS FEATURE ...</b>	<b>17</b>
<b>THE FLUSHING TANKS ....</b>	<b>17</b>
<b>THE HAND-WASH TANKS ....</b>	<b>17</b>

# SECTION 4

## PRODUCT FEATURES / FAMILIARISATION

Machine specifications are subject to change without prior notification.



### FIENI "AIRBLAST" FANS

#### HIGH PERFORMANCE "AIRBLAST" FANS

The Croplands, Cropair air-blast fans are engineered by Fieni, a global leader in agricultural fan design, manufacturing and innovation.

Croplands and Fieni have been collaborating since 1972, and together we set the standard for fan sprayer performance, efficiency, penetration and coverage.

#### Maximum PTO Speed

Maximum PTO speed is 540 rpm.

Check the tractor PTO RPM before operating the sprayer. More RPM at the PTO can cause damage to the sprayer unit and can be dangerous for the operator.

#### Fan Pitch

All Cropair Fieni fans have multiple pitch settings and are normally supplied in the middle position.

To maximise performance, the blade pitch can be adjusted to match the tractor's capability / chosen operating parameters such as PTO rpm.

Refer to pages 12, 14 & 26 for more information of changing pitch angles.

#### Fan Balance

The fan has been supplied balanced. Swapping blades and hub components around risks upsetting the balance. Do not operate with damaged fan blades.

If replacing a damaged blade, it's necessary to balance the fan.

#### Fan Safety Rules

##### Fan Guards

The sprayer unit is supplied complete with safety guards for both incoming and outlet air. The assembled guards need to prevent foreign bodies hitting the fan.

**NEVER** operate the sprayer without these guards in place.

From time to time the incoming air guard may become clogged with leaves etc. Always disengage the fan before removing clogged leaves etc from the guards.

The fan runs at high speed and are capable of ingesting loose objects or clothing or ejecting objects that have been ingested at high speed.

- DO NOT exceed maximum operating rpm (PTO = 540 rpm)
- STAY AWAY from the fan when the tractor is running.
- DO NOT stay in the working area (air inlet or spray outlet) of the sprayer unit.
- Always stay at a safe distance from the machine when it is working/running.

**DO NOT remove or modify the installed protections and guards**

# SECTION 4

## PRODUCT FEATURES / FAMILIARISATION

Machine specifications are subject to change without prior notification.

### FIENI "AIRBLAST" SPRAY FANS

#### Fieni 616 mm Fan

The 300 Litre sprayer uses a Fieni VPL series, 9-bladed, 616 mm diameter, pitch adjustable blades driven via the single speed V1N gearbox. Running counter clockwise. No clutch.

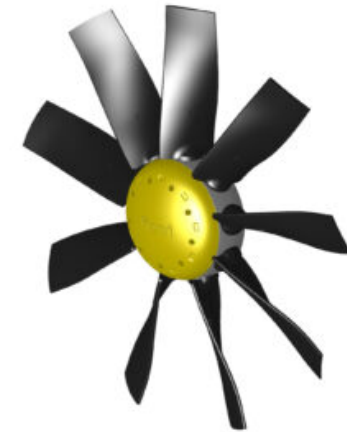
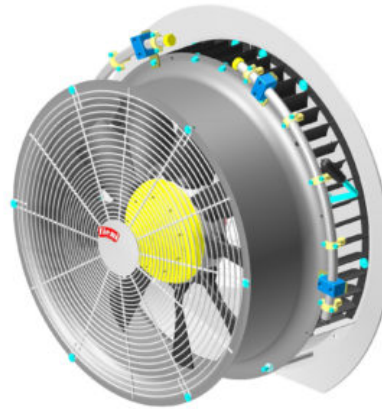

<p><b>Distribution</b></p> <p>Y: 5.5 m Z: 12 m</p>	<p><b>Capacity</b></p> <p>≥ 400 Lt</p>	<p><b>Tractor</b></p> <p>≥ 600 Lt</p>
<p><b>Nozzle Holder</b></p> <p>5+5</p>	<p><b>Tractor</b></p> <p>≥ 30 HP</p>	<p><b>Other</b></p> <p><b>Noise @ 7,5 m</b> 94.6 db</p> <p><b>Weight</b> 55 kg</p>

The pitch adjustable fan can be set to the following blade angles ...

Blade inclination angle	Volume	Power
26° min	17,878 m <sup>3</sup> /h	9.8 HP
34° medium	22,015 m <sup>3</sup> /h	13.3 HP
42° max	26,200 m <sup>3</sup> /h	15.2 HP

From the factory, the fans are always assembled and tested in the middle pitch setting.

# SECTION 4

## PRODUCT FEATURES / FAMILIARISATION

Machine specifications are subject to change without prior notification.

The 616mm fan is driven via the Fieni V1N single speed (plus neutral) gearbox, using a 1: 7.36 ratio, with no clutch.

The gearbox lever is used to select run (engaged gear) or neutral. Every unit is fitted with a gearbox information decal.

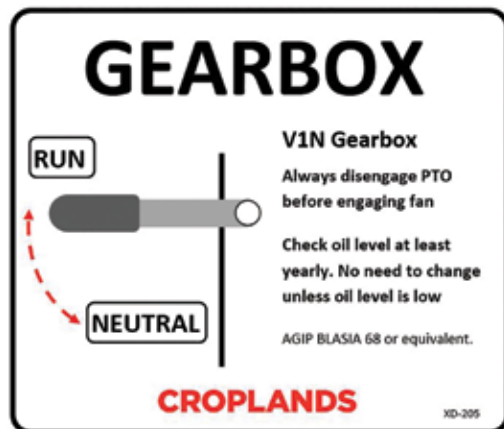

The 616mm fan uses 2 x nozzle rails (one left and one right) with 5 on/off roll-over nozzles per rail.

Maximum total of 10 nozzles.

Image below shows the 5 nozzles and the gearbox selection lever on the right-hand side.



Brass roll-over nozzle bodies are fitted as standard with Albus ceramic disc and cores on one side and Albus ATI-80 degree hollow cone (Green 015) nozzles on the other side. Off is shown below in the horizontal position. (photo's show yellow ATR nozzles).



Nozzles to be selected at the time of ordering.

Refer to Croplands Buyers Guide for more information on nozzles and nozzle choices.

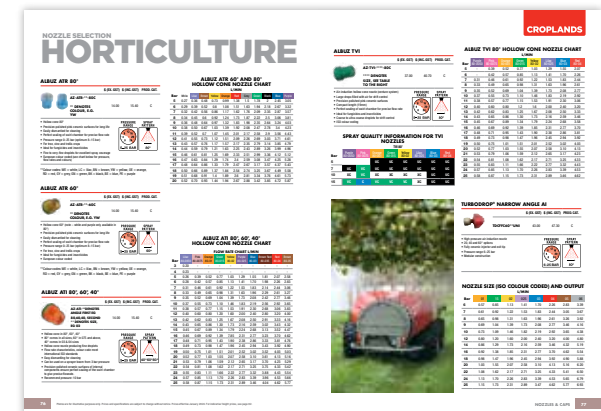

# SECTION 4

## PRODUCT FEATURES / FAMILIARISATION

Machine specifications are subject to change without prior notification.

### Fieni 815mm Fan

The 600 Litre sprayer uses a Fieni VPL series, 9-bladed, 815 mm diameter, pitch adjustable blades driven via the dual speed V2C-A gearbox. Running counter clockwise. No clutch.

The pitch adjustable fan can be set to the following blade angles ....

From the factory, the fans are always assembled and tested in the middle pitch setting.

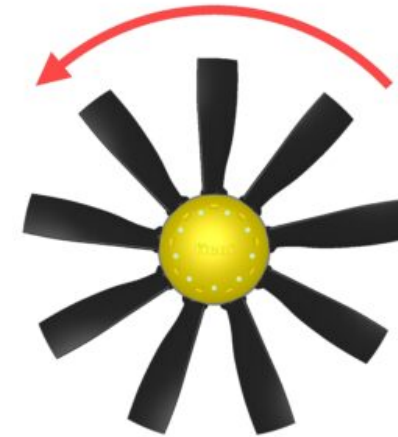

The pitch adjustable fan can be set to the following blade angles ...

Blade inclination angle	Volume	Power
34° min	31,948 m <sup>3</sup> /h	17.5 HP
42° medium	36,800 m <sup>3</sup> /h	27.0 HP
50° max	39,200 m <sup>3</sup> /h	35.4 HP

From the factory, the fans are always assembled and tested in the middle pitch setting.

<p><b>Distribution</b></p> <p>Y: 6 m Z: 14 m</p>	<p><b>Capacity</b></p> <p>≥ 800 Lt</p>	<p><b>Tractor</b></p> <p>≥ 1000 Lt</p>
<p><b>Nozzle Holder</b></p> <p>7+7</p>	<p><b>Tractor</b></p> <p>≥ 45 HP</p>	<p><b>Other</b></p> <p><b>Noise @ 7,5 m</b> 99.5 db</p> <p><b>Weight</b> 85 kg</p>

# SECTION 4

## PRODUCT FEATURES / FAMILIARISATION

Machine specifications are subject to change without prior notification.

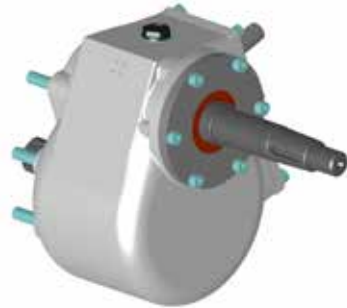

The 815 mm fan is driven via the Fieni V2C-A two single speed (plus neutral) gearbox, with no clutch.

The gearbox lever is used to select run (engage low or high gears) or neutral. Every unit is fitted with a gearbox information decal.

Gearbox specifications are:

- PTO** 540 rpm
- Power** 45 HP
- Weight** 5 kg
- Ratio 1** 1:3.50
- Ratio 2** 1:4.00

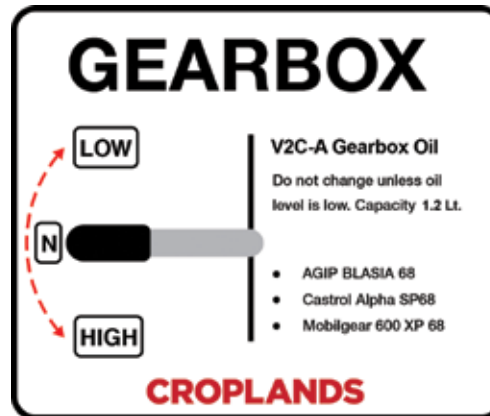

The 815mm fan uses 2 x nozzle rails (left and right) with 7 on/off roll-over nozzles per rail. Maximum total of 14 nozzles.

The nozzle bodies are the twin roll-over type enabling one of 2 nozzles to be selected (pictured below are single ATR's nozzles installed), or an off position as shown below in the horizontal position.

The default "Standard" fitment is Albus ceramic disc and cores (AD4 / AC56) on one side and Albus ATI-80 degree hollow cone (Green 015) nozzles on the other side.

Alternative nozzles can be selected at the time of ordering.

Nozzles to be selected at the time of ordering, either ATR's or Disc and Cores.

Refer to Croplands Buyers Guide for more information on nozzles and nozzle choices.

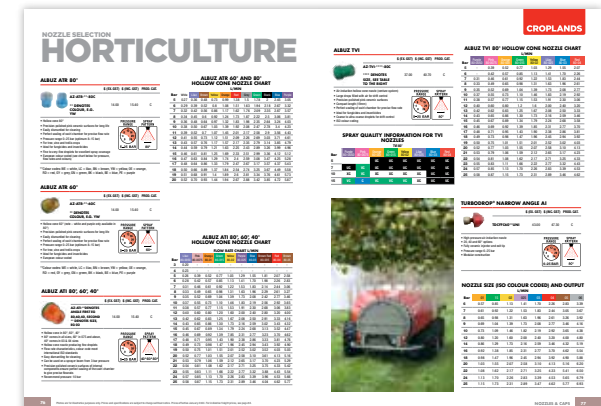

# SECTION 4

## PRODUCT FEATURES / FAMILIARISATION

Machine specifications are subject to change without prior notification.

### CHASSIS / FRAME

Heavy-duty, hot-dipped galvanised frame.

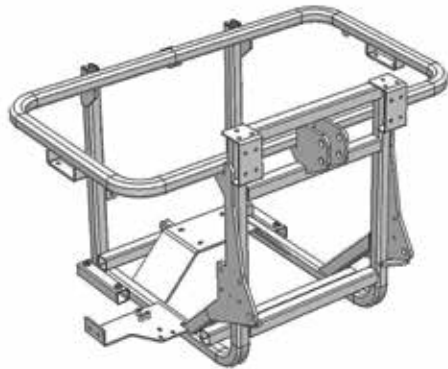

The 600 Lt frame has an optional slide out rear parking legs.



### LINKAGE CONNECTIONS

3-point hitch to suit Categories I and II tractor linkage connections.

Both models have Cat II for the lower linkage arms, and Cat I for the top link with a sleeve if your tractor has Cat II.



### PUMP & PTO

All models are fitted with an Annovi Reverberi AR503-APC high pressure, positive displacement triple diaphragm pump with a capacity of 54 L/min.

Pump directly (through) coupled to the fan's gearbox.

A PTO shaft is supplied to drive the pump.

A separate pump manual is supplied with every unit.

### TANKS, LIDS, SIGHT GAUGES, SUMP & DRAIN

The HL300/600 uses a 300 Litre Main tank, 40 Litre Flushing tank, and a 10 Litre Hand wash tank.



The HL600/800 uses a 600 Litre Main tank, 80 Litre Flushing tank, and a 15 Litre Hand wash tank.

All tanks are constructed of natural / translucent impact-resistant, UV stabilised polyethylene.



# SECTION 4

## PRODUCT FEATURES / FAMILIARISATION

Machine specifications are subject to change without prior notification.

### THE MAIN TANKS FEATURE ...

- A large lid with a mixing basket. Fill is via the lid / basket only.



- Calibrated sight tube, with coloured float for level indication.



- A Pull Drain Valve is positioned at the base of the sump (blue arrow) for simple, fast and complete drainage.

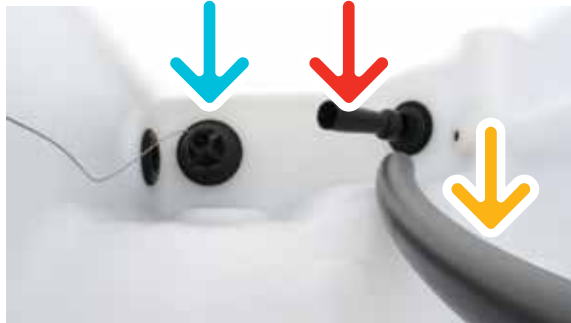

### THE FLUSHING TANKS ....

are accessed on the right-hand side of the sprayer. For use with freshwater only. Fill via the lid.



### THE HAND-WASH TANKS ....

Dovetail into the main tank on the left-hand side of the sprayer. For use with freshwater only. Fill via the lid.

It's suggested to always keep some water in these tanks to prevent them from bouncing out in transit.



# SECTION 4

## PRODUCT FEATURES / FAMILIARISATION

Machine specifications are subject to change without prior notification.

### Agitation

The agitation system is driven by the pump via single venturi tank agitator (red arrow on previous page) which can be turned on or off at the control manifold (refer to photo below), plus bypass agitation (yellow arrow on previous page) which is active at all times the pump is operating.



Shown in the off position

### Filtration

- Lid-strainers / chemical mixing baskets are standard on all models. Refer to previous page.
- Large suction filter, featuring a shut-off valve which enables the filter to be cleaned even with a full tank (refer to red valve release knob in photos below).

Equipped with a 50 mesh filter screen.



### Controls

- Tank selection ball valve (select Main or Flushing tanks).



- AR VDR50 2 way controller.

The controller features a very simple on / off lever combined with pressure adjustment knob and pressure gauge. Bypass line plumbed to tank for agitation.



# SECTION 4

## PRODUCT FEATURES / FAMILIARISATION

Machine specifications are subject to change without prior notification.

Pressure is adjusted by rotating the central red knob. Rotate clockwise to increase pressure.

Normal operating pressures are 8 ~ 15 bar.

Maximum recommended pressure is 20 bar.



3 individual outputs with shut-off taps for left spray ring, right spray ring and agitation.

Shown below with master switch on (far left) and all taps on (far right). No pressure shown as the pump is not running.



### Factory fitted options

- I-S4021, electric in-cab controller with switch box. 2-section high-pressure electric valves for individual left/right shutoff, electric pressure regulating valve and a master on/off can all be operated from the switch box in the cab. Requires a reliable 12V power supply.

Comes with an 8-page manual.



- The 600 Lt Frame has optional Slide-out feet for extra stability when parked on the ground.



- The 600 Lt Frame has an optional Fold down step for access to the lid or



**Sprayer specifications are subject to change without prior notification**

# **SECTION 5**

## **PRE-OPERATION**

<b>SAFETY FIRST</b>	<b>21</b>
<b>HOOK UP</b>	<b>21</b>
<b>CONFIRMING SPRAYER FUNCTIONALITY</b>	<b>23</b>
<b>CONFIRMING FAN FUNCTIONALITY</b>	<b>24</b>
<b>CONFIRM SPRAYING</b>	<b>25</b>
<b>SHUT DOWN</b>	<b>24</b>
<b>ADJUSTING FAN BLADE ANGLES</b>	<b>26</b>
<b>USING OPTIONAL ELECTRIC CONTROLLER</b>	<b>27</b>
<b>PRE-OPERATION CHECKLIST</b>	<b>28</b>

# SECTION 5

## PRE-OPERATION

From arrival on farm, hook up and prepare the sprayer for operation.

### SAFETY FIRST

Before progressing further,

- Read and understand the Safety Manual (part no. GP-SAFE-A) supplied with this sprayer.
- Read and understand this manual to better familiarise yourself with the sprayer.
- Ensure the tractor to be used to tow this sprayer is suitable to handle the loads. If in doubt consult the tractor dealer/manual.

### HOOK UP

The Cropair Sprayer has been fully tested before leaving the Croplands factory. Some components will require further assembly after shipping from the factory/dealer;

1. Adjust and fit the 3-point linkage to the tractor
2. Connect the PTO shaft to the tractor
3. Fit the controller (if applicable).

Always park the sprayer in a horizontal position and on firm, level ground.

### Connecting to the tractor

Croplands Cropair sprayers suit Categories I and II tractor linkage connections.

300 & 600 litre models have Cat II for the lower linkage arms, and Cat I for the top link with a sleeve if your tractor has Cat II.

### Linkage connection

Lower the tractor linkage arms and attach the sprayer's lower hitch pins, using the suitable category for your setup. Fit the locking pin clips.

Lift the tractor linkage up to the level you wish to spray at. Now you can adjust the length of the top linkage arm to level the sprayer.

**WARNING**

**Always ensure the tractor PTO is disengaged before attempting to hook up the PTO shaft!**

### PTO shaft connection

Clean off and grease the PTO splines on the sprayer and tractor stub shafts. Put the PTO shaft onto both splines making sure the spring-loaded locking pins click into place and is completely secure on the splines.

Attach the PTO shaft safety chains (attached on the PTO guards) to the tractor & the pump PTO guard.

Raise and lower the sprayer to check that the tubes of the PTO overlap by at least 1/3 of their length, and not less than 150mm, in all operating positions.

**NOTE**

**Your Croplands sprayer dealer is responsible for correctly setting and installing the supplied PTO shaft for the first time it is set up. This can involve cutting the shaft to length to ensure correct, safe operation.**

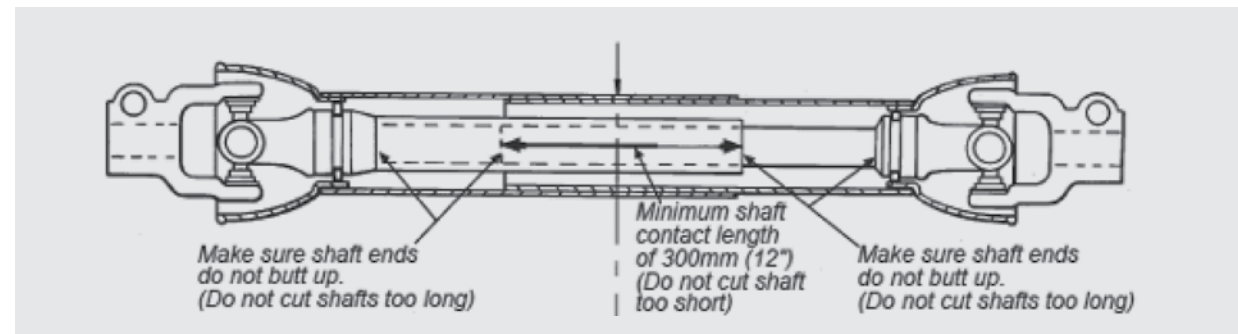

# SECTION 5

## PRE-OPERATION

### PTO Shaft – for new fitting

A new standard-length PTO shaft is supplied with the sprayer. In most cases, this will require cutting to a shorter length specific to the tractor & sprayer dimensions.

Follow the instructions below to fit the PTO shaft onto the sprayer after transit. For new installations, the dealer will oversee the fitting of the new shaft.

Also, refer to the PTO user manual that is supplied with every new PTO shaft.

- Remove the PTO shaft which is usually delivered strapped to the sprayer's frame. Check the PTO shaft has not been damaged in transit.
- Grease the universal joints, telescoping shafts & safety cover bushes.
- Measure and fit the PTO to the sprayer ensuring the locking pin is correctly located.

Cutting the PTO shaft to length requires knowledge of this procedure. If you have not carried out this procedure before, ensure your dealer carries out this important step.

- Before operating the drive shaft, be sure that all safety guards are in place & safety chains are securely fitted (refer to PTO Manual).
- Do not exceed the maximum RPM of the pump or gearbox (540 RPM).

### Manual Controller

The standard manual controller has been fitted and adjusted at the factory. It is fully self-contained on the sprayer and requires no further hookup.

### Electric Controller (optional)

The controller has been fitted and adjusted at the factory but has been disconnected and packed for transit.

Follow the controller's manual for instructions on connecting to a suitable (tractor) power source.

Find a suitable position on the tractor / within the cab for the control switchbox.



### Nozzles

Check and / or fit the chosen nozzles to the unit.

For more information on nozzle availability, check out the Croplands Buyers Guide nozzle section or the Nufarm SprayWise Hort book (also refer to Section 7 of this manual)

NOZZLE SELECTION									
DISCS & CORES									
NOZZLES - DISCS AND CORES									
NOZZLE	TYPE AND DESCRIPTION	SAMPLE ORDER CODE	TYPE	SIZE RANGE, MATERIAL	Ø (EX. GST)	Ø (INC. GST)	PROD. CAT.		
AD1	AC3 Disc and Core Jets: • Full and hollow cone spray patterns • Medium to fine droplets for use in air assisted situations • 5-20 bar recommended range	AZ-ADA	Disc	• 1 to 7 • Pink ceramic	3.00	3.30	C		
AD3	AC13	AZ-ACS	Core	• 13 to 25 • Pink ceramic	11.00	12.10	C		

DISC AND CORE ALBUZ CERAMIC - FLOW RATES											
DISC SIZE	CORE SIZE	Ø (MM)	L/HM					ARLLES			
			3 BAR	4 BAR	5 BAR	6 BAR	10 BAR	15 BAR	20 BAR	10 BAR	20 BAR
AD1	AC3	0.8	0.24	0.27	0.3	0.33	0.41	0.49	0.56	70°	70°
AD2	AC13	1.60	0.31	0.35	0.39	0.42	0.53	0.64	0.75	87°	87°
AD3	AC13	1.2	0.36	0.41	0.45	0.49	0.61	0.74	0.84	89°	88°
AD4	AC13	1.56	0.45	0.52	0.57	0.62	0.78	0.93	1.06	99°	100°
AD5	AC13	2	0.55	0.62	0.69	0.75	0.94	1.12	1.29	102°	100°
AD1	AC23	0.8	0.28	0.32	0.35	0.38	0.48	0.57	0.65	66°	74°
AD2	AC23	1.60	0.37	0.43	0.47	0.51	0.64	0.77	0.88	83°	90°
AD3	AC23	1.2	0.44	0.51	0.56	0.61	0.76	0.92	1.04	84°	90°
AD4	AC23	1.56	0.56	0.64	0.71	0.77	0.97	1.16	1.32	92°	98°
AD5	AC23	2	0.72	0.82	0.91	0.99	1.24	1.49	1.7	98°	99°
AD6	AC23	2.4	0.85	0.97	1.07	1.16	1.46	1.75	2	99°	101°
AD1	AC25	0.8	0.41	0.46	0.51	0.55	0.7	0.84	0.95	50°	60°
AD2	AC25	1.60	0.59	0.67	0.74	0.8	1.01	1.21	1.38	67°	80°
AD3	AC25	1.2	0.72	0.81	0.9	0.98	1.23	1.48	1.68	63°	80°
AD4	AC25	1.56	1.02	1.16	1.28	1.39	1.75	2.1	2.39	75°	80°
AD5	AC25	2	1.41	1.6	1.77	1.92	2.42	2.9	3.3	77°	80°
AD6	AC25	2.4	1.73	1.97	2.18	2.37	2.98	3.57	4.07	82°	83°
AD7	AC25	2.8	2.07	2.36	2.61	2.83	3.57	4.28	4.87	88°	91°
AD1	AC45	0.8	0.48	0.55	0.61	0.66	0.83	1	1.14	32°	39°
AD2	AC45	1.60	0.73	0.83	0.92	1	1.26	1.51	1.72	46°	53°
AD3	AC45	1.2	0.89	1.05	1.16	1.26	1.58	1.91	2.16	49°	52°
AD4	AC45	1.56	1.35	1.54	1.7	1.85	2.32	2.79	3.17	59°	60°
AD5	AC45	2	1.92	2.19	2.42	2.63	3.31	3.97	4.52	68°	70°
AD6	AC45	2.4	2.46	2.79	3.09	3.35	4.22	5.07	5.77	72°	73°
AD7	AC45	2.8	3.01	3.43	3.79	4.11	5.18	6.21	7.07	79°	80°
AD1	AC48	0.8	0.55	0.62	0.69	0.75	0.94	1.12	1.29	32°	37°
AD2	AC48	1.60	0.92	1.05	1.16	1.26	1.58	1.9	2.16	28°	30°
AD3	AC48	1.2	1.2	1.37	1.51	1.64	2.08	2.46	2.82	30°	30°
AD4	AC48	1.56	2.03	2.32	2.58	2.79	3.5	4.2	4.9	39°	39°
AD5	AC48	2	3.11	3.54	3.91	4.24	5.34	6.41	7.3	40°	42°
AD6	AC48	2.4	4.02	4.59	5.16	5.62	7.08	8.48	9.67	45°	46°
AD7	AC48	2.8	5.49	6.45	7.42	7.84	9.82	11.8	13.63	44.5°	47°
AD1	AC31	0.8	0.53	0.61	0.67	0.73	0.92	1.1	1.25	39°	39°
AD2	AC31	1.60	0.82	0.93	1.03	1.12	1.41	1.69	1.95	47°	50°
AD3	AC31	1.2	0.87	0.98	1.1	1.19	1.5	1.81	2.09	45°	47°
AD1	AC35	0.8	0.53	0.61	0.67	0.73	0.92	1.1	1.25	34°	40°
AD2	AC35	1.60	0.92	1.05	1.16	1.26	1.58	1.9	2.16	39°	39°
AD3	AC35	1.2	1.28	1.46	1.61	1.75	2.24	2.64	3	44°	42°
AD4	AC35	1.56	2.08	2.37	2.62	2.84	3.58	4.3	4.89	77°	72°
AD5	AC35	2	2.62	2.98	3.3	3.58	4.51	5.41	6.16	59°	54°
AD2	AC56	1.60	0.88	1	1.11	1.2	1.52	1.82	2.07	27°	29°
AD3	AC56	1.2	1.19	1.36	1.5	1.63	2.05	2.46	2.8	28°	32°
AD4	AC56	1.56	2.05	2.33	2.58	2.8	3.52	4.23	4.81	39°	38°
AD5	AC56	2	3.46	3.94	4.38	4.73	5.96	7.13	8.14	43°	40°
AD6	AC56	2.4	5.11	5.82	6.43	6.98	8.78	10.54	12	56°	49°
AD7	AC56	2.8	6.87	7.81	8.64	9.38	11.8	14.17	16.12	68°	64°

# SECTION 5

## PRE-OPERATION

### CONFIRMING SPRAYER FUNCTIONALITY

After the sprayer is hooked up correctly to the tractor, it's advised that a freshwater test be done to check for leaks and to familiarise the operator(s) with the sprayer.

These checks have been conducted in the factory prior to shipping, however, there is a chance that transit could have loosened some fittings.

Running the machine with fresh water is a good safe way to calibrate, learn about the sprayer and set the sprayer to maximise results in the field.

1. Check that nothing is loose or damaged
2. Check all fittings are tight
3. Check pump oil levels (refer to pump manual for more detail)
4. Check PTO and fan guards are in place
5. Add some fresh water to all the tanks, with at least 100 litres in the main tank



6. Select the water source from MAIN tank.
7. Make sure the Fan (gearbox) is in the neutral position (refer to page 13 & 15).
8. Ensure all spray function controls are in the off position and with a low-pressure setting. Whilst the pressure has been set at the factory (normally 5 ~ 6 turns open), there is no guarantee it hasn't been altered. To be safe, turn the pressure knob out 1/2 of a turn.



9. Power up the tractor (brakes on) and engage the PTO - no need for full power at this stage, set to say 350rpm.



At this stage the pump will be drawing from the main tank and bypassing the pressure regulator / controller straight back to the tank via the return hose (yellow arrow).



10. To activate the spray controls, turn on the pressure manifold (main side lever down).

Adjust the red knob to change the pressure. The photo shows 8 bar which is ideal for start-up testing. Maximum = 20 bar.



# SECTION 5

## PRE-OPERATION

11. Cycle through all 3 taps for Left and Right Spray Rings plus the Agitator. All are shown below in the ON position. Check that all functions are operating correctly.



12. With all taps on, set the PTO speed to the intended operational speed (usually between 450 ~ 540 rpm) and adjust (red knob) the spray pressure to the intended spray pressure.

### NOTE

It's useful to find the lowest rpm at which the PTO can operate and still deliver the chosen spray volume and pressure. Note that below this point there will not be any bypass flow back to the tank to aid with tank agitation. If the PTO speed is significantly above the minimum required there will be a risk of tank chemical foaming from excessive agitation.

Repeat the process while drawing fresh water from the Flushing tank.



Note this test should not be done with a full main tank as it can overflow the main tank.

After shutdown, check & clean the filter (refer to page 18).



### CONFIRMING FAN FUNCTIONALITY

The maximum allowed PTO speed is 540 rpm

**DO NOT** engage or disengage the fan's gearbox whilst the PTO is engaged.

Always disengage the PTO before changing gear (Neutral or Run).

1. Check that nothing is loose or damaged
2. Check all fittings are tight
3. Check the gearbox oil level before starting



4. Check PTO and Fan guards are in place.
5. Engage the fan gearbox to "RUN".

### NOTE

Whenever the fan is being run "dry", it's best to have fresh water running through the pump – with the pressure controller in the OFF position allowing water to bypass back to the tank.



# SECTION 5

## PRE-OPERATION

6. For the initial start-up use low tractor rpm and engage the PTO. Don't "drop the clutch".
7. Check and confirm the fan is running correctly, and only then, gradually increase rpm until the maximum of 540 PTO rpm is achieved.

Check for full range of functionality through the PTO / rpm range.

### CONFIRM SPRAYING

Having previously confirmed the functionality of the pressure / spray manifold / controller, now is the time to run with all systems on.

- With the fan running, set the PTO to the intended operational speed.
- Turn on the controller and both spray rings. Confirm or adjust the pressure as required.
- Confirm everything is working correctly.



Note; the additional load of the fan running will require a different power setting from the tractor compared to the spray functionality testing.

**Confirm the overall spray effectiveness** for the intended purpose as the best results may require a fan blade angle adjustment.

Spraying should be done in consultation with the spray manager / agronomist / someone skilled in the art of spraying. The best setup might vary significantly from crop to crop, season to season, etc.

### SHUT DOWN

Use the reverse order to shut down.

- Reduce engine power / slow PTO speed
- Turn off spray rings
- Turn off controller
- Disengage PTO
- Disengage fan gearbox (optional)
- Drain the main tank
- To avoid algae build up in the freshwater tanks, it is recommended these also be drained and refilled just prior to the next spraying job.

The unit is now ready to go spraying - refer to Section 6.



# SECTION 5

## PRE-OPERATION

### ADJUSTING FAN BLADE ANGLES

#### FAN ADJUSTMENTS

The Fieni fans have 3-position, pitch (angle) adjustable blades. For example, the 600mm fan offers the below pitch angle settings.

Croplands Cropair units are assembled, tested, and delivered in the medium blade angle setting.

Blade inclination angle	Volume	Power
26° Min	17,878 m <sup>3</sup> /h	9.8 HP
34° Medium	22,015 m <sup>3</sup> /h	13.3 HP
42° Max	26,200 m <sup>3</sup> /h	15.2 HP

A steeper blade angle will deliver a faster more penetrating air stream (compared to a lower pitch angle) at the same rpm, but it will require more power to do. Any change of blade angle needs to consider tractor capabilities.

### FAN PITCH ANGLE

All Cropair Fieni fans have multiple pitch settings and are normally supplied in the middle position.

To maximise performance, the blade pitch can be adjusted to match the tractor's capability / chosen operating parameters such as PTO rpm.

To increase the blade angle will increase air (spray) velocity and penetration, increase noise and increase tractor power requirements.

The reverse is true for reducing pitch angles.

Adjusting the pitch angles can be done on the sprayer.

- Disconnect the PTO drive.
- Remove the safety fan guard.
- Remove the hub cover.
- Loosen the fan hub bolts.
- It's now possible to move the blades. All blades need to be set to the same pitch angle.
- Re-tighten the fan hub bolts. Makes sure the hub is snugly fitting back together - if not, it's a sign that one or more of the fan blade splines are not correctly fitted.
- Re-attach the hub cover, and safety guards.

The fan has been supplied "balanced. Swapping blades and hub components around risks upsetting the balance.

Do not operate with damaged fan blades.

If replacing a damaged blade, it's necessary to balance the fan.

Replacing blades will require full disassembly.

Refer to Section 10, page 57, for Fieni Fan Assembly Instructions.

# SECTION 5

## PRE-OPERATION

### USING OPTIONAL ELECTRIC CONTROLLER

For sprayers fitted with the optional Braglia I-S4021 electric (in-cab) controller / pressure manifold. The controller comes with a separate instruction manual.

The photo below shows the controller (installed on a 1,000 Lt trailed sprayer).



Connect the supplied control / switch to the tractor and sprayer ...

1. Connect to a suitable (tractor) power source
2. Connect to the controller manifold loom

Take care to route the wiring looms away from PTO shafts, linkage arms etc.



The control box unit has switch functions for ...

1. 3 position master on / off / off switch
2. 2 x section control on / off switches
3. pressure control toggle switch.

### Set-up

Before start-up make sure all switches are in the off position. Engage PTO at low speed.



The master switch has 2 off positions.

The fully down OFF position (shown above) will draw power (light is on). The bypass (dump) valve is open and there will be no pressure.

The middle OFF position will draw no power, the pressure relief valve is active. With the PTO running, the pressure will show on the gauge.



Adjust the pressure via the toggle switch on the right-hand side of the control box.

The up position is ON. To activate spraying, flick either or both spray section switches to ON. Adjust the pressure to suit.

Always finish with the master switch in the middle position (to avoid a flat battery).

# SECTION 5

## PRE-OPERATION

### PRE-OPERATION CHECKLIST

Before operating the sprayer, please check the following items.

	All chemical & safety guides have been read, understood and acted upon.
	Operator is familiar with all control functions.
	Secure sprayer connected to the tractor.
	PTO connected, and safety guards correctly installed.
	Spray controller correctly connected and operational.
	Check pump(s) oil levels.
	

	Confirm the spray pump operation.
	Manual pressure regulator is set.
	Check for wear and tear on all chemical and hydraulic hoses and wiring looms.
	Ensure all filters are clean.
	

	Be safety aware as some spillage is likely.
	Check that nothing is loose or damaged.
	Check the alignment of all fan nozzles.
	Check that all tanks and spray lines are clean and empty, and the drain tap is closed.
	

# **SECTION 6**

## **SPRAY OPERATIONS**

<b>SAFETY FIRST</b>	<b>30</b>
<b>FILTERS</b>	<b>30</b>
<b>FILLING THE SPRAYER</b>	<b>31</b>
<b>ADDING CHEMICAL TO THE SPRAY TANK</b>	<b>32</b>
<b>CALCULATE WATER &amp; CHEMICAL QUANTITIES</b>	<b>33</b>
<b>PROCEED TO SPRAY</b>	<b>33</b>
<b>OPERATING POINTERS</b>	<b>33</b>
<b>TANK AND EQUIPMENT CLEANING</b>	<b>34</b>
<b>UNHITCHING THE SPRAYER FROM THE TRACTOR</b>	<b>34</b>

# SECTION 6

## SPRAY OPERATIONS

The pre-operation and familiarisation tasks must be completed before commencing spray-operations.

### SAFETY FIRST

Before progressing further,

- Read and understand the Safety Manual (part no. GP-SAFE-A) supplied with this sprayer.
- Read and understand this manual to better understand the sprayer.

### FILTERS

Filters will ensure that no solids enter the system to block or damage the pump or spray nozzles.

- Always ensure the basket filter is in place when filling the main tank.
- All filters should be cleaned regularly, or after each spraying period. Wear protective clothing.
- If the filter screen is damaged, replace it with a new screen.

#### Cleaning the suction filter

The suction filter should be cleaned regularly or after each spray tank has been emptied.

To clean the filter:

- Always wear gloves
- Completely stop all sprayer functions.

- Place the Tank Selection valve in FLUSHING position to isolate chemical liquid from the main tank.



- Some spillage is likely, therefore perform this operation in an appropriate place, and with safety clothing.
- Unscrew the isolation valve from the end of the filter bowl.



- Remove the outer filter screw and bowl, and then remove the filter and thoroughly clean it.
- Check the condition of the O-Ring before reassembling the filter.
- Remember to turn the ball valve back to MAIN when finished.

#### Cleaning the Pressure Filter

The pressure filter (if fitted) should be cleaned regularly or after each spray tank has been emptied.



To clean the pressure line filter:

- **Always wear gloves.** Some spillage is possible, therefore perform this operation in an appropriate place, and with safety clothing.
- Completely stop all sprayer functions.
- Remove the outer filter bowl, remove the filter, and thoroughly clean before re-assembly.

# SECTION 6

## SPRAY OPERATIONS

### FILLING THE SPRAYER

Use freshwater (preferably rainwater), free of suspended organic matter or clay as some chemicals are de-activated when they contact these materials. Ensure sufficient water quantity to allow correct product blending.

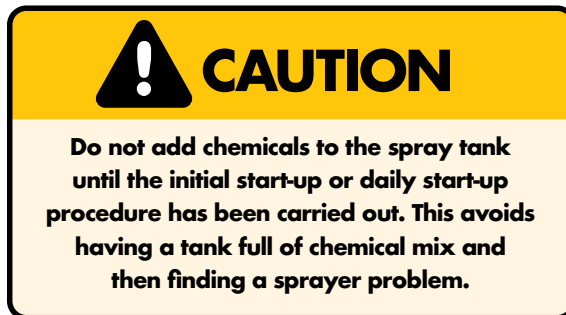

### Main Tank

When filling the main tank (freshwater only), open the spray tank lid and fill the tank with the basket filter in place.

Refer to next page re adding chemical to the tank

Clean the basket and replace the lid after filling.



### Flushing Tank

Use FRESH WATER ONLY (preferably rainwater) in the flushing tank.



Unscrew the lid and fill the tank before spraying. Replace the lid after filling.



Always maintain the correct caution label at the fill point.

### Hand-wash Tank

Fill the hand-wash tank with FRESH WATER ONLY from a source remote to any chemical source.

Replace the lid after filling.

Always maintain the correct caution label at the fill point.



# SECTION 6

## SPRAY OPERATIONS

### ADDING CHEMICAL TO THE SPRAY TANK

The steps for adding chemicals to the tank are:

#### Step 1: Calculate the Amount of Chemical Required (Also refer to next Section)

To add the correct amount of chemical to a tank, it is necessary to calculate the amount of chemical required.

The method of calculating the amount of chemical required for the sprayer tank is dependent on the chemical rate recommendations. Use the information supplied on the chemical label to determine the tank mix concentration.

If you are unsure of the mix required, ALWAYS check with a qualified advisor or the supplier of the chemical you intend to use.

### NOTE

**IMPORTANT! Be sure to mix only enough spray mixture to cover the area required. Avoid wastage and problems of needless chemical disposal.**

#### Step 2: Part Fill the Spray Tank with Water

Partly fill the sprayer tank with clean water.

Use freshwater (preferably rainwater), free of suspended organic matter or clay. Some chemicals are deactivated when they contact these materials. Ensure water quantity is sufficient to allow correct product blending.

#### Step 3: Measure & Pre-Mix the Chemical

Read and follow the instructions on the chemical manufacturer's label before mixing & adding chemicals to the spray tank.

Chemicals should be accurately measured and thoroughly premixed in a separate container before adding to the spray tank:

- Measure out the required liquid chemical in a graduated measuring cylinder or bucket.
- Add chemical to a small volume of water in a container and thoroughly mix the chemical

### CAUTION

**Always follow chemical label safety instructions. When handling chemicals always wear protective clothing ie. gloves, face mask, spray suit. Should chemical come in contact with skin immediately rinse off with water.**

#### Step 4: Add the Chemical to the Tank



Always make sure the filling basket is in place when adding water or chemical to the tank.

To add the premixed chemical to the tank:

- Add the pre-mixed chemical to the tank, thoroughly rinsing the chemical pre-mix container and adding the rinse to the tank.

- Top up the tank with water to the required volume.
- Close the tank lid securely.

### CAUTION

**Should chemical come in contact with skin immediately rinse off with water. Always follow chemical label safety instructions.**

#### Tank Agitation

When chemical is added to the tank, the pump and agitator(s) must be operating at all times to ensure chemical does not settle in the tank.

Check to see that tank agitation is correctly adjusted. If agitation causes too much foaming in the tank, partly close the agitator tap to reduce foaming.

If the chemical settles, through a pump break down or another reason, start up the sprayer after the fault has been rectified and let the mixture in the tank agitate for a length of time to ensure thorough mixing of the chemical.



# SECTION 6

## SPRAY OPERATIONS

### CALCULATE WATER & CHEMICAL QUANTITIES

Before spraying it is necessary to calculate the exact quantities of water and chemical needed to spray the required area of orchard or vines.

A. For **CHEMICAL required**, expressed in litres or kg per hectare (land area), use the following formula:

$$\begin{aligned} \text{Chemicals required (Litres)} = \\ \frac{\text{Tank Volume (L)} \times \text{Recommended Chemical Rate (L/ha)}}{\div \text{Spray Application Rate (L/ha)}} \\ \text{eg. } 600 \times 5 \div 400 = 7.5 \text{ litres} \end{aligned}$$

B. For tank **VOLUME OF MIXTURE required** to spray the selected area, use the following formula:

$$\begin{aligned} \text{Tank Volume Required (Litres)} = \\ \frac{\text{Area (ha)} \times \text{Spray Application Rate (L/ha)}}{\div \text{Spray Application Rate (L/ha)}} \\ \text{eg. } 1.5 \times 400 = 600 \text{ litres} \end{aligned}$$

C. For **AREA COVERED (ha)**,

$$\begin{aligned} \text{Tank Volume (L)} \div \\ \text{Spray Application Rate (L/ha)} \\ \text{eg. } 600 \div 400 = 1.5 \text{ ha} \end{aligned}$$

D. For **CHEMICAL RATES** expressed in Litres or kg per 100 litres of water (water volume), use the following formula:

$$\begin{aligned} \text{Chemicals Required (Litres)} = \\ \frac{\text{Tank Volume (Litres)} \times \text{Recommended Chemical Rate (L/100 litres)}}{\div 100} \\ \text{eg. } 600 \times 3 \div 100 = 18 \text{ litres} \end{aligned}$$

### NOTE

**IMPORTANT: Be sure to mix only enough spray mixture to cover the area required. Avoid wastage and problems of needless chemical disposal.**

### PROCEED TO SPRAY

Once the pre-operation checklist on page 28 has been completed, and chemical mixture is in the tank, proceed to spray:

- Anyone operating this sprayer must be conversant with the Croplands Safety manual.
- Spray operations should be done in conjunction with an agronomist / spray manager / someone skilled in the art of spraying and operating machinery. The spray manager will have predetermined the job requirements, such as ...

- The block to be sprayed, and any special instructions relevant to that site.
- Operating speed (often around 6 Kph)
- Application rate (for example 400 L / ha)
- The type and number of nozzles to be used (often the top nozzles are turned off)
- Spray pressure to be used (often around 10 ~ 12 bar). Above 20 bar is not recommended
- PTO and Spray pump speed (normally between 450 & 540 rpm).

### OPERATING POINTERS

- When preparing to spray in row for the first time, STOP, double-check that all tank lids are closed, and the Tank Selection Valve is in the MAIN tank / SPRAY position.
- When setting the pressure, it's important to make sure the pump is generating more pressure than required for just spraying to be assured there is enough pressure for bypass / agitation.
- Maintaining the nominated operating speed is important. If the nominated speed is 6 kph, a change to 4 or 8 kph will have a significant effect on the application rate.
- Always drive to the conditions taking into account the load, the terrain, and the weather.
- The fan air intake guards should be regularly checked and cleaned of leaves and similar debris. **ALWAYS disengage the fan when cleaning the guards.**

# SECTION 5

## PRE-OPERATION

### TANK AND EQUIPMENT CLEANING

If a cleaning agent is required (refer to the chemical label), as is often recommended when changing from one chemical group to another or as an end of season clean before storage.



Nufarm's Tank and Equipment Cleaner as pictured above is no longer available. Comparable cleaners are available from most good "spray shops".

Below is a generic guide procedure. Wherever possible follow the instructions provided with the cleaner used.

## NOTE

**Sulphur & Copper compounds lead to rapid deterioration of metal and polyethylene surfaces on your sprayer. It is strongly recommended that you use an exterior cleaner such as FARM MATE after every spray. FARM MATE is available from your Spray Shop**

1. First, completely drain the main tank of all liquid.
2. Fill the flush tank. Flush the spray system with water ... run the sprayer as per normal with the tank selection valve set to FLUSHING tank.
3. Fill the spray tank with freshwater
4. Add cleaning agent into the mixer basket (use according to instructions)
5. Open the Tank Selection Valve to the MAIN / spray tank.
  - Make sure the area around the fan is clear of bystanders.
  - Make sure the fan is downwind of the operator.
6. Start the tractor
7. Make sure the controller is NOT in spray mode.
8. Start the pump by engaging the Tractor PTO. Set to "normal" operating rpm
9. Turn ON the controller, both spray lines, and the agitator. There should also be some flow through the bypass line (i.e. don't use low PTO speed).
10. Adjust to normal operating pressures.
11. After sufficient flushing, turn OFF the spray sections.
12. If the cleaning agent is required to soak or stand for a period, turn OFF the spray lines and completely shut down the sprayer for the desired period.
13. On completion of flushing, shut down all controls and disengage the PTO/ hydraulic drive.
14. Open the pull drain valve and allow the cleaning mixture to drain from the tank
15. Delay the final flushing of the sprayer (again) with freshwater until just before the sprayer is next used – that might be in 1 hour or 6 months away if the sprayer is going into storage for the offseason.

### UNHITCHING THE SPRAYER FROM THE TRACTOR

Locate the sprayer on level ground and apply the brakes and / or block the wheels so that the Tractor does not roll when the sprayer is being disconnected.

Disconnect and stow the PTO shaft.

If fitted, disconnect the controller, power lead and signal loom. Cap the looms connections and stow the control box in a safe, dry place.

Slide out and lock the foot extensions. Detach the 3 linkage arms.

# **SECTION 7**

## **SPRAYING INFORMATION**

<b>SPRAYWISE</b>	<b>36</b>
<b>CALIBRATION</b>	<b>36</b>
<b>STEP 1 - ENSURE EQUIPMENT IS IN GOOD WORKING ORDER</b>	<b>36</b>
<b>STEP 2 - DETERMINING THE ACTUAL SPEED OF TRAVEL</b>	<b>36</b>
<b>STEP 3 - DETERMINE SPRAYING VOLUME REQUIRED</b>	<b>37</b>
<b>STEP 4 - DETERMINE SPRAYER CONFIGURATION</b>	<b>37</b>
<b>STEP 5 - DETERMINE THE IDEAL SPRAY PRESSURE</b>	<b>37</b>
<b>STEP 6A - SELECT THE CORRECT HOLLOW CONE NOZZLES</b>	<b>38</b>
<b>STEP 6B - SELECT THE CORRECT DISK AND CORE NOZZLES</b>	<b>39</b>
<b>STEP 7 - FIT &amp; TEST SELECTED NOZZLES</b>	<b>40</b>
<b>STEP 8 - CALCULATE THE ACTUAL APPLICATION RATE</b>	<b>40</b>
<b>STEP 9 - IF THE TESTED RATE IS UNSATISFACTORY</b>	<b>41</b>
<b>STEP 10 - COVERAGE ASSESSMENT</b>	<b>42</b>
<b>STEP 11 - ADD THE CORRECT AMOUNT OF CHEMICAL TO THE TANK</b>	<b>42</b>
<b>STEP 12 - RECORD ALL DATA FOR FUTURE REFERENCE</b>	<b>43</b>
<b>CALIBRATION WORK SHEET</b>	<b>44</b>

# SECTION 7

## SPRAYING INFORMATION

Spraying should be done in conjunction with an agronomist / spray manager / someone skilled in the art of spraying. The best setup might vary significantly from crop to crop, season to season etc.

### SPRAYWISE

It's highly recommended that all operators of this sprayer and spray program managers should be fully conversant with the information supplied in the **Nufarm SprayWise Horticultural Application Handbook** (refer photo) before undertaking spray operations.

The book includes chapters discussing re;

- Droplet Size
- Nozzle Types
- Dilute Spraying
- Concentrate Spraying
- Coverage & Assessment
- Selecting Nozzles
- Drift
- Weather
- Adjuvants
- Formulations & Mixing Order
- Cleaning
- Calibration
- Record Keeping
- And more

This book is supplied with every Sprayer, and is available from Croplands dealers, under the part number: SPRAYWISEHK.



### CALIBRATION

Applying the correct amount of chemical to a crop is only possible if **the sprayer is calibrated, operated and maintained correctly.**

The variables of spray application (distance, time, working width, liquid, and chemical volumes) must be measured and controlled accurately to ensure chemicals are applied at the correct rate.

Proper calibration involves setting up the sprayer (nozzle selection, pressure, speed), calculating chemical and water rates, and measuring the performance of the sprayer itself. Only then can you be totally confident in applying chemicals correctly.

### STEP 1 - ENSURE EQUIPMENT IS IN GOOD WORKING ORDER

Tank, pump, boom, filters and nozzles must be clean, free of leakages and functioning properly.

Follow the pre-operation checklist, maintenance and operating instructions in this manual.

### STEP 2 - DETERMINING THE ACTUAL SPEED OF TRAVEL

To manually check the speed...

- a) Half fill the sprayer tank with water and mark out a test strip of 100 metres (simulating spraying conditions).

# SECTION 7

## SPRAYING INFORMATION

- b) Set the sprayer operating and record the time taken to travel 100 metres at your required spraying speed.
- c) Calculate the actual speed of travel using the formula:

**For SPEED, km/hr** = using the following formula:

$$\frac{\text{Distance (m)} \times 3.6}{\text{Time (sec)}}$$

eg.  $\frac{100(\text{m}) \times 3.6 \div 48(\text{seconds})}{}$   
= 7.5km/hr travel speed

An alternative formula is:

$$\text{km/hr} = \text{Metres travelled in 1 minute} \div 16.7$$

### STEP 3 - DETERMINE SPRAYING VOLUME REQUIRED

It is essential to determine the liquid volume per hectare required to effectively spray a crop without overspraying or underspraying.

The spray volume requirement should be determined by / in conjunction with an agronomist / spray manager / someone skilled in the art of spraying.

The term "litres per hectare" must be related to foliage and not just to land area. The amount of liquid needed to effectively spray any given crop will vary greatly with:

- The type of crop
- Row spacing
- Width of canopy

- Height of canopy
- Stage of growth
- Density of foliage
- Type of leaf surface
- Type of fruit (single or bunched)
- Type of sprayer used
- For example, using a Cropair, spray volumes for grapes will typically vary from 300 to 600 L/Ha.

### STEP 4 - DETERMINE SPRAYER CONFIGURATION

Once the volume of required spray volume per hectare is established, the next step in setting up the sprayer is to determine:

- The **number of row(s)** to be sprayed in one pass, (always 1 row for a Cropair sprayer), and
- The **total number**, type and size of nozzles to be used on the sprayer. Can be a mixture.



Disk & core on the left, ATI hollow cone on the right

### Example A

The HL600/800 model uses 7 rollover nozzles per side for a total of 14 nozzles. In some applications several of these nozzles might be turned off or alternatively several of these nozzles might be fitted with a larger orifice in order to target a specific section of the canopy.

The rollover bodies are fitted from the factory with ATI hollow cone nozzles one side and with disk & core nozzles, at a different spray rate, to the other side.

### Example B

The HL300/600 model uses 5 rollover nozzles per side for a total of 10 nozzles. In some applications several of these nozzles might be turned off, or alternatively several of these nozzles might be fitted with a larger orifice in order to target a specific section of the canopy.

### STEP 5 - DETERMINE THE IDEAL SPRAY PRESSURE

Before determining the correct nozzles, it's best to have an idea of the spray pressure required. As a general rule, a pressure of 10 bar is considered ideal. Setting up the sprayer around a pressure of say 10 bar will allow lower pressures (say 8~10 bar) to be used in early season and higher pressure (say 10~12 bar) for later season without having to change nozzles midseason. It will also offer some margin around travelling slower or faster than the chosen speed.

The advice provided above is general information only and operators should seek specialised advice from their agronomist/spray manager/someone skilled in the art of spraying.

# SECTION 7

## SPRAYING INFORMATION

### STEP 6A - SELECT THE CORRECT HOLLOW CONE NOZZLES

Knowing actual travel speed, application rate required, number of rows to be sprayed in one pass (always one for a Cropair sprayer), total number of nozzles to be used and ideal spray pressure, we can determine the nozzles required for the sprayer.

The calculation formulation is;

#### Litres per minute per nozzle

$$= \text{Litres/Ha} \times \text{Km/hr} \div 600$$

$$\frac{\text{Total number of nozzles used} \times \text{row spacing (m)}}{\text{number of rows in one pass}}$$

Once the flow rate per nozzle is known select the most appropriate nozzle from a flow-rate chart.

### Croplands supplies and recommends the 80 degree ALBUZ ATI Hollow Cone nozzles.

The "Nozzle Selection Worksheet" program as pictured right, is freely available from the Croplands Web Site or Croplands Customer Service and makes it much quicker to calculate nozzle requirements.

For more nozzle options refer to the Croplands Compact buyers guide.

Also refer to Calibration worksheets, pages 44 ~ 45.

Once the flow rate per nozzle is known (via using the formula or the program), select the most appropriate nozzle(s) from the nozzle supplier's flow-rate chart. Albus ATi 80 degree nozzle chart is shown below.

Example A below, for a HL600/800 using 14 nozzles, with a target spray rate of 485 L/ha, in 2.7m rows, spraying at 7 kph shows a requirement of 1.09 L/min per nozzle which aligns nicely with the standard Green 015 nozzles at 10 Bar operating pressure. Total output = 15.28 L/min.

Example B shows a requirement for 0.72 L/min which correlates to using less than 5 Bar pressure (not ideal). Hence it's advisable to change to the Orange 01 nozzles which will be suitable at 10 Bar.

### CROPAIR Nozzle Selection Worksheet

Step 1: Enter data in grey boxes

**Example A**

Target rate (L/ha)  Speed (km/hr)

Row spacing (m)  Number of rows

Number of nozzles

Total L/min = **15.28** L/min per nozzle = **1.09**

Step 2: Select nozzles from chart - (closest match to L/min per nozzle)

### CROPAIR Nozzle Selection Worksheet

Step 1: Enter data in grey boxes

**Example B**

Target rate (L/ha)  Speed (km/hr)

Row spacing (m)  Number of rows

Number of nozzles

Total L/min = **7.20** L/min per nozzle = **0.72**

Step 2: Select nozzles from chart - (closest match to L/min per nozzle)

Colour	Part Number	5 Bar	6 Bar	7 Bar	8 Bar	9 Bar	10 Bar	11 Bar	12 Bar	13 Bar	14 Bar	15 Bar
LILAC	AZ-ATI-8005	0.26	0.28	0.31	0.33	0.35	0.37	0.38	0.40	0.42	0.43	0.45
PINK	AZ-ATI-80075	0.39	0.42	0.46	0.49	0.52	0.55	0.57	0.60	0.62	0.65	0.67
ORANGE	AZ-ATI-8001	0.52	0.57	0.61	0.65	0.69	0.73	0.77	0.80	0.83	0.86	0.89
GREEN	AZ-ATI-80015	0.77	0.85	0.92	0.98	1.04	1.10	1.15	1.20	1.25	1.30	1.34
YELLOW	AZ-ATI-8002	1.03	1.13	1.22	1.31	1.39	1.46	1.53	1.60	1.67	1.73	1.79
PURPLE	AZ-ATI-80025	1.29	1.41	1.53	1.63	1.73	1.83	1.91	2.00	2.08	2.16	2.24
BLUE	AZ-ATI-8003	1.55	1.7	1.83	1.96	2.08	2.19	2.3	2.40	2.50	2.59	2.68
BROWN RED	AZ-ATI-80035	1.81	1.98	2.14	2.29	2.42	2.56	2.68	2.80	2.91	3.02	3.13
RED	AZ-ATI-8004	2.07	2.26	2.44	2.61	2.77	2.92	3.06	3.20	3.33	3.46	3.58
BROWN	AZ-ATI-8005	2.58	2.83	3.06	3.27	3.46	3.65	3.83	4.00	4.16	4.32	4.47

# SECTION 7

## SPRAYING INFORMATION

### STEP 6B - SELECT THE CORRECT DISK AND CORE NOZZLES

Knowing actual travel speed, application rate required, number of rows to be sprayed in one pass (always one for a Cropair sprayer), total number of nozzles to be used and ideal spray pressure, we can determine the nozzles required for the sprayer.

The calculation formulation is;

#### Litres per minute per nozzle

$$= \frac{\text{Litres/Ha} \times \text{Km/hr} \div 600}{\text{Total number of nozzles used} \times \text{row spacing (m)} \times \text{number of rows in one pass}}$$

$$\frac{\text{Litres/Ha} \times \text{Km/hr} \div 600}{\text{Total number of nozzles used} \times \text{row spacing (m)} \times \text{number of rows in one pass}}$$

Once the flow rate per nozzle is known select the most appropriate nozzle from a flow-rate chart.

### Croplands supplies and recommends the ALBUZ ceramic Disc and Core nozzles.

The "Nozzle Selection Worksheet" program as pictured right, is freely available from the Croplands Web Site or Croplands Customer Service and makes it much quicker to calculate nozzle requirements.

For more nozzle options refer to the Croplands Compact buyers guide.

Also refer to Calibration worksheets, pages 46 ~ 47

Once the flow rate per nozzle is known (via using the formula or the program), select the most appropriate disc

and core set from the nozzle supplier's flow-rate chart.

Albuz ceramic full cone disc & core chart is shown below. Refer to previous page for Albuz ATi hollow cone nozzles.

Example C worksheet is for a HL600/800

- using 14 nozzles,
- with a target spray rate of 485 L/ha,
- in 2.7m rows,
- spraying at 7 kph

Shows a requirement of 1.5 L/min per nozzle which aligns nicely with disc AD3, core AC31 at 10 Bar.

### CROPLANDS

#### CROPAIR Nozzle Selection Worksheet

**Step 1: Enter data in grey boxes**

**Example C**

Target rate (L/ha)       Speed (km/hr)

Row spacing (m)       Number of rows

Number of nozzles

Total L/min = **15.00**      L/min per nozzle = **1.5**

**Step 2: Select nozzles from chart - (closest match to L/min per nozzle)**

### DISC AND CORE ALBUZ CERAMIC - FLOW RATES

	DISC SIZE	CORE SIZE	ORIFICES DIAMETER	L/MIN						ANGLES		
				3 BAR	4 BAR	5 BAR	6 BAR	10 BAR	15 BAR	20 BAR	10 BAR	20 BAR
	AD 1	AC 31	0,8	0,53	0,61	0,67	0,73	0,92	1,1	1,25	39°	39°
	AD 2	AC 31	1,02	0,82	0,93	1,03	1,12	1,41	1,69	1,92	87°	95°
	AD 3	AC 31	1,2	0,87	0,99	1,1	1,19	1,5	1,8	2,05	65°	62°
	AD 1	AC 35	0,8	0,53	0,61	0,67	0,73	0,92	1,1	1,25	34°	40°
	AD 2	AC 35	1,02	0,92	1,05	1,16	1,26	1,58	1,9	2,16	39°	39°
	AD 3	AC 35	1,2	1,28	1,46	1,61	1,75	2,2	2,64	3	44°	42°
	AD 4	AC 35	1,56	2,08	2,37	2,62	2,84	3,58	4,3	4,89	77°	72°
	AD 5	AC 35	2	2,62	2,98	3,3	3,58	4,51	5,41	6,16	37°	34°
FULL CORE	AD 2	AC 56	1,02	0,88	1	1,11	1,2	1,52	1,82	20,7	21°	20°
	AD 3	AC 56	1,2	1,19	1,36	1,5	1,63	2,05	2,46	2,8	28°	32°
	AD 4	AC 56	1,56	2,05	2,33	2,58	2,8	3,52	4,23	4,81	35°	38°
	AD 5	AC 56	2	3,46	3,94	4,36	4,73	5,96	7,15	8,14	43°	40°
	AD 6	AC 56	2,1	5,11	5,82	6,43	6,98	8,78	10,54	12	56°	49°
	AD 7	AC 56	2,3	6,87	7,81	8,64	9,38	11,8	14,17	16,12	68°	64°

# SECTION 7

## SPRAYING INFORMATION

### STEP 7 - FIT & TEST SELECTED NOZZLES

The most important calibration is to test for the actual litres per hectare achieved through your sprayer.

- Use the following method to fit and test the selected nozzles:
- Fit selected nozzles to the sprayer.
- Fill your spray tank to maximum capacity & set the specified pump pressure and operate the sprayer for a short period to make sure all lines are full and nozzles are working properly (no blockages, leaks etc).
- Stop the sprayer and top up the tank with water to the brim.
- Operate the sprayer in the stationary position at the required pressure for not less than one minute.
- Measure how much water is required to refill the tank to the brim.
- Now, divide the volume measured by the time taken (minutes). The longer the test time the more accurate the figure.

The calculation formulation is;

$$\text{Output (L/min)} = \frac{\text{Output (litres)}}{\text{Time (minutes)}}$$

### Example 1

$$\frac{23.3 \text{ litres, per...}}{1.5 \text{ minutes (90 seconds per run time)}} = 15.5 \text{ litres per minute}$$

Which is slightly more than the target rate of 15.28 L/min, (refer Example A page 37)

- Excessive output is a sign of worn nozzles. Refer to steps 8 & 9.
- Insufficient output is a sign of blockages. Refer to steps 8 & 9.



### STEP 8 - CALCULATE THE ACTUAL APPLICATION RATE

Actual application rate is the objective of setting up and calibrating your sprayer.

To calculate actual application rate (litres per hectare), use the following formula:

$$\text{Actual Application Rate (L/ha)} = \frac{\text{Tested total sprayer output (L/min)} \times 600 \div \text{speed (Km/hr)} \div \text{row spacing (m)}}{\div \text{number rows in one pass}}$$

#### Example 1 (as per example)

$$\frac{15.5 \text{ (L/min)} \times 600 \div 7 \text{ km/hr} \div 2.7 \text{ m (row spacing)}}{\div 1 \text{ (row/pass)}} = 492 \text{ litres/ha (target was 485)}$$

#### Example 2 (example from a Quantum Mist sprayer)

$$\frac{33.7 \text{ (L/min)} \times 600 \div 7.5 \text{ km/hr} \div 3 \text{ m (row spacing)}}{\div 2 \text{ (rows/pass)}} = 449 \text{ litres/ha}$$



# SECTION 7

## SPRAYING INFORMATION

### STEP 9 - IF THE TESTED RATE IS UNSATISFACTORY

If your tested application rate does not meet your requirements, your options are:

#### A) In Auto mode - if the application rate is not being achieved:

- Operating pressure will be excessive if nozzles are too small or blocked or speed is too fast. Likewise, if your pressure filter is blocked (even partially), you may experience excessive pressure at the pump. Make adjustments accordingly.
- Operating pressure will fall if nozzles are too large or speed is too slow. Make adjustments accordingly.

#### B) In Manual mode - the Controller application rate can be altered by:

- Adjusting pressure up or down to increase or decrease rate of application (use +/- keys).
- Adjusting spraying speed up or down to decrease or increase rate of application.
- Changing to a different nozzle capacity.

Repeat necessary testing procedures and calculation of application rate if adjustments or changes are made.

### LITRES PER 100 METRES / ROW

Many Auto Rate controllers have an option for Litres per 100 metres and is occasionally the unit of preference in some vineyard operations. It's a simpler formula as row width is not relevant.

The calculation requires volume and distance, such as 11 litres per 100 metres (of rows). The operator only needs to follow the chemical label rate for mixing concentrate per 100 L.

Using Example A from page 38, the rate would be around 13.0 L/100m row.

Litres / Hectare conversion to Litres/100m																					
Table unit = L/100 m																					
Row Spacing (metres)																					
	2.0	2.1	2.2	2.3	2.4	2.5	2.6	2.7	2.8	2.9	3	3.1	3.2	3.3	3.4	3.5	3.6	3.7	3.8	3.9	4.00
250	5.0	5.3	5.5	5.8	6.0	6.3	6.5	6.8	7.0	7.3	7.5	7.8	8.0	8.3	8.5	8.8	9.0	9.3	9.5	9.8	10.0
300	6.0	6.3	6.6	6.9	7.2	7.5	7.8	8.1	8.4	8.7	9.0	9.3	9.6	9.9	10.2	10.5	10.8	11.1	11.4	11.7	12.0
350	7.0	7.4	7.7	8.1	8.4	8.8	9.1	9.5	9.8	10.2	10.5	10.9	11.2	11.6	11.9	12.3	12.6	13.0	13.3	13.7	14.0
400	8.0	8.4	8.8	9.2	9.6	10.0	10.4	10.8	11.2	11.6	12.0	12.4	12.8	13.2	13.6	14.0	14.4	14.8	15.2	15.6	16.0
450	9.0	9.5	9.9	10.4	10.8	11.3	11.7	12.2	12.6	13.1	13.5	14.0	14.4	14.9	15.3	15.8	16.2	16.7	17.1	17.6	18.0
500	10.0	10.5	11.0	11.5	12.0	12.5	13.0	13.5	14.0	14.5	15.0	15.5	16.0	16.5	17.0	17.5	18.0	18.5	19.0	19.5	20.0
550	11.0	11.6	12.1	12.7	13.2	13.8	14.3	14.9	15.4	16.0	16.5	17.1	17.6	18.2	18.7	19.3	19.8	20	21	21	22
600	12.0	12.6	13.2	13.8	14.4	15.0	15.6	16.2	16.8	17.4	18.0	18.6	19.2	19.8	20	21	22	22	23	23	24
650	13.0	13.7	14.3	15.0	15.6	16.3	16.9	17.6	18.2	18.9	19.5	20	21	21	22	23	23	24	25	25	26
700	14.0	14.7	15.4	16.1	16.8	17.5	18.2	18.9	19.6	20	21	22	22	23	24	25	25	26	27	27	28
750	15.0	15.8	16.5	17.3	18.0	18.8	19.5	20	21	22	23	23	24	25	26	26	27	28	29	29	30
800	16.0	16.8	17.6	18.4	19.2	20	21	22	22	23	24	25	26	26	27	28	29	30	30	31	32
850	17.0	17.9	18.7	19.6	20	21	22	23	24	25	26	26	27	28	29	30	31	31	32	33	34
900	18.0	18.9	19.8	21	22	23	23	24	25	26	27	28	29	30	31	32	32	33	34	35	36
950	19.0	20	21	22	23	24	25	26	27	28	29	29	30	31	32	33	34	35	36	37	38
1000	20	21	22	23	24	25	26	27	28	29	30	31	32	33	34	35	36	37	38	39	40
1100	22	23	24	25	26	28	29	30	31	32	33	34	35	36	37	39	40	41	42	43	44
1200	24	25	26	28	29	30	31	32	34	35	36	37	38	40	41	42	43	44	46	47	48
1300	26	27	29	30	31	33	34	35	36	38	39	40	42	43	44	46	47	48	49	51	52
1400	28	29	31	32	34	35	36	38	39	41	42	43	45	46	48	49	50	52	53	55	56
1500	30	32	33	35	36	38	39	41	42	44	45	47	48	50	51	53	54	56	57	59	60

# SECTION 7

## SPRAYING INFORMATION

### STEP 10 - COVERAGE ASSESSMENT

Operate your sprayer in the required orchard or vineyard to check the actual spray coverage achieved on foliage.

This is important because it is the only real measure you have of actual coverage and effective penetration of your sprayer.

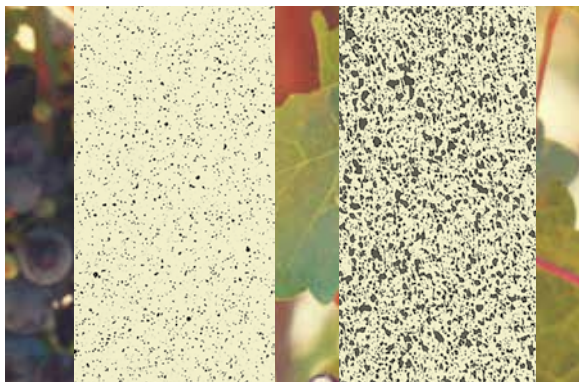

Coverage checks can be done using:

- Water Sensitive Papers (as pictured) and available through Croplands dealers – refer to Croplands Optima Buyers guide for further details.
- Clay Markers as available through Croplands dealers – refer to Croplands Optima Buyers guide for further details.
- Fluorescent Dye system as available through Croplands dealers – refer to Croplands Optima Buyers guide for further details.

It is recommended to test the unit using water only as a test run, and again when applying your chemical mixture.

Ensure water sensitive papers are strategically placed on both upper and lower surfaces.

Spray testing, evaluation and adjustment to the sprayer (say fan positions) or spray settings (say nozzles, pressures and rates) should be done in conjunction with an agronomist / spray manager / someone skilled in the art of spraying. The best setup might vary significantly from crop to crop, season to season etc.

### STEP 11 - ADD THE CORRECT AMOUNT OF CHEMICAL TO THE TANK

#### For land area rates (Litres or kg per hectare)

Use the following formula:

$$\text{Chemical required (Litres) =} \\ \frac{\text{Tank volume (Litres) x} \\ \text{recommended chemical rate (L/ha)}}{\div \text{spray application rate (L/ha)}}$$

For example;

$$\frac{2000 \text{ (litre tank) x } 2.0 \text{ (chemical rate L/ha)}}{\div 50 \text{ (spray application rate L/ha)}} \\ = 80 \text{ litres of chemical}$$

#### If chemical recommendation is given in water volume rates

Use the following formula:

$$\text{Chemical required (Litres) =} \\ \frac{\text{Tank volume (Litres) x} \\ \text{recommended chemical rate (L/100 litres)}}{\div 100}$$

For example;

$$\frac{2000 \text{ (litre tank) x } 4 \text{ (chemical rate L/100 litres)}}{\div 100} = 80 \text{ litres of chemical}$$

#### For tank volume required,

Use the following formula:

$$\text{Tank volume required (Litres) =} \\ \text{Area (ha) x spray application rate (L/ha)}$$

For example;

$$20 \text{ (hectares) x } 50 \text{ (application rate, L/ha)} \\ = 1000 \text{ litres of spray tank capacity required}$$

# SECTION 7

## SPRAYING INFORMATION

### STEP 12 - RECORD ALL DATA FOR FUTURE REFERENCE

Record all your calibration data on the work sheets given at the end of this section.

Photocopy the work sheets to obtain the number of work sheets required.



### ALBUZ DISC AND CORE CERAMIC NOZZLES

#### Specific characteristics

- ALBUZ durable pink ceramic construction allows high spraying pressures to be used while maintaining performance and precision.
- Usable range = 5~20 Bar
- The combinations of Discs (AD) and Cores (AC) allow a wide choice of uses
- **Recommended pressure: 10 bar**

#### Applications:

- For fungicides, herbicides and insecticides
- Recommended for orchards and vineyards.

### ALBUZ ATI HOLLOW CONE NOZZLES

#### Specific characteristics

- Flow rate characteristics, colour code meet international ISO standards
- Easy dismantling for cleaning
- The angle of 80 degrees may be matched with TVI 80° nozzles in order to optimise applications
- Can be used on a sprayer from 3 bar pressure
- Precision polished ceramic surfaces of internal components ensure perfect sealing of the swirl chamber to give precise flowrate
- **Recommended pressure: 10bar**

#### Applications:

- For fungicides and insecticides
- Recommended for orchards and vineyards.



# SECTION 7

## SPRAYING INFORMATION

### CALIBRATION WORK SHEET

## CROPAIR with Albus ATI Nozzles

#### Step 1

Check the Sprayer is in Good Working Order

#### Step 2

##### Determine Actual Speed of Travel

Measure and mark a straight path of 100 metres (or more) of travelling conditions similar to the orchard or vine yard you are going to spray.

Half fill the spray tank & record the time (in seconds) to travel the measured distance.

Make sure that the tractor is travelling at spraying speed when you pass the start and finish marks and ensure the fan and pump are at operational speed.

If you have a hectare metre or automatic controller you need to check the speed calibration of the controller.

Tractor model	
Gear	
Range	
Dual power	
Engine RPM	
Speed Km/h	

**Kilometres per Hour = Distance traveled (m) x 3.6/time (seconds)**

#### Step 3

##### Determine Spraying Volume Required

It is essential to determine the liquid volume per hectare required to effectively spray a crop without overspraying or underspraying.

Use your own experience or a registered rate calibration consultant to determine effective volume in litres per hectare.

..... litres/ha

#### Step 4

##### Determine Sprayer Configuration

Number of rows to be sprayed in one pass	= 1
Total number of nozzles to be used:	

#### Step 5

Determine ideal spray pressure (bar)

#### Step 6A & 6B

##### Determine & Select Nozzles

Determine nozzle flow rate required:

$$\frac{\text{Litres/Minute}}{\text{Litres/Ha} \times \text{Km/hr} \div 600 \div \text{Total Number of Nozzles Used} \times \text{Row Spacing (m)} \times \text{Number of Rows in One Pass}}$$

$$= \frac{\text{ } \times \text{ } \div 600 \div \text{ } \times 1}{\text{ }} \text{ litres/minute/for all nozzles (divide by 2 for each half)}$$

#### Step 7

##### Fit & Test Selected Nozzles

The most important calibration is to test for actual litre per hectare.

Fill your spray tank to overflowing and run the sprayer for one minute, at the above operating settings, and record the total litres per minute used.

$$\frac{\text{Output/min/side (l/min)}}{\text{Output (litres)} \div \text{Time (minutes)}} = \text{ } \div \text{ } = \text{ } \text{ litres/minute}$$

#### Step 8

##### Calculate the Actual Application Rate

To calculate actual application rate (litres per hectare), use the following formula:

$$\text{Application Rate (l/ha)} = \frac{\text{Total Sprayer Output (l/min)} \times 600}{\text{Speed (Km/hr)} \div \text{Row Spacing (m)} \div \text{Number Rows in One Pass}}$$

$$= \text{ } \times 600 \div \text{ } \div \text{ } \div 1 = \text{ } \text{ litres/ha}$$

**DISCLAIMER:**  
Because of the many variable factors involved Croplands can not be held responsible for any downgrading or loss of crop resulting from the use of any information in this manual. This is issued as a guide only and subject to acceptance of this disclaimer.

#### Step 6D Calibration Work Sheet ; CROPAIR with Albus ATR

LEFT side spray ring				Right side spray ring			
Nozzle	ALBUZ Hollow Cone	Discharge	Spray angle	Nozzle	ALBUZ Hollow Cone	Discharge	Spray angle
Top 1				Top 1			
2				2			
3				3			
Middle 4				Middle 4			
5				5			
6				6			
Bottom 7				Bottom 7			
			one side =				one side =
			L/min LEFT Spray Ring	L/Min ALL NOZZLES			L/min RIGHT Spray Ring
Pressure							

# SECTION 7

## SPRAYING INFORMATION

### CALIBRATION WORK SHEET

## CROPAIR with Albus ATI Nozzles

#### Step 1

Check the Sprayer is in Good Working Order

#### Step 2

##### Determine Actual Speed of Travel

Measure and mark a straight path of 100 metres (or more) of travelling conditions similar to the orchard or vine yard you are going to spray.

Half fill the spray tank & record the time (in seconds) to travel the measured distance.

Make sure that the tractor is travelling at spraying speed when you pass the start and finish marks and ensure the fan and pump are at operational speed.

If you have a hectare metre or automatic controller you need to check the speed calibration of the controller.

Tractor model	
Gear	
Range	
Dual power	
Engine RPM	
Speed Km/h	

**Kilometres per Hour = Distance traveled (m) x 3.6/time (seconds)**

#### Step 3

##### Determine Spraying Volume Required

It is essential to determine the liquid volume per hectare required to effectively spray a crop without overspraying or underspraying.

Use your own experience or a registered rate calibration consultant to determine effective volume in litres per hectare.

..... litres/ha

#### Step 4

##### Determine Sprayer Configuration

Number of rows to be sprayed in one pass	= 1
Total number of nozzles to be used:	

#### Step 5

Determine ideal spray pressure (bar)

#### Step 6A & 6B

##### Determine & Select Nozzles

Determine nozzle flow rate required:

$$\frac{\text{Litres/Minute}}{\text{Litres/Ha} \times \text{Km/hr} \div 600 \div \text{Total Number of Nozzles Used} \times \text{Row Spacing (m)} \times \text{Number of Rows in One Pass}}$$

$$\frac{\text{ } \times \text{ } \div 600 \div \text{ } \times 1}{\text{ }} = \text{ } \text{ litres/minute/for all nozzles (divide by 2 for each half)}$$

#### Step 7

##### Fit & Test Selected Nozzles

The most important calibration is to test for actual litre per hectare.

Fill your spray tank to overflowing and run the sprayer for one minute, at the above operating settings, and record the total litres per minute used.

$$\frac{\text{Output/min/side (l/min)}}{\text{Output (litres)} \div \text{Time (minutes)}} = \text{ } \div \text{ } = \text{ } \text{ litres/minute}$$

#### Step 8

##### Calculate the Actual Application Rate

To calculate actual application rate (litres per hectare), use the following formula:

$$\text{Application Rate (l/ha)} = \frac{\text{Total Sprayer Output (l/min)} \times 600}{\text{Speed (Km/hr)} \div \text{Row Spacing (m)} \div \text{Number Rows in One Pass}}$$

$$\text{ } \times 600 \div \text{ } \div \text{ } \div 1 = \text{ } \text{ litres/ha}$$

**DISCLAIMER:**  
Because of the many variable factors involved Croplands can not be held responsible for any downgrading or loss of crop resulting from the use of any information in this manual. This is issued as a guide only and subject to acceptance of this disclaimer.

#### Step 6D Calibration Work Sheet ; CROPAIR with Albus ATR

LEFT side spray ring				Right side spray ring			
Nozzle	ALBUZ Hollow Cone	Discharge	Spray angle	Nozzle	ALBUZ Hollow Cone	Discharge	Spray angle
Top 1				Top 1			
2				2			
3				3			
Middle 4				Middle 4			
5				5			
6				6			
Bottom 7				Bottom 7			
			one side =				one side =
			L/min LEFT Spray Ring	L/Min ALL NOZZLES			L/min RIGHT Spray Ring
Pressure							

# SECTION 7

## SPRAYING INFORMATION

### CALIBRATION WORK SHEET

#### Step 1

Check the Sprayer is in Good Working Order

#### Step 2

##### Determine Actual Speed of Travel

Measure and mark a straight path of 100 metres (or more) of travelling conditions similar to the orchard or vine yard you are going to spray.

Half fill the spray tank & record the time (in seconds) to travel the measured distance.

Make sure that the tractor is travelling at spraying speed when you pass the start and finish marks and ensure the fan and pump are at operational speed.

If you have a hectare metre or automatic controller you need to check the speed calibration of the controller.

Tractor model	
Gear	
Range	
Dual power	
Engine RPM	
Speed Km/h	

**Kilometres per Hour = Distance traveled (m) x 3.6/time (seconds)**

#### Step 3

##### Determine Spraying Volume Required

It is essential to determine the liquid volume per hectare required to effectively spray a crop without overspraying or underspraying.

Use your own experience or a registered rate calibration consultant to determine effective volume in litres per hectare.

..... litres/ha

#### Step 4

##### Determine Sprayer Configuration

Number of rows to be sprayed in one pass	= 1
Total number of nozzles to be used:	

#### Step 5

Determine ideal spray pressure (bar)	
--------------------------------------	--

#### Step 6A & 6B

##### Determine & Select Nozzles

Determine nozzle flow rate required:

$$\frac{\text{Litres/Minute}}{\text{Litres/Ha} \times \text{Km/hr} \div 600 \div \text{Total Number of Nozzles Used} \times \text{Row Spacing (m)} \times \text{Number of Rows in One Pass}}$$

$$\frac{\text{ } \times \text{ } \div 600 \div \text{ } \times 1}{\text{ }} = \text{ } \text{ litres/minute/for all nozzles (divide by 2 for each half)}$$

#### Step 7

##### Fit & Test Selected Nozzles

The most important calibration is to test for actual litre per hectare.

Fill your spray tank to overflowing and run the sprayer for one minute, at the above operating settings, and record the total litres per minute used.

$$\frac{\text{Output/min/side (l/min)}}{\text{Output (litres)} \div \text{Time (minutes)}} = \text{ } \div \text{ } = \text{ } \text{ litres/minute}$$

#### Step 8

##### Calculate the Actual Application Rate

To calculate actual application rate (litres per hectare), use the following formula:

$$\text{Application Rate (l/ha)} = \frac{\text{Total Sprayer Output (l/min)} \times 600 \div \text{Speed (Km/hr)} \div \text{Row Spacing (m)} \div \text{Number Rows in One Pass}}{\text{ }} \times 600 \div \text{ } \div \text{ } \div 1 = \text{ } \text{ litres/ha}$$

**DISCLAIMER:**  
Because of the many variable factors involved Croplands can not be held responsible for any downgrading or loss of crop resulting from the use of any information in this manual. This is issued as a guide only and subject to acceptance of this disclaimer.

#### Step 6D Calibration Work Sheet ; CROPAIR with Disk & Core Nozzles

LEFT side spray ring					RIGHT side spray ring				
Nozzle	Disc No.	Core No.	Discharge	Spray angle	Nozzle	Disc No.	Core No.	Discharge	Spray angle
Top 1					Top 1				
2					2				
3					3				
Middle 4					Middle 4				
5					5				
6					6				
Bottom 7					Bottom 7				
				one side =					one side =
				L/min LEFT Spray Ring					L/min RIGHT Spray Ring
				Pressure					L/Min ALL NOZZLES

# SECTION 7

## SPRAYING INFORMATION

### CALIBRATION WORK SHEET

#### Step 1

Check the Sprayer is in Good Working Order

#### Step 2

##### Determine Actual Speed of Travel

Measure and mark a straight path of 100 metres (or more) of travelling conditions similar to the orchard or vine yard you are going to spray.

Half fill the spray tank & record the time (in seconds) to travel the measured distance.

Make sure that the tractor is travelling at spraying speed when you pass the start and finish marks and ensure the fan and pump are at operational speed.

If you have a hectare metre or automatic controller you need to check the speed calibration of the controller.

Tractor model	
Gear	
Range	
Dual power	
Engine RPM	
Speed Km/h	

**Kilometres per Hour = Distance traveled (m) x 3.6/time (seconds)**

#### Step 3

##### Determine Spraying Volume Required

It is essential to determine the liquid volume per hectare required to effectively spray a crop without overspraying or underspraying.

Use your own experience or a registered rate calibration consultant to determine effective volume in litres per hectare.

..... litres/ha

#### Step 4

##### Determine Sprayer Configuration

Number of rows to be sprayed in one pass	= 1
Total number of nozzles to be used:	

#### Step 5

Determine ideal spray pressure (bar)

#### Step 6A & 6B

##### Determine & Select Nozzles

Determine nozzle flow rate required:

$$\frac{\text{Litres/Minute}}{\text{Litres/Ha} \times \text{Km/hr} \div 600 \div \text{Total Number of Nozzles Used} \times \text{Row Spacing (m)} \times \text{Number of Rows in One Pass}}$$

$$\text{.....} \times \text{.....} \div 600 \div \text{.....} \times 1$$

$$= \text{..... litres/minute/for all nozzles (divide by 2 for each half)}$$

#### Step 7

##### Fit & Test Selected Nozzles

The most important calibration is to test for actual litre per hectare.

Fill your spray tank to overflowing and run the sprayer for one minute, at the above operating settings, and record the total litres per minute used.

$$\frac{\text{Output/min/side (l/min)}}{\text{Output (litres)} \div \text{Time (minutes)}}$$

$$= \text{..... litres/minute}$$

#### Step 8

##### Calculate the Actual Application Rate

To calculate actual application rate (litres per hectare), use the following formula:

$$\text{Application Rate (l/ha)} = \frac{\text{Total Sprayer Output (l/min)} \times 600 \div \text{Speed (Km/hr)} \div \text{Row Spacing (m)} \div \text{Number Rows in One Pass}}{1}$$

$$= \text{..... litres/ha}$$

**DISCLAIMER:**  
Because of the many variable factors involved Croplands can not be held responsible for any downgrading or loss of crop resulting from the use of any information in this manual. This is issued as a guide only and subject to acceptance of this disclaimer.

#### Step 6D Calibration Work Sheet ; CROPAIR with Disk & Core Nozzles

LEFT side spray ring					RIGHT side spray ring				
Nozzle	Disc No.	Core No.	Discharge	Spray angle	Nozzle	Disc No.	Core No.	Discharge	Spray angle
Top 1					Top 1				
2					2				
3					3				
Middle 4					Middle 4				
5					5				
6					6				
Bottom 7					Bottom 7				
				one side =					one side =
				L/min LEFT Spray Ring					L/min RIGHT Spray Ring
				Pressure					L/Min ALL NOZZLES

# **SECTION 8**

## **LUBRICATION & MAINTENANCE**

### **FAN CLEANING**

The Fiena fan air intake guards should be regularly checked and if necessary cleaned of leaves and similar debris. ALWAYS disengage the fan when cleaning the guards.

<b>GREASING &amp; SERVICE PROCEDURES</b>	<b>49</b>
<b>EVERY 200 HOURS</b>	<b>49</b>
<b>DIAPHRAGM PUMPS</b>	<b>50</b>
<b>FILTERS</b>	<b>51</b>



# SECTION 8

## LUBRICATION & MAINTENANCE

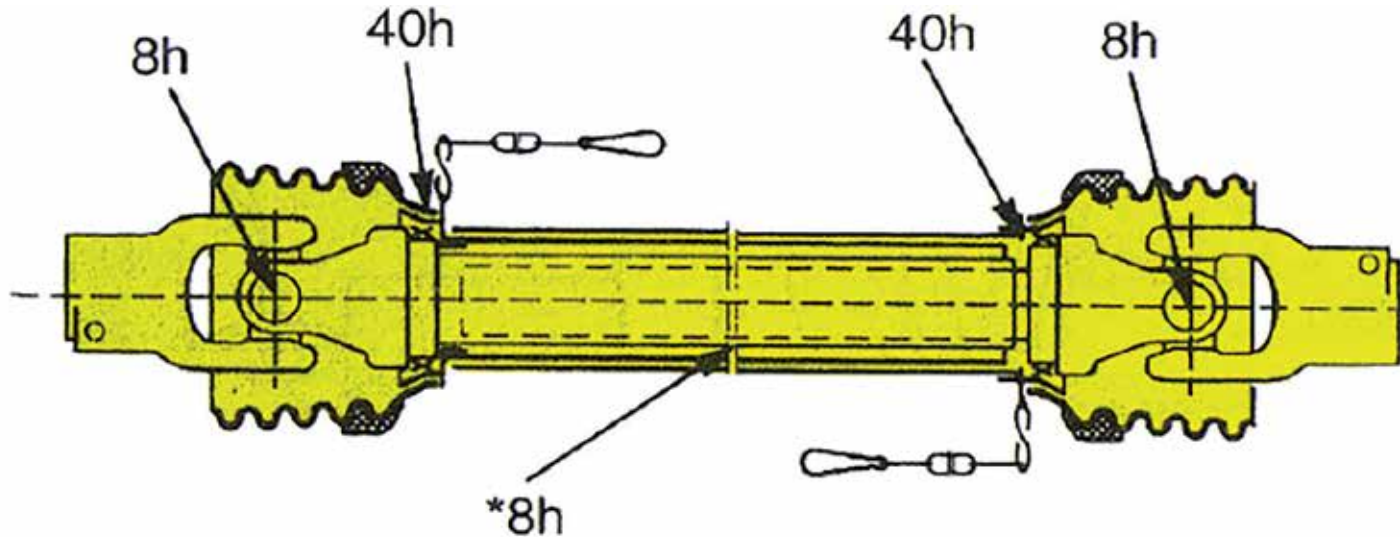

Grease the PTO shaft as shown. \* Pull shaft apart - apply grease to the inside of the outer telescopic profile.

### GREASING & SERVICE PROCEDURES

1. Clean suction line filter after completion of each tank.
2. Clean pressure line filter regularly.
3. Grease tractor to sprayer PTO universal joints every 8 hours. Grease lightly until grease becomes firm in seals. Over greasing will break seals and allow dust and moisture to penetrate - increasing wear.
4. Grease PTO inner tubes every 8 hours. To lubricate the inner tube, slide PTO shaft apart, clean the telescopic tubes, grease and reassemble.
5. Grease the PTO covers every 40 hours.

6. Ensure safety covers and safety chains are in place and in good working order.
7. Check pump air chamber pressure on a regular basis. As a general guideline it should be 10%-20% of operating pressure (70-100 kPa [10-15 psi]). Refer to the pump manual for more information.
8. To ensure trouble free spraying, flush the sprayer with fresh water thoroughly each day, and before changing chemicals. Dispose of tank wash according to chemical manufacturers instructions.
9. Grease all boom joints, height adjusting points and other grease points.

### EVERY 200 HOURS

1. Lubricate quick release lock pins on PTO shaft.
2. Grease all tank lid seals with vaseline.
3. Check to ensure agitators have not become blocked with sulphur/chemicals.
4. Check pump mounts.

# SECTION 8

## LUBRICATION & MAINTENANCE



AR503

### DIAPHRAGM PUMPS

#### Diaphragm Pumps Maintenance

Annovi & Reverberi (A&R) pumps are of the piston-diaphragm type. All parts in contact with the spray liquid, which are subject to corrosion, are protected, making them ideal for spraying.

#### Daily Before Starting the Pump

1. Check that oil is visible in sight glass (half way up) and top up if necessary with good clean motor oil 20W/30 or 20W/40.
2. Clean all sprayer filters. Blocked or semi blocked filters place extra stress on diaphragms.
3. Start with zero pressure and the pump will self prime immediately and clear air locks in suction line.

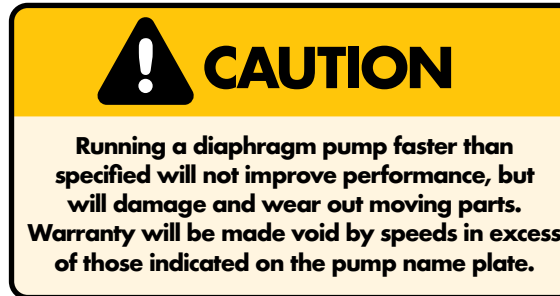

#### Daily after Use

1. Flush pump with clean water.
2. Drain filters and clean. A high percentage of pump failures are due to blocked filters.

#### Every 50 Hours

Check surge chamber pressure and adjust as required.

- Air pressure is usually around 25% of operating pressure].

Vibration of the delivery hose usually indicates that the air pressure in the surge chamber is incorrect.

The main cause of surge chamber diaphragm fracture is low pressure in this chamber.

Surge chamber pressure can be checked with an ordinary tyre gauge.

The above pressure range is a guide to the correct pressure.

However, if difficulties recur, adjust the pressure until an even flow is obtained from the pump (no pulsing of liquid at operating RPM). The pressure is best increased with a bicycle pump, hand pump or foot pump.

#### Every 250 hours or Every Season - Whichever Comes Sooner

1. Change oil and refill with 20W/30 oil. Attention should be made to remove trapped air behind the diaphragms by rocking from side to side as instructed. It is also good practise run the pump for 10 minutes without pressure, and then, top up with oil before working the pump.

2. When changing the pump oil, check diaphragms and replace them if they are showing signs of wear.

Diaphragm valves should be replaced every 400 hours regardless of wear.

This is normally a pre-season maintenance procedure which can be done easily as no special tools are required.

You can avoid unnecessary down time in spraying seasons by carrying out preventative maintenance.

3. Also check inlet and outlet valves and replace if worn. Worn valves not only reduce the output of the pump, but may reduce the life of the diaphragms.

#### Excessive Diaphragm Failure

If you have excessive diaphragm failure check the following points. These will cause failure of diaphragms due to added stress or chemical attack.

1. Most Important - Pump not being flushed out daily with clean water after use.
2. Oil level too low allowing air between piston and diaphragm.
3. Air leaks in suction line.
4. Restricted suction line.

# SECTION 8

## LUBRICATION & MAINTENANCE

5. Restriction through suction filter.
6. Not cleaning suction filter regularly.
7. Worn suction and discharge valves.
8. Bypass line too small to carry full capacity of pump.
9. In cold climates - frozen suction/discharge lines or water remaining in the pump after flushing.
10. Incorrect air setting or no air in air chamber.
11. Agitator excessively restricting bypass from pump.
12. Diaphragm material construction incorrect for chemical or solution being pumped.
13. Chemicals containing toluene or other aggressive solvents may require viton diaphragms - particularly if the pump is not properly flushed after use.

### Pre-Season Servicing

For thorough pre-season servicing - check all aspects of the sprayer and its operating components as outlined in the pre-delivery check list.

### Pump Storage and Corrosion Protection

#### 1. Warm Climates

If you operate in a warm climate with no chance of frost in the winter, you will not have any problems with frost damage.

If you are storing your sprayer between seasons, ensure your pump has been thoroughly flushed with clean water. A good idea is to run a mixture of 1% solution of summer mineral spraying oil through the pump and plumbing system. Summer spraying oil is water-soluble oil such as DC-Tron. This will coat and protect all internal pump parts. Ensure this mixture is flushed out before spraying commences in the new season.

#### 2. Cold Climates

For prolonged storage, an anti-freeze mixture can be flushed through the pump. Ensure this is thoroughly flushed out prior to the commencement of spraying again.

If the pump is being stored overnight and a risk of freezing is imminent, drain all liquid from the pump and lines, including boom lines.

## FILTERS

### Filter Maintenance

Clean filters ensure that no solids enter the spraying system to block or damage pump or nozzles.

All filters should be cleaned regularly or after each spraying period.



The pump suction valve CLOSED to the main tank

### Suction Filter

The suction filter should be cleaned regularly, or after each spray tank has been emptied. Also refer to page 18.

To clean the filter:

1. Completely stop all sprayer functions.
2. Place the tank selection valve in the closed position to shut off liquid from the main tank.
3. Remove the outer filter screw and bowl.



Remove the outer filter screw and bowl

4. Remove the filter screen & thoroughly clean it and other components before reassembling the filter.



Remove & clean the filter element & components

# SECTION 8

## LUBRICATION & MAINTENANCE

- Carefully reassemble the filter, ensuring the screen O-Rings are in place, and then, tighten the outer filter screw so that the outer O-ring is properly sealed.



Reassemble and tighten the outer filter screw.

- Open the tank selection valve** to access liquid from the main tank, then check the filter is sealed correctly. If leaking, further tighten the outer screw until sealed. If this does not stop the leaking, check the alignment of the O-ring and/or the condition of the O-ring. Replace if necessary. Vaseline is the best lubricant for filter seals.

### Cleaning the Pressure Filter

The pressure filter (if fitted) should be cleaned regularly or after each spray tank has been emptied.

To clean the pressure line filter:

- **Always wear gloves.** Some spillage is possible, therefore perform this operation in an appropriate place, and with safety clothing.
- Completely stop all sprayer functions.
- Remove the outer filter bowl, remove the filter, and thoroughly clean before re-assembly.



Open & close the filter tap while system is pressurised

## NOTE

**Be careful not to damage or deform the mesh or O-ring while cleaning and refitting the suction filter. If the filter screen or O-ring is damaged, replace the part.**

## CAUTION

**Ensure the TANK SELECTION VALVE IS OPEN before starting the pump. Starting the pump with the Tank Selection valve closed will seriously damage the suction valve and warranty will be made void.**

**For Major Servicing follow the pre-delivery Checklist that came with the sprayer.**

# SECTION 9

## TROUBLESHOOTING

### DIAPHRAGM PUMP PROBLEMS

PROBLEM	PROBABLE CAUSE	REMEDY
<b>A. Pump does not draw or deliver liquid. Pressure gauge fluctuates badly</b>	<ol style="list-style-type: none"> <li>1. The pump is sucking in air through suction line.</li> <li>2. Air has not been entirely evacuated from the pump.</li> <li>3. Blocked suction filter.</li> <li>4. Damaged or worn suction valves.</li> </ol>	<ol style="list-style-type: none"> <li>1. Examine the suction hose and ensure it is firmly secured.</li> <li>2. Rotate the pump with outlet hose and taps open.</li> <li>3. Clean suction filter.</li> <li>4. Replace suction valves.</li> </ol>
<b>B. Liquid flow is irregular (Also check items under A)</b>	<ol style="list-style-type: none"> <li>1. The air in the air chamber of the pump is incorrectly set.</li> <li>2. Diaphragm split.</li> <li>3. Damaged or worn valves.</li> <li>4. Foreign matter holding valves open.</li> </ol>	<ol style="list-style-type: none"> <li>1. Check pressure in air chamber of pump. See pump manual.</li> <li>2. Replace diaphragm.</li> <li>3. Replace valves.</li> <li>4. Clean valves.</li> </ol>
<b>C. Pump delivers insufficient pressure</b>	<ol style="list-style-type: none"> <li>1. Regulating valve: <ul style="list-style-type: none"> <li>• Sticking open</li> <li>• Not set for pressure</li> <li>• Damaged or worn seat or spring</li> </ul> </li> <li>2. Cylinder diaphragm ruptured.</li> <li>3. Pump valves blocked, worn or damaged.</li> <li>4. Spray nozzles worn, missing or exceed pump capacity.</li> </ol>	<ol style="list-style-type: none"> <li>1. Fix the regulator: <ul style="list-style-type: none"> <li>• Unstick the valves</li> <li>• Set the pressure</li> <li>• Replace the spring</li> </ul> </li> <li>2. Replace diaphragms.</li> <li>3. Unblock valves and or replace.</li> <li>4. Replace spray nozzles with appropriate size.</li> </ol>
<b>D. Output drops &amp; pump is noisy</b>	<ol style="list-style-type: none"> <li>1. Blocked suction lines or filter screen.</li> </ol>	<ol style="list-style-type: none"> <li>1. Check and clean as required.</li> </ol>
<b>E. Oil being discharged through delivery line or discoloured oil in sight glass of pump</b>	<ol style="list-style-type: none"> <li>1. One or more diaphragms split or ruptured.</li> </ol>	<ol style="list-style-type: none"> <li>1. Immediately drain oil from pump and flush to remove all spray residues from sump. Remove pump heads &amp; fit new diaphragms. Fill to correct level with motor oil 20W/30.</li> </ol>

# SECTION 9

## TROUBLESHOOTING

### DIAPHRAGM PUMP PROBLEMS

PROBLEM	PROBABLE CAUSE	REMEDY
<b>SUCTION SIDE OF PUMP</b>		
<b>F. Suction hose vibration... / hunting</b>	1. Air getting into suction.	1. Check suction lines for leaks.
<b>G. Pump valves hammering</b>	1. Suction tap partly turned off. 2. Suction strainer(s) blocked.	1. Seal all joints securely with tape or stag. Firm up clamps. 2. Check the suction filter is sealed.
<b>H. No water flow in suction hose</b>	1. Suction Tank Selection Valve turned off. 2. Suction strainer(s) blocked.	1. Turn valve fully on. 2. Clean filters.
<b>DISCHARGE SIDE OF PUMP</b>		
<b>I. Manual regulator valve leaking from spindle</b>	1. Split diaphragm or O-rings.	1. Remove 4 body set screws, replace diaphragm and O-rings.
<b>J. Pressure gauge showing correct working pressure no pressure at nozzle</b>	1. Burst discharge line. 2. Blocked discharge filter where fitted. 3. O-ring(s) jamming flow in discharge line. 4. Ants, wasps build nests in discharge line or nozzles.	1. Replace discharge line. 2. Clean discharge filter. 3. Clean discharge line of foreign materials. 4. Clean nozzles of foreign materials with tooth brush

# SECTION 9

## TROUBLESHOOTING

### GENERAL SPRAYER PROBLEMS

PROBLEM	PROBABLE CAUSE	REMEDY
<b>1. No spray when turned on</b>	<ol style="list-style-type: none"> <li>1. Filter on the inlet side of the pump blocked.</li> <li>2. Faulty pump.</li> <li>3. Control valves not working</li> </ol>	<ol style="list-style-type: none"> <li>1. Dismantle, clean &amp; re-assemble.</li> <li>2. Change pump.</li> <li>3. Check all motor valves and manual Pressure Regulating Valve.</li> </ol>
<b>2. Sprays for short time only</b>	<ol style="list-style-type: none"> <li>1. Air inlet to tank blocked.</li> <li>2. Filter on suction side of pump blocking or blocked.</li> </ol>	<ol style="list-style-type: none"> <li>1. Clean air vent.</li> <li>2. Dismantle, clean &amp; re-assemble the filter. If filter problem persists, clean out the tank &amp; start again.</li> </ol>
<b>3. Spray is uneven around the spray-head</b>	<ol style="list-style-type: none"> <li>1. Blocked nozzles.</li> <li>2. Nozzle tips worn.</li> <li>3. Different pressure at nozzles; wrong nozzles fitted.</li> </ol>	<ol style="list-style-type: none"> <li>1. Remove, clean &amp; check. Check output &amp; for streaks.</li> <li>2. Check nozzle output, replace worn nozzles.</li> <li>3. Remove a nozzle in each section &amp; check that flow rate is the same. If different, check for blockages.</li> </ol>
<b>4. Pressure going up - output going down</b>	<ol style="list-style-type: none"> <li>1. Blocked nozzles.</li> <li>2. Pressure filter blocking.</li> </ol>	<ol style="list-style-type: none"> <li>1. Dismantle, clean &amp; refit. Check pressure returns to normal. Check all filters and spray mixture.</li> <li>2. Check &amp; clean the pressure filter.</li> </ol>
<b>5. Pressure falling</b>	<ol style="list-style-type: none"> <li>1. Filter on suction side blocked.</li> <li>2. Nozzle tips worn.</li> <li>3. Pressure gauge faulty.</li> <li>4. Pump worn.</li> <li>5. Worn manual PRV (pressure regulating valve)</li> </ol>	<ol style="list-style-type: none"> <li>1. Dismantle &amp; clean the filter.</li> <li>2. Check nozzle output, replace worn nozzles.</li> <li>3. Check with new pressure gauge.</li> <li>4. Repair or replace the pump.</li> <li>5. Replace PRV</li> </ol>
<b>6. Spray pattern narrow or faltering</b>	<ol style="list-style-type: none"> <li>1. Pressure too low.</li> <li>2. Nozzles blocked or partially blocked.</li> </ol>	<ol style="list-style-type: none"> <li>1. Check that the correct nozzles are being used... check and clean..</li> <li>2. Check that the tank is not empty. If not, there is an air leak between the pump &amp; tank or in the pump. Check plumbing &amp; repair.</li> </ol>
<b>7. Foam in the tank</b>	<ol style="list-style-type: none"> <li>1. Too much agitation.</li> </ol>	<ol style="list-style-type: none"> <li>1. Switch Off one or both agitators.</li> </ol>

# SECTION 10

## ASSEMBLY DRAWINGS, PARTS & SCHEMATICS

**ALL PARTS INFORMATION is now listed on the Croplands website:**

- Go to [croplands.com.au](http://croplands.com.au)
- Search in the Parts Information section linked to the home page.

### NOTE

Drawings are for illustration purpose only - refer to sprayer for actual plumbing. Parts listed are indicative of the sprayer type.  
Items in italics or without a part number are non stocked items and may need to be specially ordered.  
For further parts information refer to: [www.croplands.com.au](http://www.croplands.com.au)

### NOTE

Contact Croplands Technical Support for further information:  
**1300 650 724**

<b>FIENI FAN ASSEMBLY</b>	<b>57</b>
<b>HL300/600 ASSEMBLY</b>	<b>58</b>
<b>HL600/800 ASSEMBLY</b>	<b>60</b>



# SECTION 10

## ASSEMBLY DRAWINGS, PARTS & SCHEMATICS

### FIENI FAN ASSEMBLY

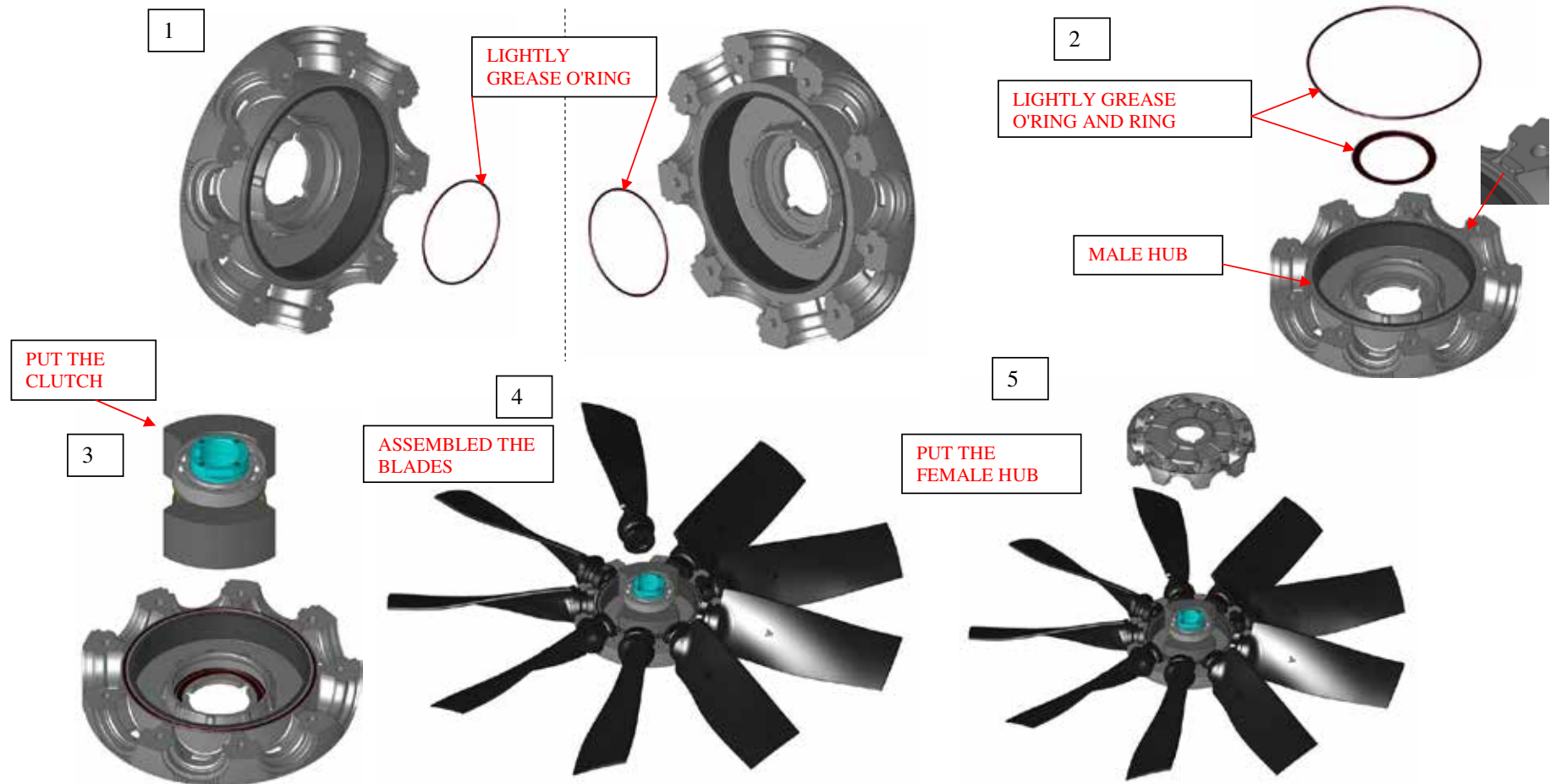

# SECTION 10

## ASSEMBLY DRAWINGS, PARTS & SCHEMATICS

### HL300/600 ASSEMBLY

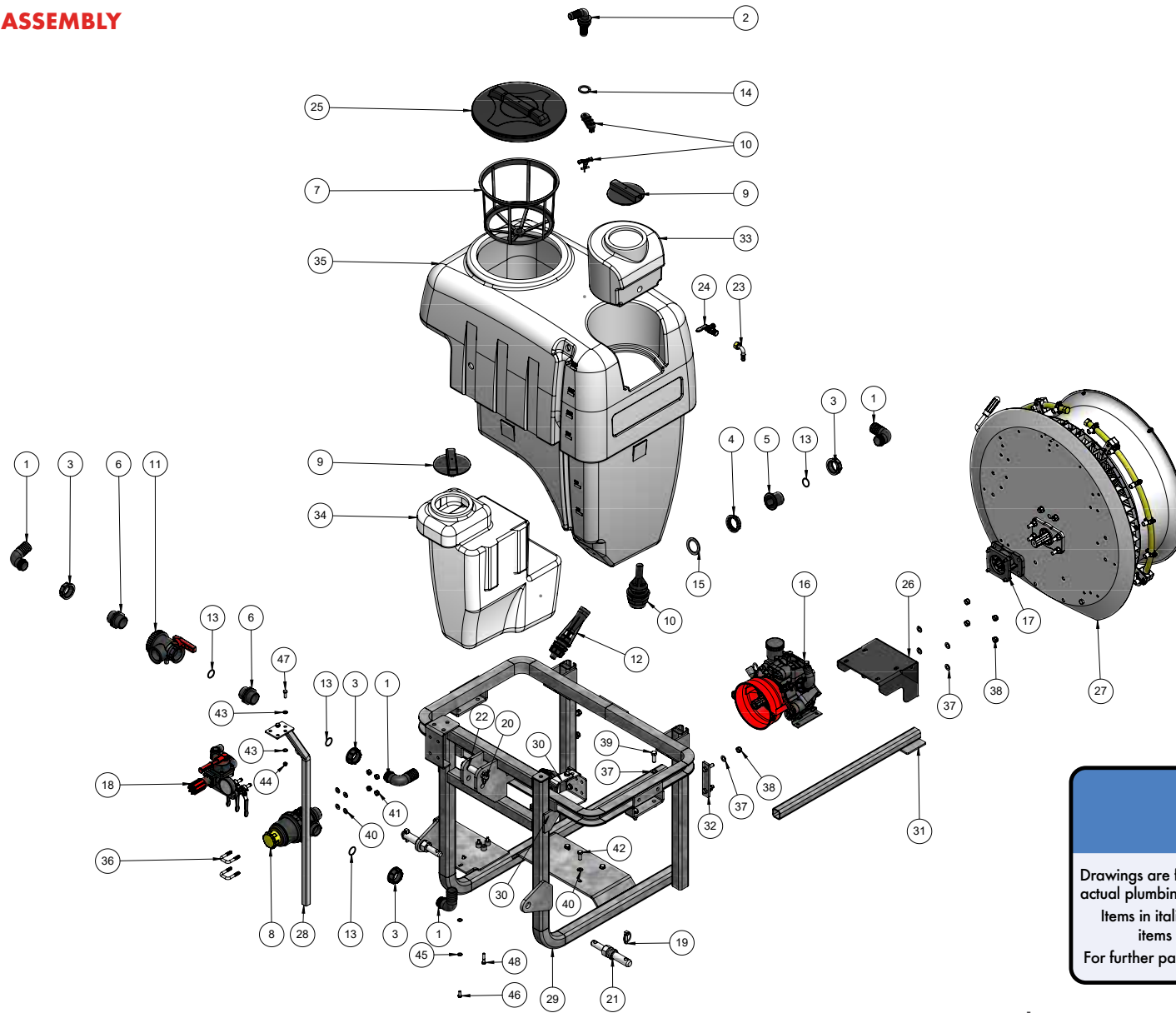

**NOTE**

Drawings are for illustration purpose only - refer to sprayer for actual plumbing. Parts listed are indicative of the sprayer type. Items in *italics* or without a part number are non stocked items and may need to be specially ordered. For further parts information refer to: [www.croplands.com.au](http://www.croplands.com.au)

Please contact Technical support for further details

# SECTION 10

## ASSEMBLY DRAWINGS, PARTS & SCHEMATICS

NO.	PART NUMBER	DESCRIPTION	QTY.
1	A116640	ELBOW 1 1/2"	5
2	A118426	PIPE 1 X 1 SINGLE PIECE 90DEG	1
3	A200060	FLY NUT 1 1/2"	5
4	A205060	BACK NUT 1 1/2"	2
5	A220060	TANK OUTLET 1 1/2"	2
6	A250060	NIPPLE 1 1/2"	2
7	A300120	FILTER BASKET MEDIUM 254MM DEEP	1
8	A314463	FILTER 1 1/2" 50MM SH/THR SOV	1
9	A3522000	BREATHER FOR 355MM & 455MM LID	2
10	A452107	VALVE 2" ANTI POLLUTION DRAIN	1
11	A454236	BALL VALVE POLY 1 1/2" 3 WAY	1
12	A5022042	AGITATOR STRAIGHT #2 CERAMIC J	1
13	AG10061	O RING 1 1/2"	5
14	AG40004	FLAT SEAL 1" EPDM	1
15	AG40006	FLAT SEAL 1 1/2" EPDM	2
16	AR503-APC	PUMP AR503APC/SP	1
17	AR5290	FLANGE (FIENI V1)	1
18	ARVDR50	CONTROLLER VDR50I 2 WAY	1
19	B0006	BARE LINCH PIN 7/16" DIA	3
20	B0075	TOP LINK PIN CAT 1 (MF35)	1
21	B0205	CAT 1-2 IMPLEMENT PIN 1" NUT	2
22	B0353	BUSH CONVERSION CAT 1 TO CAT 2	1
23	B163.604.13	ELBOW 1/2" C/W HEX NUT 1/2"	1
24	B165.1501.5	BALL VALVE 1/2" X 1/2" RH	1
25	G8155000	LID/RING KIT 355MM	1
26	HP-121	PUMP MOUNT BRKT 620 FAN AR503	1
27	KH-5013	FAN 600SV NO CLUTCH	1
28	LP-121	CONTROLLER BRACKET LINKAGE	1

NO.	PART NUMBER	DESCRIPTION	QTY.
29	LP030	FRAME 300LT AGRIPAK FARMATE	1
30	LP060-1	FLUSH TANK BRACKET	1
31	LP060-5	FOOT EXTENSION	2
32	LP060-7-2	BOOM MOUNT 600LT	2
33	P300-10L	10LT HAND WASH TANK TO SUIT 300LT	1
34	P300-45L	45LT FLUSH TANK TO SUIT 300LT LINKAGE	1
35	P300L	300LT LINKAGE CHEMICAL TANK	1
36	XBMBB32	U BOLT 32MM	2
37	M12FWASHER	M12 FLAT WASHER ZP	12
38	M12NNUT	M12 NYLOC NUT HT ZP	10
39	M12X35	M12 X 35 SET SCREW HT ZP	2
40	M10FWASHER	M10 FLAT WASHER ZP	16
41	M10NNUT	M10 NYLOC NUT HT ZP	10
42	M10X30	M10 X 30 SET SCREW HT ZP	6
43	M8FWASHER	M8 FLAT WASHER ZP	10
44	M8NNUT	M8 NYLOC NUT HT ZP	2
45	M8SWASHER	M8 SPRING WASHER ZP	6
46	M8X20	M8 X 20 SET SCREW HT ZP	3
47	M8X25	M8 X 25 SET SCREW HT ZP	2
48	M8X40BOLT	M8 X 40 HEX HEAD BOLT HT ZP	3

# SECTION 10

## ASSEMBLY DRAWINGS, PARTS & SCHEMATICS

### HL600/800 ASSEMBLY

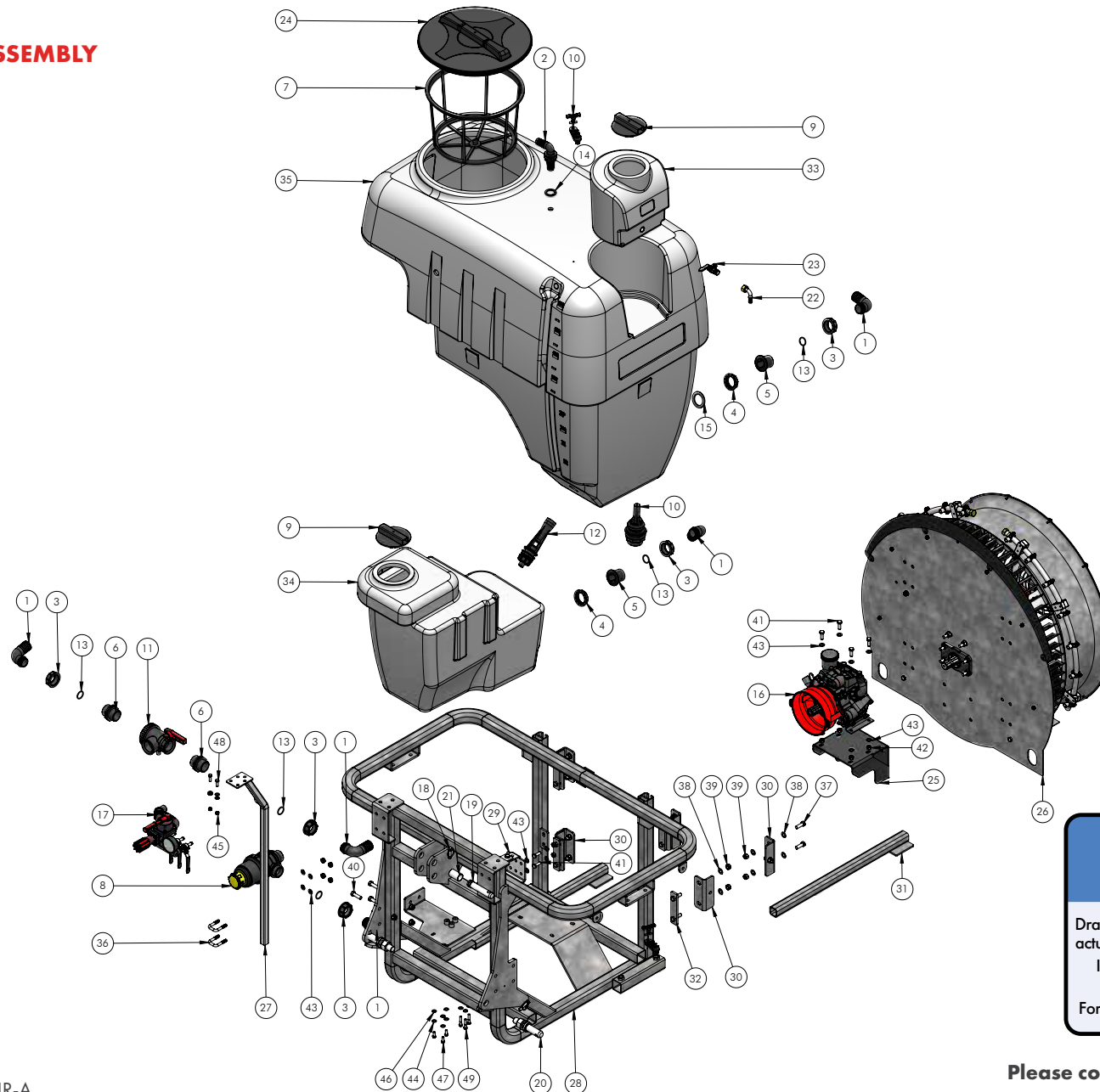

### NOTE

Drawings are for illustration purpose only - refer to sprayer for actual plumbing. Parts listed are indicative of the sprayer type.

Items in italics or without a part number are non stocked items and may need to be specially ordered.

For further parts information refer to: [www.croplands.com.au](http://www.croplands.com.au)

Please contact Technical support for further details

# SECTION 10

## ASSEMBLY DRAWINGS, PARTS & SCHEMATICS

NO.	PART NUMBER	DESCRIPTION	QTY.
1	A116640	ELBOW 1 1/2"	5
2	A118426	PIPE 1 X 1 SINGLE PIECE 90DEG	1
3	A200060	FLY NUT 1 1/2"	5
4	A205060	BACK NUT 1 1/2"	2
5	A220060	TANK OUTLET 1 1/2"	2
6	A250060	NIPPLE 1 1/2"	2
7	A300130	FILTER BASKET LARGE 254MM DEEP	1
8	A314463	FILTER 1 1/2" 50MM SH/THR SOV	1
9	A3522000	BREATHER FOR 355MM & 455MM LID	2
10	A452107	VALVE 2" ANTI POLLUTION DRAIN	1
11	A454236	BALL VALVE POLY 1 1/2" 3 WAY	1
12	A5022042	AGITATOR STRAIGHT #2 CERAMIC J	1
13	AG10061	O RING 1 1/2"	5
14	AG40004	FLAT SEAL 1" EPDM	1
15	AG40006	FLAT SEAL 1 1/2" EPDM	2
16	AR503-APC	PUMP AR503APC/SP	1
17	ARVDR50	CONTROLLER VDR50I 2 WAY	1
18	B0006	BARE LINCH PIN 7/16" DIA	3
19	B0076	TOP LINK PIN 3" X 7/16" S1040	1
20	B0102	IMPLEMENT PIN CAT 2	2
21	B0519	BUSH CAT 2-3	1
22	B163.604.13	ELBOW 1/2" C/W HEX NUT 1/2"	1
23	B165.1501.5	BALL VALVE 1/2" X 1/2" RH	1
24	G8161000	LID/RING KIT 455MM	1
25	HP-121	PUMP MOUNT BRKT 620 FAN AR503	1
26	KH-5026	FAN ASSY 815 GALV NO CLUTCH	1

NO.	PART NUMBER	DESCRIPTION	QTY.
27	LP-121	CONTROLLER BRACKET LINKAGE	1
28	LP060	FRAME 600LT AGRIPAK FARMATE	1
29	LP060-1	FLUSH TANK BRACKET	1
30	LP060-2-2A	FAN BOLTING ANGLE	8
31	LP060-5	FOOT EXTENSION	2
32	LP060-7-2	BOOM MOUNT 600LT	4
33	P600-15L	TANK HAND WASH TO SUIT 600/800LT	1
34	P600-90L	90LT FLUSH TANK TO SUIT 600/800LT	1
35	P600L	600LT LINKAGE CHEMICAL TANK	1
36	XBMBB32	U BOLT 32MM	2
37	M12X35	M12 X 35 SET SCREW HT ZP	12
38	M12FWASHER	M12 FLAT WASHER ZP	38
39	M12NNUT	M12 NYLOC NUT HT ZP	23
40	M12X40	M12 X 40 HEX HEAD SET SCREW HT ZP	3
41	M10X30	M10 X 30 SET SCREW HT ZP	6
42	M10NNUT	M10 NYLOC NUT HT ZP	10
43	M10FWASHER	M10 FLAT WASHER ZP	16
44	M8FWASHER	M8 FLAT WASHER ZP	10
45	M8NNUT	M8 NYLOC NUT HT ZP	2
46	M8SWASHER	M8 SPRING WASHER ZP	6
47	M8X20	M8 X 20 SET SCREW HT ZP	3
48	M8X25	M8 X 25 SET SCREW HT ZP	2
49	M8X40BOLT	M8 X 40 HEX HEAD BOLT HT ZP	3

Please contact Technical support for further details

## **CROPLANDS**

### **AUSTRALIA**

Croplands Equipment Pty Ltd  
ACN 006 450 184

PO Box 2441  
Dry Creek  
50 Cavan Road  
Dry Creek SA 5094  
Australia

Freecall: 1800 999 162  
Freefax: 1800 623 778  
Email: [sales@croplands.com.au](mailto:sales@croplands.com.au)  
Website: [www.croplands.com.au](http://www.croplands.com.au)

### **NEW ZEALAND**

Croplands Equipment Ltd  
PO Box 2004,  
Stortford Bridge, Hastings 4120

Location:  
1422 Omaha Road,  
Hastings 4120  
New Zealand

Freecall: 0800 106 898  
Freefax: 0800 117 711  
Email: [sales@croplands.co.nz](mailto:sales@croplands.co.nz)  
Website: [www.croplands.co.nz](http://www.croplands.co.nz)

Your nearest Croplands Dealer  
can be found in the dealer section  
on the Croplands website