

PRODUCT INFO, HORT 102

QM-420 SPEED SENSOR INSTALLATION

Applicable to accessing / reworking / fitting the speed sensor on all QM-420 fans (+QM-380)

Fitting or replacing the rpm sensor (UP-402) to the Quantum Mist 420 drive body can be very challenging, especially whilst on the sprayer.

There is an easy way, but first you need the correct tools.



- 1) The correct tap to clean out the thread. It's an unusual size, M12 x 1.0

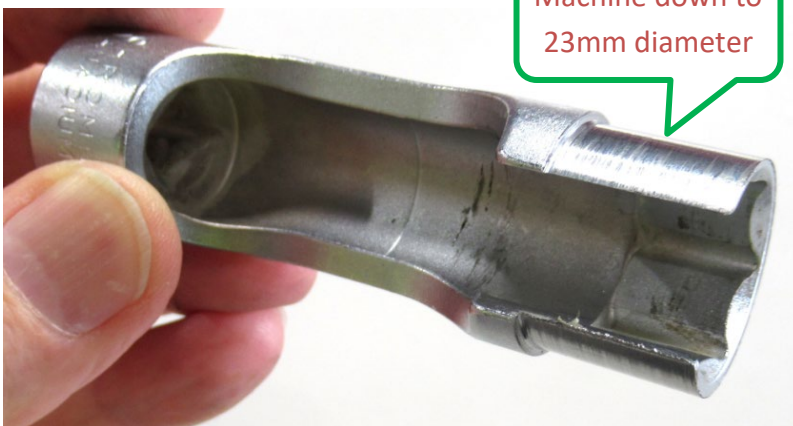

- 2) Modify a 17mm Flare Nut Socket to suit the purpose (we have used a T&E Tools J4290-5) by machining the nut end down to 23mm diameter.

Access to the sensor is via ...

(a) remove the rear guard (4 screws) and (b) remove the rear cover (4 screws). If already on the sprayer, they can be moved out of the way. The fans are always installed with the sensor facing downwards.

Remove the existing brass socket or old sensor. If any thread sealant has been used, the thread will need to be cleaned out using the tap. Be careful to not push swarf inside the drive body. The thread must be in good order to enable the sensor to be installed properly.

Check for the correct depth.



CROPLANDS

Finding the correct depth and position of the “pickup” (circled in red) of the drive coupling is critical.

It's best to find the pickup position before installing the sensor using a soft round object (dowel, pencil etc) and be aware of this position as the sensor is being screwed (by hand) into the drive body.

Correct positioning of the sensor is approximately 2 turns away from the pickup. Too far away and the sensor won't work – too close and the screw head will damage the sensor.

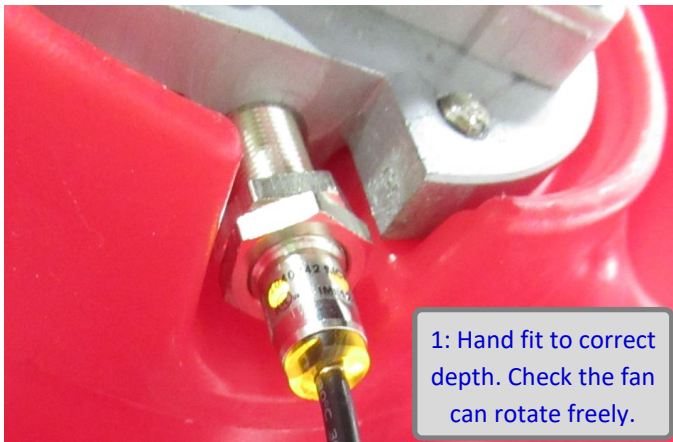
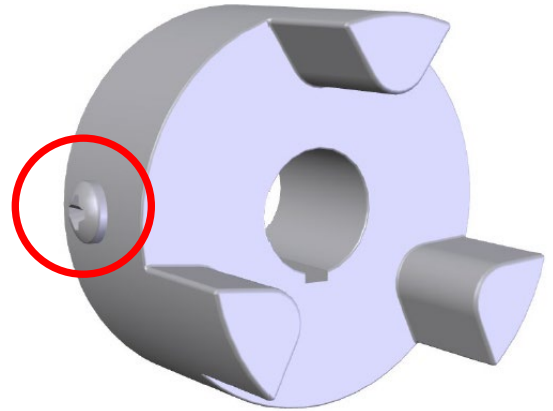

1: Hand fit to correct depth. Check the fan can rotate freely.



2: Screw first nut into place (2nd nut loose).



3: Tighten first nut (2nd nut loose).



4: Tighten 2nd (locking) nut.



5: Reinstall centre cap and rear cover.